

# FEATURES

## OPTICAL SYSTEM

- Self-flanged, semi-specular or matte-diffuse reflector.
- Clear tempered lens standard.

## HOUSING

- Heavy gauge, aluminum housing with no visible seam. Matte white textured polyester powder paint finish standard.
- Top reveal for floating luminaire appearance. Provided with safety chain between reveal and housing on ceiling and pendant units for hands free wiring connections.

## MOUNTING

- Ceiling mount must be anchored to structural support.
- Wall mount must be anchored to structural support. See bracket dimensions to determine size and construction required.
- Pendant mount entry provided for 3/8" National Pipe Thread stem. Additional pendant options available (see accessories). Wires supplied by others.

## ELECTRICAL SYSTEM

- Mogul or medium-base porcelain socket with nickel-plated screw shell.
- Removable, pre-wired power module with high power factor, pulse start, core-and-coil ballast, integral fusing and quick disconnect plug.

## LISTING

- Fixtures are UL Listed for damp locations. Listed and labeled to comply with Canadian Standards.



Type Catalog number

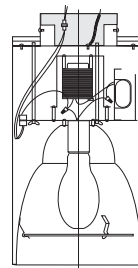
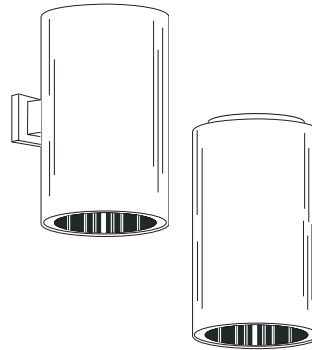

Aperture: 12 (30.5)  
 Housing Diameter: 13-1/8 (33.3)  
 Housing Height: 24-1/2 (62.2)

All dimensions are inches (centimeters)

## H.I.D. Surface Downlights

# 13" CH

## Cylinder

Metal Halide or High Pressure Sodium Lamp

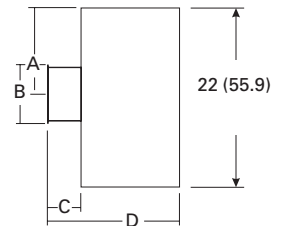

A = 7-1/2 (19.1)  
 B = 6-7/8 (17.5)  
 C = 4-7/8 (12.4)  
 D = 18 (45.7)

Wall Mount Dimensions

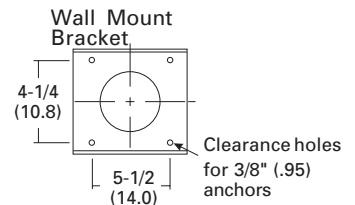

# ORDERING INFORMATION

Example: **CH13 100M 12AR 120 FCM DWHG**

Choose the boldface catalog nomenclature that best suits your needs and write it on the appropriate line.

| CH13   |                                                 | Aperture/Trim color |  | Finish                | Voltage    |                                     | Mounting                                      |  | Options |  |
|--------|-------------------------------------------------|---------------------|--|-----------------------|------------|-------------------------------------|-----------------------------------------------|--|---------|--|
| Series | Wattage/lamp <sup>1,2</sup>                     |                     |  |                       | Finish     | MVOLT <sup>4</sup>                  |                                               |  |         |  |
| CH13   | <b>Metal Halide</b>                             | <b>12AR</b> Clear   |  | (blank) Semi-specular | <b>120</b> | <b>FCM</b> Ceiling mount            | <b>SF<sup>5</sup></b> Single fuse             |  |         |  |
|        | <b>70M</b> MED                                  | <b>12PR</b> Pewter  |  | LD Matte-diffuse      | <b>208</b> | <b>WM</b> Wall mount                | <b>QRS<sup>6</sup></b> Quartz restrike system |  |         |  |
|        | <b>100M</b> MED                                 | <b>12WTR</b> Wheat  |  |                       | <b>240</b> | <b>PM</b> Pendant 3/8" thread mount | <b>QRSTD<sup>6</sup></b> QRS with time delay  |  |         |  |
|        | <b>175M</b> MOG                                 |                     |  |                       | <b>277</b> |                                     | <b>EC<sup>7</sup></b> Emergency circuit       |  |         |  |
|        | <b>250M</b> MOG                                 |                     |  |                       | <b>347</b> |                                     | <b>WLP</b> Lamp (shipped separately)          |  |         |  |
|        | <b>High Pressure Sodium</b>                     |                     |  |                       |            |                                     |                                               |  |         |  |
|        | <b>70S</b> MOG                                  |                     |  |                       |            |                                     |                                               |  |         |  |
|        | <b>100S</b> MOG                                 |                     |  |                       |            |                                     |                                               |  |         |  |
|        | <b>150S</b> MOG                                 |                     |  |                       |            |                                     |                                               |  |         |  |
|        | <b>Color-Corrected Metal Halide<sup>3</sup></b> |                     |  |                       |            |                                     |                                               |  |         |  |
|        | <b>50MHC</b> MED                                |                     |  |                       |            |                                     |                                               |  |         |  |
|        | <b>70MHC</b> MED                                |                     |  |                       |            |                                     |                                               |  |         |  |
|        | <b>100MHC</b> MED                               |                     |  |                       |            |                                     |                                               |  |         |  |

### NOTES

- 1 Recommended for use with coated lamps.
- 2 Tempered safety lens provided. If less glass is desired, must specify protected lamp (i.e. 100MPC, 175MP).
- 3 Ceramic ARC tube consistent-color lamp. Phillips Mastercolor or GE Constant Color.
- 4 Only available with 70W and 100W metal halide.
- 5 Must specify 120 or 277V.
- 6 Not available with EC.
- 7 Not available with QRS or QRSTD.
- 8 Additional architectural colors available; please see Architectural Colors brochure 794.3.
- 9 Length of stem must be specified (from 6" to 240" in even increments). Ex. CYS06 DWHG. Ceiling attachment for interior use. Consult factory for exterior use. Wires supplied by others.



GOTHAM ARCHITECTURAL DOWNLIGHTING  
 1400 Lester Road Conyers Georgia 30012  
 P 800 315 4982 F 770 860 3129  
 www.gothamlighting.com

# 13" CH Open Reflector Cylinder

| Distribution curve                                                                       | Distribution data         | Output data   | Coefficient of utilization | Single luminaire data 30" above floor |                 |                |                 |                       |                         |    |
|------------------------------------------------------------------------------------------|---------------------------|---------------|----------------------------|---------------------------------------|-----------------|----------------|-----------------|-----------------------|-------------------------|----|
| <b>CH13 175M AR, 175W M175/C lamp, 1.0 s/mh, 14000 rated lumens, Test No. 2188090905</b> |                           |               |                            |                                       |                 |                |                 |                       |                         |    |
|                                                                                          | From 0°                   | cp. Lumens    | Zone Lumens %lamp          | ρ f<br>ρ c<br>ρ w                     | 80%<br>50% 30%  | 20%<br>50% 30% | 30%<br>50% 30%  | 50%<br>beam angle 54° | 10%<br>beam angle 83.2° |    |
|                                                                                          | 0°                        | 8411          | 0°-30° 5899 42.1           | 1                                     | 74              | 72             | 70              | 69                    | 67                      | 66 |
|                                                                                          | 5°                        | 8517 807      | 0°-40° 8236 58.8           | 2                                     | 69              | 67             | 66              | 64                    | 64                      | 63 |
|                                                                                          | 15°                       | 7670 2178     | 0°-60° 9245 66.0           | 3                                     | 65              | 62             | 63              | 60                    | 61                      | 59 |
|                                                                                          | 25°                       | 6425 2914     | 0°-90° 9245 66.0           | 4                                     | 62              | 58             | 59              | 57                    | 58                      | 56 |
|                                                                                          | 35°                       | 3709 2337     | 90°-180° 0 0.0             | 5                                     | 58              | 54             | 56              | 53                    | 55                      | 53 |
|                                                                                          | 45°                       | 1064 906      | 0°-180° 9245 66.0*         | 6                                     | 55              | 51             | 53              | 50                    | 52                      | 50 |
|                                                                                          | 55°                       | 33 104        | *Efficiency                | 7                                     | 48              | 45             | 47              | 44                    | 47                      | 44 |
|                                                                                          | 65°                       | 0 0           |                            | 8                                     | 48              | 45             | 47              | 44                    | 47                      | 44 |
|                                                                                          | 75°                       | 0 0           |                            | 9                                     | 45              | 42             | 44              | 41                    | 44                      | 41 |
|                                                                                          | 85°                       | 0 0           |                            | 10                                    | 43              | 39             | 42              | 38                    | 41                      | 38 |
| 90°                                                                                      | 0 0                       |               |                            |                                       |                 |                |                 |                       |                         |    |
| Mount height                                                                             | Initial fc at beam center | Beam diameter | fc at beam edge            | Beam diameter                         | fc at beam edge | Beam diameter  | fc at beam edge | Beam diameter         | fc at beam edge         |    |
| 10'                                                                                      | 149.5                     | 7.7'          | 74.8                       | 13.0'                                 | 15.0            |                |                 |                       |                         |    |
| 12'                                                                                      | 93.2                      | 9.8'          | 46.6                       | 16.4'                                 | 9.3             |                |                 |                       |                         |    |
| 14'                                                                                      | 63.6                      | 11.9'         | 31.8                       | 19.9'                                 | 6.4             |                |                 |                       |                         |    |
| 16'                                                                                      | 46.2                      | 13.9'         | 23.1                       | 23.4'                                 | 4.6             |                |                 |                       |                         |    |
| 18'                                                                                      | 35.0                      | 16.0'         | 17.5                       | 26.8'                                 | 3.5             |                |                 |                       |                         |    |

| Distribution curve                                                                  | Distribution data         | Output data   | Coefficient of utilization | Single luminaire data 30" above floor |                 |                |                 |                         |                         |    |
|-------------------------------------------------------------------------------------|---------------------------|---------------|----------------------------|---------------------------------------|-----------------|----------------|-----------------|-------------------------|-------------------------|----|
| <b>CH13 250M AR, 250W M250/C lamp, 1.3 s/mh, 20500 rated lumens, Test No. 42883</b> |                           |               |                            |                                       |                 |                |                 |                         |                         |    |
|                                                                                     | From 0°                   | cp. Lumens    | Zone Lumens %lamp          | ρ f<br>ρ c<br>ρ w                     | 80%<br>50% 30%  | 20%<br>50% 30% | 30%<br>50% 30%  | 50%<br>beam angle 65.6° | 10%<br>beam angle 91.2° |    |
|                                                                                     | 0°                        | 7451          | 0°-30° 7026 34.3           | 1                                     | 71              | 70             | 67              | 66                      | 65                      | 64 |
|                                                                                     | 5°                        | 7582 720      | 0°-40° 10654 52.0          | 2                                     | 66              | 64             | 63              | 61                      | 61                      | 60 |
|                                                                                     | 15°                       | 8275 2342     | 0°-60° 13098 63.9          | 3                                     | 62              | 58             | 59              | 57                      | 58                      | 56 |
|                                                                                     | 25°                       | 8562 3964     | 0°-90° 13250 64.6          | 4                                     | 58              | 54             | 55              | 53                      | 54                      | 52 |
|                                                                                     | 35°                       | 5576 3628     | 90°-180° 0 0.0             | 5                                     | 54              | 50             | 52              | 49                      | 51                      | 48 |
|                                                                                     | 45°                       | 2211 1711     | 0°-180° 13250 64.6*        | 6                                     | 50              | 46             | 48              | 45                      | 47                      | 44 |
|                                                                                     | 55°                       | 817 733       | *Efficiency                | 7                                     | 46              | 42             | 45              | 41                      | 44                      | 41 |
|                                                                                     | 65°                       | 87 86         |                            | 8                                     | 43              | 39             | 42              | 38                      | 41                      | 38 |
|                                                                                     | 75°                       | 35 37         |                            | 9                                     | 40              | 36             | 39              | 35                      | 38                      | 35 |
|                                                                                     | 85°                       | 27 29         |                            | 10                                    | 37              | 33             | 36              | 32                      | 35                      | 32 |
| 90°                                                                                 | 0 0                       |               |                            |                                       |                 |                |                 |                         |                         |    |
| Mount height                                                                        | Initial fc at beam center | Beam diameter | fc at beam edge            | Beam diameter                         | fc at beam edge | Beam diameter  | fc at beam edge | Beam diameter           | fc at beam edge         |    |
| 8'                                                                                  | 246.3                     | 7.1'          | 123.2                      | 11.2'                                 | 24.6            |                |                 |                         |                         |    |
| 10'                                                                                 | 132.5                     | 9.7'          | 66.2                       | 15.3'                                 | 13.2            |                |                 |                         |                         |    |
| 12'                                                                                 | 82.6                      | 12.2'         | 41.3                       | 19.4'                                 | 8.3             |                |                 |                         |                         |    |
| 14'                                                                                 | 56.3                      | 14.8'         | 28.2                       | 23.5'                                 | 5.6             |                |                 |                         |                         |    |
| 16'                                                                                 | 40.9                      | 17.4'         | 20.4                       | 27.6'                                 | 4.1             |                |                 |                         |                         |    |

**NOTES:**

- For electrical characteristics, refer to Technical Bulletins tab.
- Tested to current IES and NEMA standards under stabilized laboratory conditions. Various operating factors can cause differences between laboratory data and actual field measurements. Dimensions and specifications are based on the most current available data and are subject to change without notice.

**SHID-170**