

FIXTURE SPECIFICATIONS

INTENDED USE

The specification grade **Morgan Architectural LED Track Lighting Spot Light Wall Wash Fixture** delivers direct wall wash ceiling track lighting to commercial, hospitality and residential interior track lighting applications. Our modern LED track lighting designs offer excellent illumination, exceptional performance and versatility in offices, classrooms, conference rooms, museums, retail outlets, hotels, restaurants, and more.

PRODUCT FAMILY ACCESSORIES

- 13002-1** | 2 FT Track Channel
- 13004-1** | 4FT Track Channel
- 13941-1** | Live End Feed
- 13991-1** | Limiter Live End Feed
- 13927-1** | T-Bar Live End Feed
- 13943-1** | L-Connector
- 13946-1** | X-Connector
- 13949-1** | Mini Connector
- 13980-1** | Conduit Connector
- 13929-1** | Floating Canopy Connector

FEATURES

Construction: Fully Adjustable (358/90 °) Solid Steel Mounting Yoke Full Lateral and Vertical Aiming Integral Aluminum Heat Sink for Maximum Heat Rejection

Connector: For Use with H-Style Single Circuit and 2 Circuit Tracks
3-Wire H-Type Thermoplastic track Connections Standard

Voltage: 120V

Wattage: 16 Watts

Lumens: 1200 Lumens

CRI: 90

Dimming: 3-Wire Electronic Low Voltage (100%-5%)

Life: 50,000 Hours L70

Warranty: 3 Years Free of Defects in Materials and Craftsmanship

Listings: cETL Listed

Lamp Equivalent: 75W MR16, 90W PAR30, PAR38, 100W A19

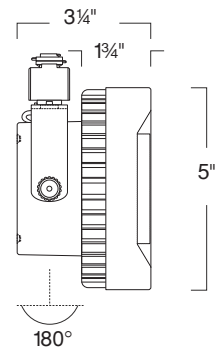
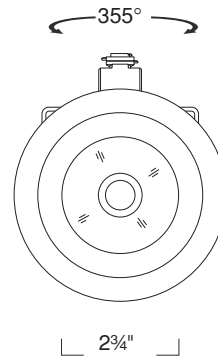

ORDERING INFORMATION Example: (13100-BK-FL45-30K-PL)

Model	Finish	Beam Spread	Color Temp	Options
13100	BK Black WH White SA Satin	FL45 45° Flood WF60 60° Wide Flood	Residential 30K 3000K Commercial 35K 3500K 40K 4000K	LV Glare Control Louver BD Barn Doors

PHOTOMETRY

APPLICATION DATA:

H = Height (Ceiling to ground or wall)
 W = Beam Width
 L = Beam Length
 D = Distance
 FC = Foot Candles

*Fixture calculated at aiming point (90°) to horizontal surface.

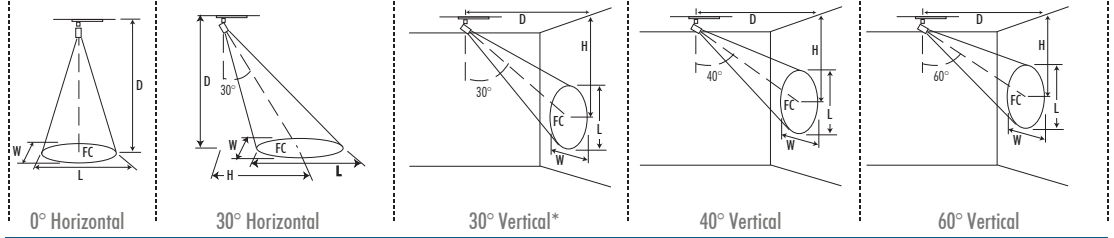

Narrow Flood

System Power :15.4W

Beam Angle 50% :22.2°

Field Angle 10% :48.2°

Color Temperature :2,900K

CRI :90.0

Lumens Delivered :1151Lm

CBCP :4,354cd

0° Horizontal			30° Horizontal			30° Vertical*			40° Vertical			60° Vertical										
H	FC	W/L	D	H	FC	W	L	D	H	FC	W	L	D	H	FC	W	L					
4.0'	324	1.6'	4.0'	2.1'	210	1.7'	1.9'	2.0'	3.5'	158	1.5'	3.3'	2.0'	2.0'	454	1.0'	1.5'	4.0'	2.3'	189	1.8'	2.0'
5.0'	200	2.0'	5.0'	2.7'	130	2.1'	2.5'	3.0'	5.2'	67	2.2'	5.1'	3.0'	3.0'	191	1.6'	2.3'	5.0'	2.9'	120	2.2'	2.6'
6.0'	136	2.4'	6.0'	3.3'	88	2.6'	3.0'	4.0'	6.9'	37	3.0'	6.8'	4.0'	4.0'	105	2.1'	3.1'	6.0'	3.5'	82	2.7'	3.1'
7.0'	98	2.7'	7.0'	3.8'	64	3.0'	3.5'	5.0'	8.7'	23	3.8'	8.6'	5.0'	5.0'	66	2.7'	3.9'	7.0'	4.0'	60	3.1'	3.6'
8.0'	74	3.1'	8.0'	4.6'	44	3.6'	4.2'	6.0'	10.4'	16	4.6'	10.4'	6.0'	6.0'	45	3.2'	4.8'	8.0'	4.6'	46	3.6'	4.2'

CANDELA TABULATION

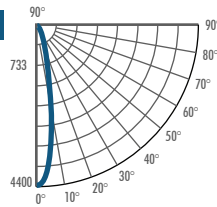

Flood

System Power :15.5W

Beam Angle 50% :40.9°

Field Angle 10% :77.8°

Color Temperature :2,900K

CRI :90.0

Lumens Delivered :1,152Lm

CBCP :1,889cd

3.0'			4.0'			5.0'			6.0'			7.0'										
H	FC	W/L	D	H	FC	W	L	D	H	FC	W	L	D	H	FC	W	L					
3.0'	266	2.2'	3.0'	1.5'	173	2.3'	2.8'	1.5'	2.6'	128	2.0'	7.0'	1.5'	1.5'	370	1.4'	2.3'	2.0'	1.2'	350	1.6'	2.0'
4.0'	141	3.0'	4.0'	2.1'	91	3.2'	3.8'	2.0'	3.5'	68	2.8'	9.5'	2.0'	2.0'	197	1.9'	3.2'	3.0'	1.7'	149	2.5'	3.0'
5.0'	87	3.7'	5.0'	2.7'	56	4.0'	4.9'	2.5'	4.3'	42	3.5'	12.1'	2.5'	2.5'	122	2.5'	4.1'	4.0'	2.3'	82	3.3'	4.0'
6.0'	59	4.5'	6.0'	3.3'	38	4.9'	5.9'	3.0'	5.2'	29	4.3'	14.6'	3.0'	3.0'	83	3.0'	4.9'	5.0'	2.9'	52	4.2'	5.1'
7.0'	43	5.2'	7.0'	4.0'	25	6.0'	7.3'	3.5'	6.1'	21	5.0'	17.2'	3.5'	3.5'	60	3.5'	5.8'	6.0'	3.5'	36	5.0'	6.1'

CANDELA TABULATION

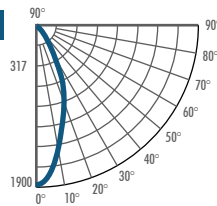

Wide Flood

System Power :15.5W

Beam Angle 50% :60.4°

Field Angle 10% :117.9°

Color Temperature :2,900K

CRI :90.0

Lumens Delivered :1,159Lm

CBCP :919cd

3.0'			4.0'			5.0'			6.0'			7.0'									
H	FC	W/L	D	H	FC	W	L	D	H	FC	W	L	D	H	FC	W	L				
3.0'	129	3.5'	3.0'	1.5'	84	3.6'	4.7'	1.5'	2.6'	62	3.2'	1.5'	1.5'	180	2.2'	4.7'	2.0'	1.2'	170	2.5'	3.3'
4.0'	68	4.7'	4.0'	2.1'	44	4.9'	6.4'	2.0'	3.5'	33	4.3'	2.0'	2.0'	96	3.0'	6.5'	3.0'	1.7'	73	3.9'	5.0'
5.0'	42	5.8'	5.0'	2.7'	27	6.3'	8.2'	2.3'	4.0'	25	5.0'	2.5'	2.5'	59	3.9'	8.2'	4.0'	2.3'	40	5.2'	6.8'
6.0'	29	7.0'	6.0'	3.3'	19	7.6'	9.9'	3.0'	5.2'	14	6.7'	3.0'	3.0'	40	4.7'	10.0'	5.0'	2.9'	25	6.5'	8.5'
7.0'	21	8.1'	7.0'	4.0'	14	9.4'	12.2'	3.5'	6.1'	10	7.8'	3.5'	3.5'	29	5.5'	11.8'	6.0'	3.5'	17	7.9'	10.3'

CANDELA TABULATION

