

# LSM-55WD 5.5W Indoor Warm-DimFlexible LED Strip

JOB NAME: \_\_\_\_\_  
LOCATION: \_\_\_\_\_  
QUOTE/REF#: \_\_\_\_\_

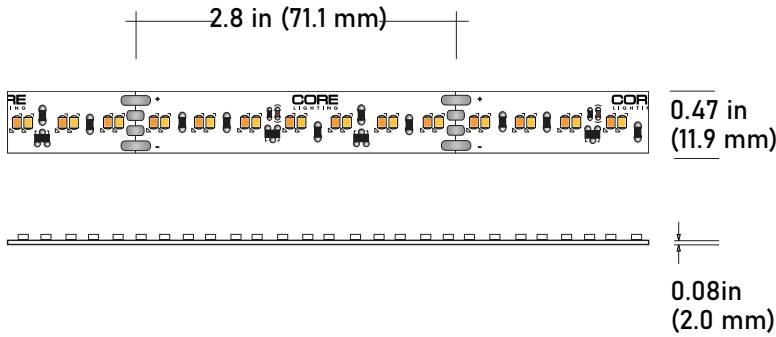

**LSM-55WD** is a new warm-dim LED strip with smart chip technology. Using a standard wall box dimmer, LED light source automatically shifts color temperature from 3000K down to 1800K as it is being dimmed. LSM-55WD provides Warm-Dim technology at a fraction of the price without the need for any special lighting control system.

## SPECIFICATIONS

<b>INPUT VOLTAGE</b>	24V DC
<b>POWER CONSUMPTION</b>	5.5W per foot
<b>LUMEN OUTPUT</b>	348 Lumens per foot
<b>NO. OF LEDs</b>	64 LEDs per foot
<b>BEAM ANGLE</b>	120°
<b>CRI</b>	90+
<b>DIMMING</b>	Standard CL dimmers
<b>MAXIMUM RUN LENGTH</b>	16 Feet
<b>FIELD CUTTABLE</b>	Every 2.8 in
<b>IP RATING</b>	IP45 dry location (indoor)
<b>LUMEN MAINTENANCE</b>	50,000 hrs.
<b>OPERATING TEMPERATURE</b>	-40°F(-40°C)~+140°F(+60°C)
<b>BINNING</b>	1.5 Step Macadam Elipse
<b>CERTIFICATIONS</b>	UL listed
<b>DIMENSIONS</b>	0.47" x 0.08 (width x height)

## FEATURES

- 5.5W per Foot
- 348 Lumens
- 90+ CRI
- Auto warm-dim technology
- Field cuttable
- Ideal for accent and ambient lighting
- Multiple CCT options available
- UL Listed
- Dimmable with CORE dimmable drivers

	COLOR TEMP	CRI	LUMEN/FT
	1800K	90	315
	2700K	90	348
	3000K	90	348



# LSM-55WD 5.5W Indoor Warm-DimFlexible LED Strip

## STANDARD ORDERING CODE

Model	Color Temp	Length	Voltage	Profile
LSM-55WD	<b>18K/27K</b> 1800K / 2700K	<b>16</b> 16.4 Ft.	<b>24</b> 24 Volts	<sup>2</sup> See p3 for options
	<b>18K/30K</b> 1800K / 3000K	<b>100</b> 100 Ft.		
		<b>1XX</b> per Ft.		

### NOTE:

- 1** = Custom length per Ft. cuttable every 2.8"
- 2** = Custom color finishes require powder coating. Allow 7 days lead time.

# LSM-55WD 5.5W Indoor Warm-DimFlexible LED Strip

## COMPATIBLE ALUMINUM PROFILES

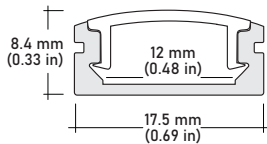

**ALU-SF** Surface  
**LENGTHS** 39<sup>3/8</sup>" | 78<sup>7/8</sup>" | 98"  
**LENS** Clear, Frosted  
**FINISH** Silver | Black

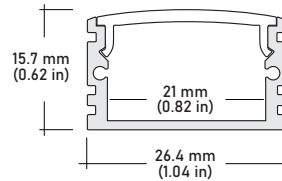

**ALU-DS100** Surface Wide  
**LENGTHS** 39<sup>3/8</sup>" | 78<sup>7/8</sup>" | 96"  
**LENS** Clear, Frosted  
**FINISH** Silver

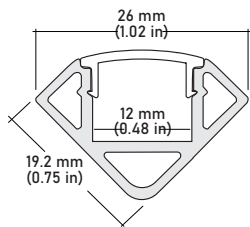

**ALU-CN** Surface, Corner  
**LENGTHS** 39<sup>3/8</sup>" | 78<sup>7/8</sup>" | 96"  
**LENS** Clear, Frosted  
**FINISH** Silver | Black

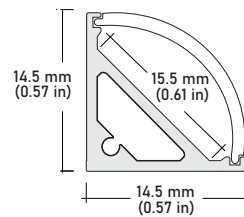

**ALP-50C** Surface, Corner  
**LENGTHS** 49.25" | 98.5"  
**LENS** Frosted  
**FINISH** White | Black | Silver

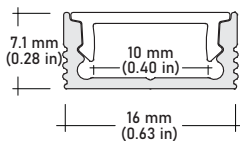

**ALP-20** Surface  
**LENGTHS** 49.25" | 98.5"  
**LENS** Frosted  
**FINISH** White | Black | Silver

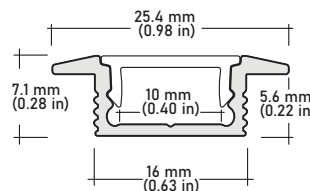

**ALP-20R** Recessed  
**LENGTHS** 49.25" | 98.5"  
**LENS** Frosted  
**FINISH** White | Black | Silver

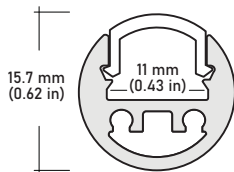

**ALP-35** Surface  
**LENGTHS** 48" | 96"  
**LENS** Frosted  
**FINISH** Silver

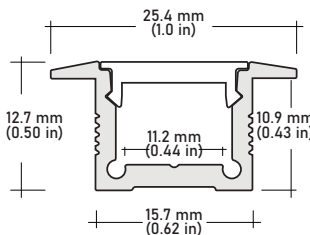

**ALP-60R** Recessed  
**LENGTHS** 49.25" | 98.5"  
**LENS** Frosted  
**FINISH** White | Black | Silver

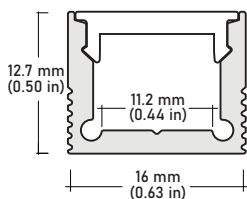

**ALP-60** Surface  
**LENGTHS** 49.25" | 98.5"  
**LENS** Frosted  
**FINISH** White | Black | Silver

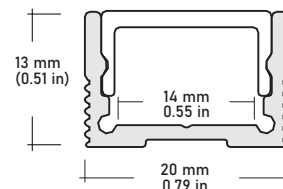

**ALP-70** Surface  
**LENGTHS** 49.25" | 98.5"  
**LENS** Frosted  
**FINISH** White | Black | Silver

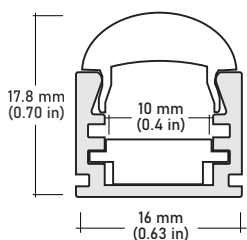

**ALP-65** Surface  
**LENGTHS** 49.25" | 98.5"  
**LENS** Frosted  
**FINISH** Silver  
**OPTICS** 10° | 30° | 60°

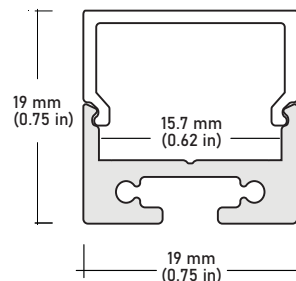

**ALP-70** Surface, Suspended  
**LENGTHS** 49.25" | 98.5"  
**LENS** Frosted  
**FINISH** Silver

## COMPATIBLE TRANSFORMERS

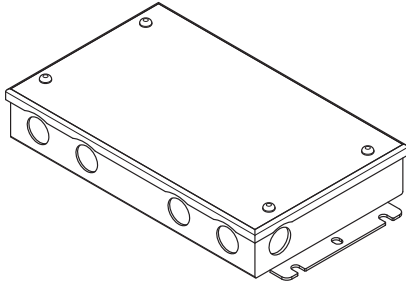

### PSDL SERIES | TRIAC DIMMABLE

<b>PSDL-30W-24V</b>	CLASS 2	6.5" x 3.63" x 1.03"
<b>PSDL-60W-24V</b>	CLASS 2	7.4" x 3.63" x 1.03"
<b>PSDL-96W-24V</b>	CLASS 2	8.67" x 3.67" x 1.62"
<b>PSDL-150W-24V</b>	CLASS 2	8.67" x 3.67" x 1.62"
<b>PSDL-192W-24V</b>	CLASS 2	10.25" x 4.06" x 1.82"
<b>PSDL-200W-24V</b>	CLASS 2	10.25" x 4.06" x 1.82"
<b>PSDL-288W-24V</b>	CLASS 2	10.25" x 4.06" x 1.82"
<b>PSDL-300W-24V</b>	CLASS 2	10.25" x 4.06" x 1.82"

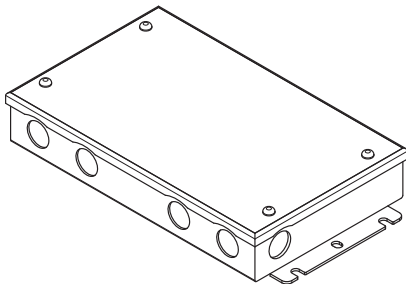

### PSVT SERIES | 0-10V DIMMING WITH JUNCTION BOX

<b>PSVT-60W-24V-UNV-010</b>	CLASS 2	7.4" x 3.72" x 1.57"
<b>PSVT-96W-24V-UNV-010</b>	CLASS 2	8.66" x 3.72" x 1.57"
<b>PSVT-200W-24V-UNV-010</b>	CLASS 2	10.24" x 4.13" x 1.77"
<b>PSVT-288W-24V-UNV-010</b>	CLASS 2	11.85" x 4.25" x 1.81"
<b>PSVT-300W-24V-UNV-010</b>	CLASS 2	10.94" x 4.33" x 1.77"