

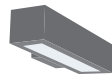

Date:	Approved:
Type:	
Fixture:	
Project:	

FCQSQ605, FCQSQ606

Die-Cast Aluminum Interior / Exterior,
Square Cylinder Wall Mount.



FCQSQ605

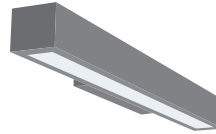

FCQSQ606

ORDERING

EXAMPLE: FCQSQ606-120V-LED-4K-700-BK-DPU

SERIES	VOLTAGE	SOURCE/TEMPERATURE/LAMP	FINISH	ACCESSORIES
FCQSQ605	120V	for FCQSQ605	BK Black	DPUD Distribution Pattern Up/Down
FCQSQ606	277V	LED 3K 700 Lumens min.	BZ Bronze	DPU Distribution Pattern Up Down Pattern is standard
		4K 1000 Lumens min.	CC Custom Color	
	347V △	for FCQSQ606	SL Silver	EC E-Coat
		PL 28T5 54T5 HO	WH White	F Fuse
		LED 3K 2800 Lumens min.		
		4K		

△contact factory

* FCQSQ606 only

SPECIFICATION

MOUNTING

- Mounts directly to standard outlet box. Additional mounting holes allow unit to be attached directly to mounting surface.

CONSTRUCTION

- Marine grade, corrosion resistant, heavy walled, high pressure die-cast aluminum.
- Lens is heat resistant, clear, tempered glass. Vandal resistant.
- Precision spun/formed aluminum, anodized specular clear for maximum reflectance.
- Neoprene continuous closed cell urethane 'O' ring gasket to seal out contaminants.
- Captive and recessed stainless steel, tamper resistant hex socket screws.

LED

- Lumens stated are the minimum lumens delivered out of the luminaire. LED lifetime is greater than or equal to 70,000 hours with the lumen depreciation greater than L70. All of our luminaires are tested to LM 80 with a minimum CRI of 80 and color consistency of step 4 MacAdam Ellipse. Integral power supply standard. Input voltage 120V or 277V. Consult factory for dimming, all RGB color changing and any single color options.

FINISH

- Six stage chemical pre-treatment process that includes iron phosphate, to prepare the substrate for a UV stable, super durable standard polyester powder coat.
- Optional e-coat process is added to the standard finish including zinc phosphate for a 5 year limited warranty.

ELECTRICAL

- Socket PL:** Four pin plug-in type compact fluorescent lamp holder. INC (120V only): R7s double ended T3 base pulse rated 4KV porcelain body. HID: RX7s for 70W base or +4.5 base for 20MH.
- Ballast PL:** Fluorescent high power factor electronic, UL listed ballast standard. HID: Remote electronic ballast standard. Ballast has a manufacturer issued 5 year warranty. Electronic universal voltage 120V or 277V is standard. Please consult factory for other voltage options.

LISTING

- UL & cUL listed for wet locations. IP65 rating.

PHOTOMETRY

DIMENSIONS

FCCSQ605

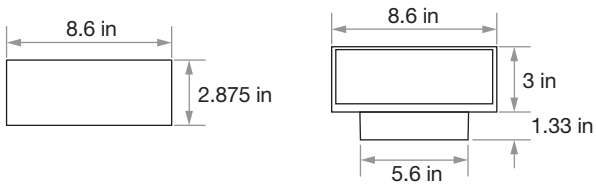

FCCSQ606

