

## HP-6 Direct Starter/Independent Installation Instructions

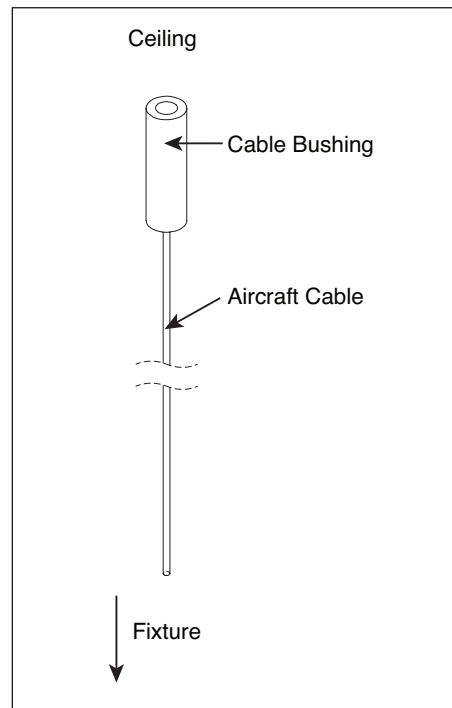

Locate aircraft cables.

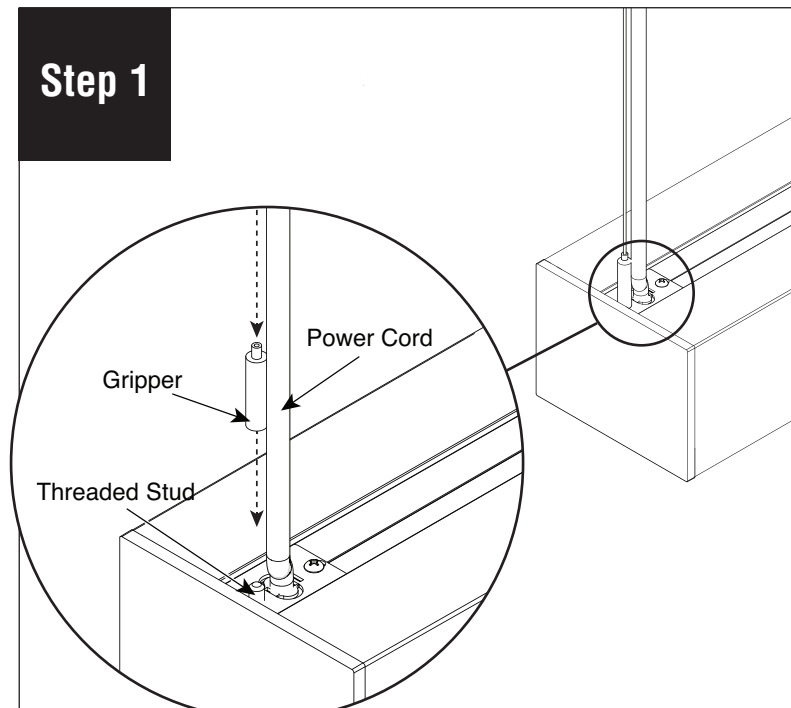

Install grippers onto threaded studs on both ends of the fixture.

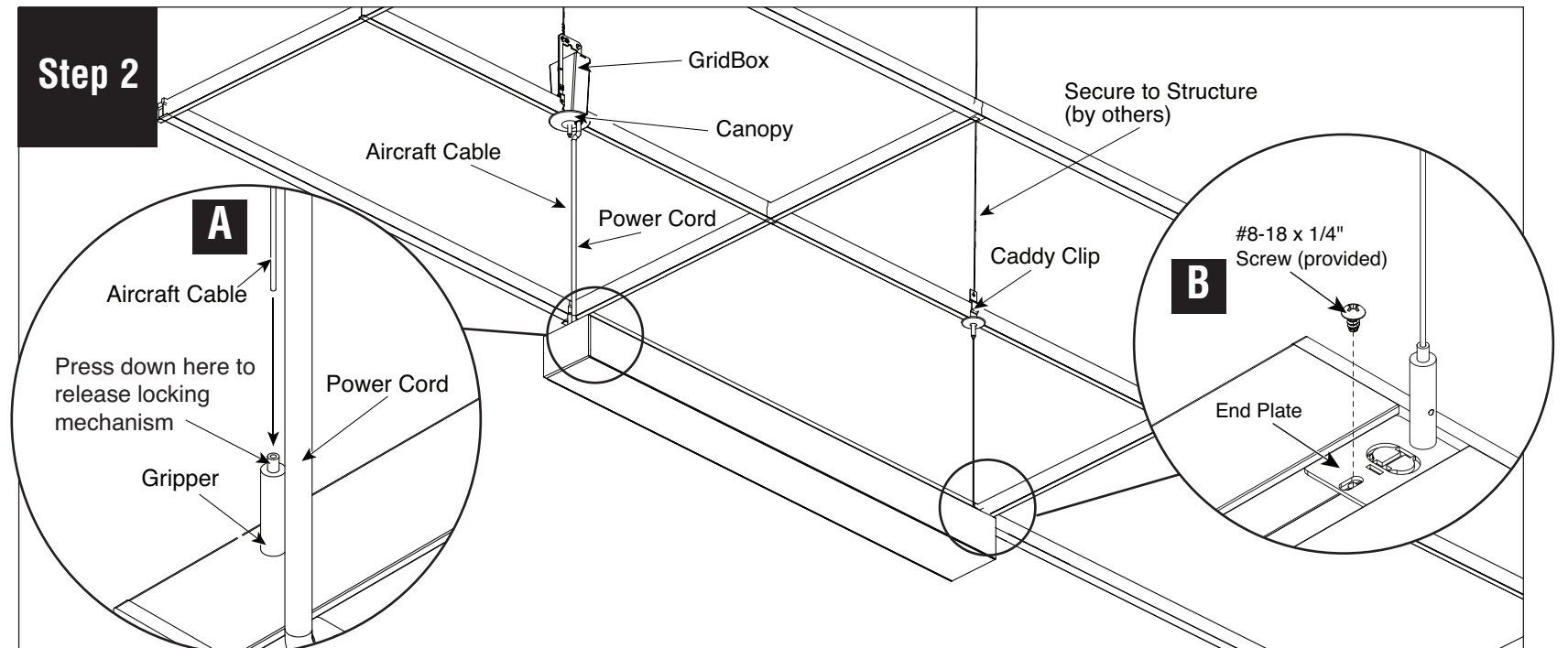

Install GridBox™ and caddy clip onto ceiling grid, then canopies and aircraft cable assemblies. **A.** Align aircraft cables to grippers and insert on both ends of the fixture. Adjust pendant to proper height and level. Press down on top of gripper to release locking mechanism if needed. Secure fixture to structure using tie-wire (supplied by others) according to code. **B.** End plates are adjustable for custom mounting locations. Remove #8-18 x 1/4" screw (provided) from end plate, then slide end plate to desired location and reinstall screw.

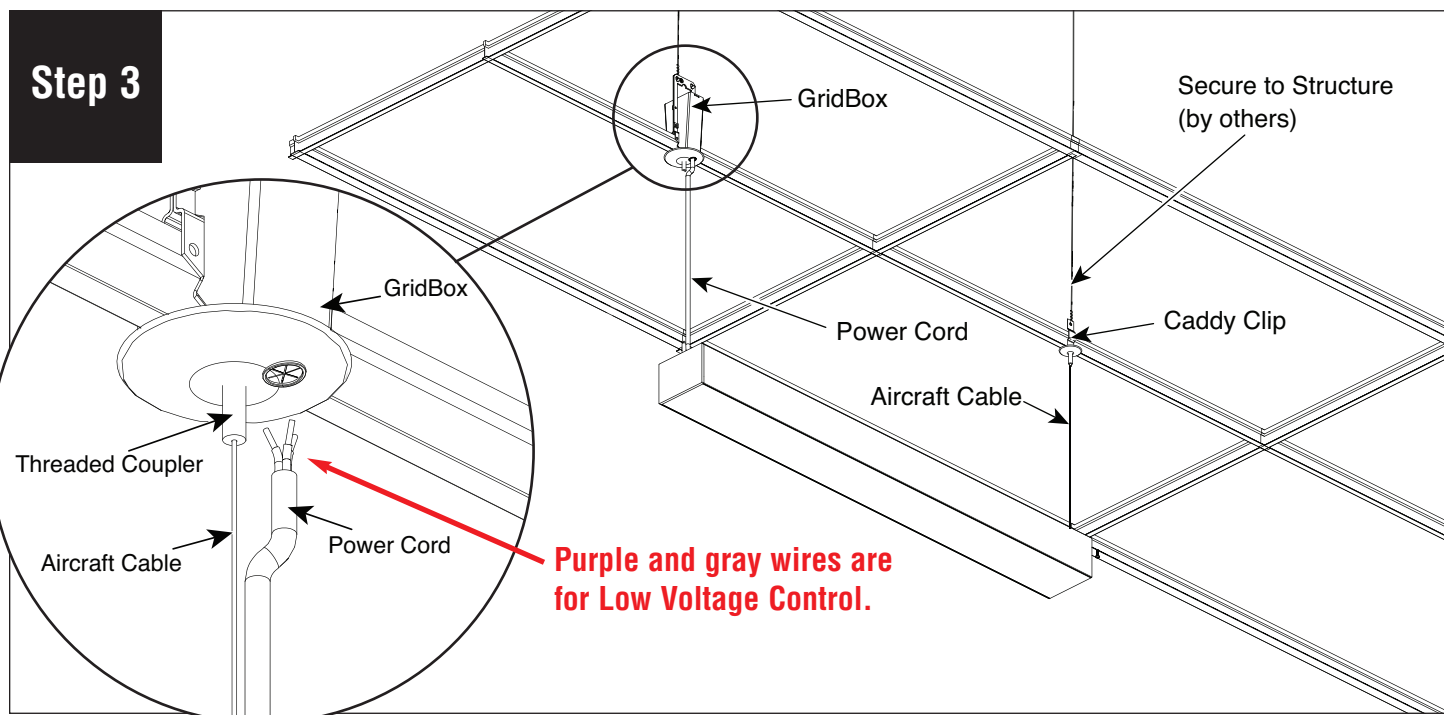

Install power cable through canopy and into GridBox™. Make electrical connections in GridBox.

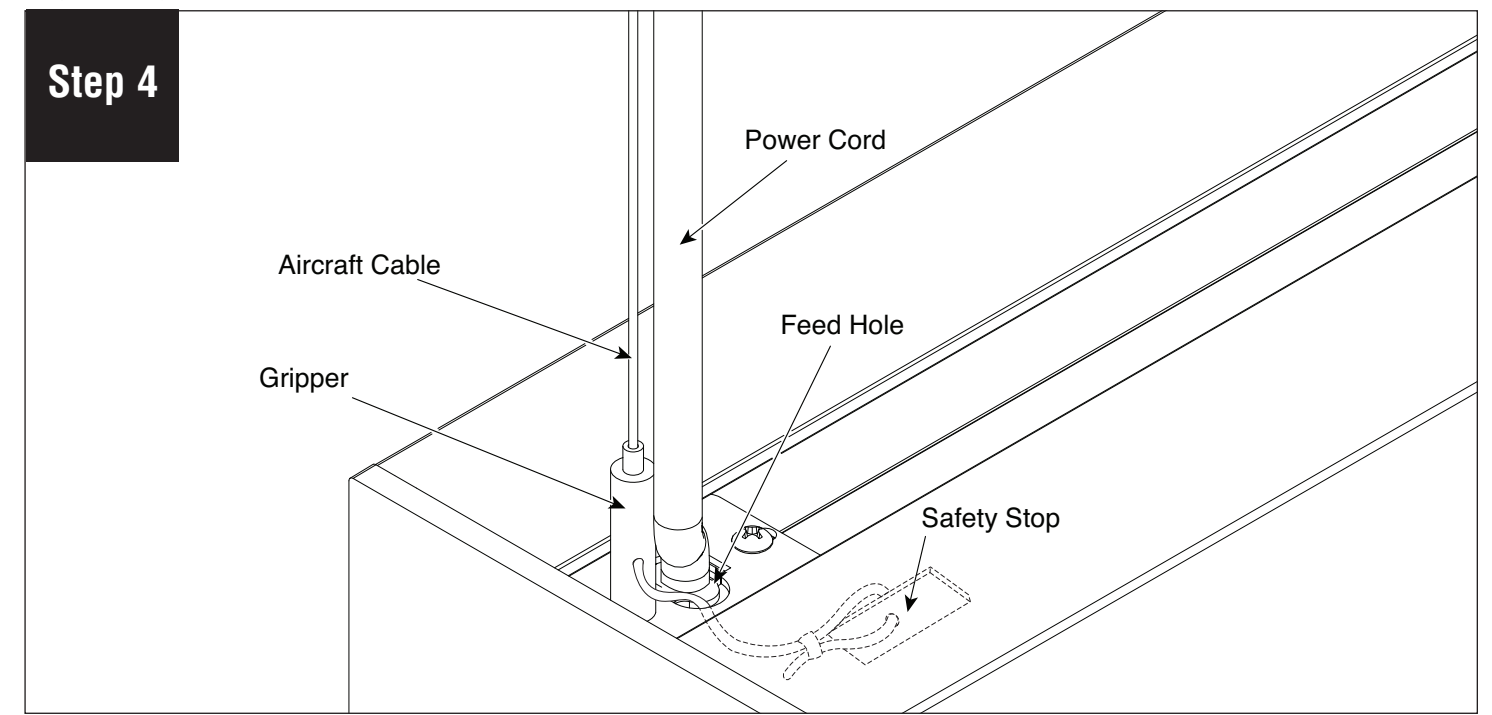

Slide safety stop and safety crimp up to the aircraft cable within 9" of cable gripper. Trim excess cable and insert safety bar assembly through feed hole. Turn power on to fixture.

## HP-6 Direct Joiner Installation Instructions

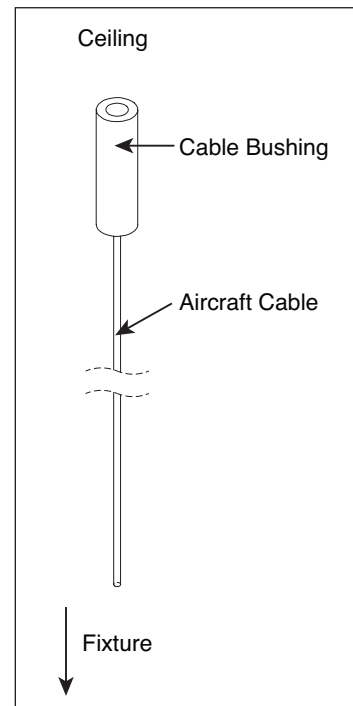

Locate aircraft cables

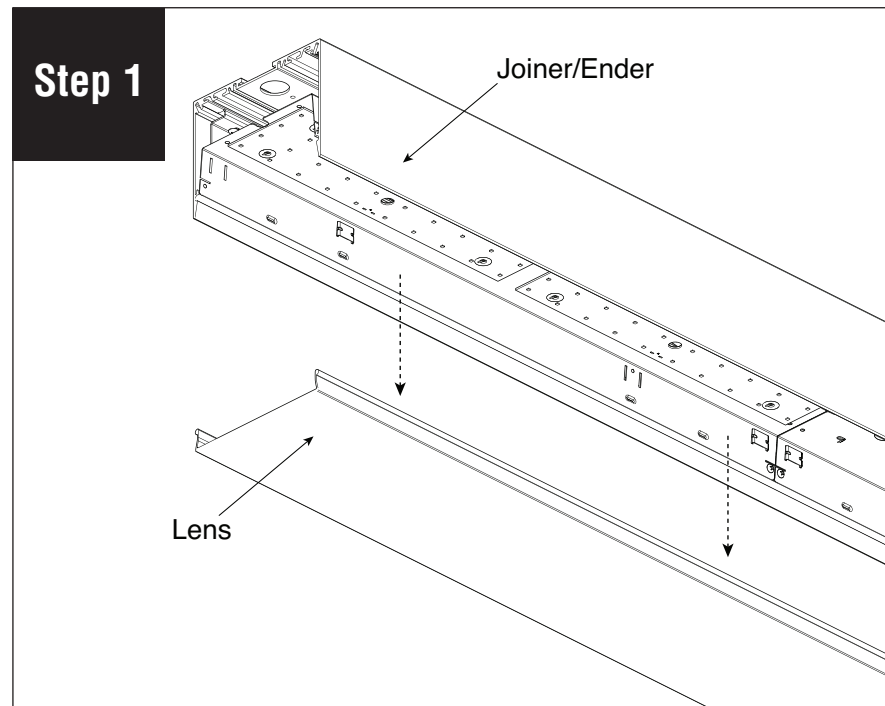

**Step 1**  
Remove lenses and set aside to prevent it from getting dirty or damaged.  
If part of a longer run, lens will be reinstalled back into original fixture section as lengths vary.

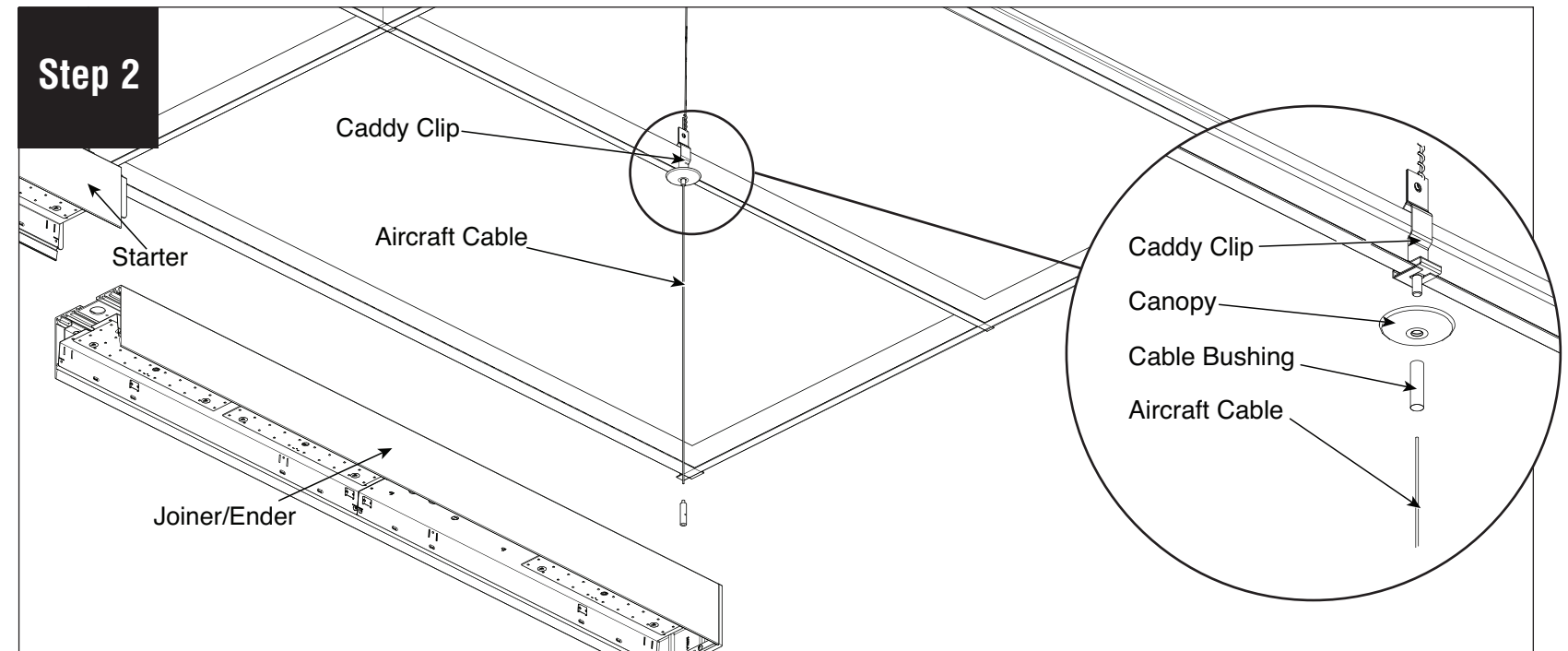

**Step 2**  
Make sure starter or previously installed joiner fixture is LEVEL before attempting to install joiner fixture. Install caddy clip for joiner/ender. Install canopy, cable bushing and aircraft cable into caddy clip.

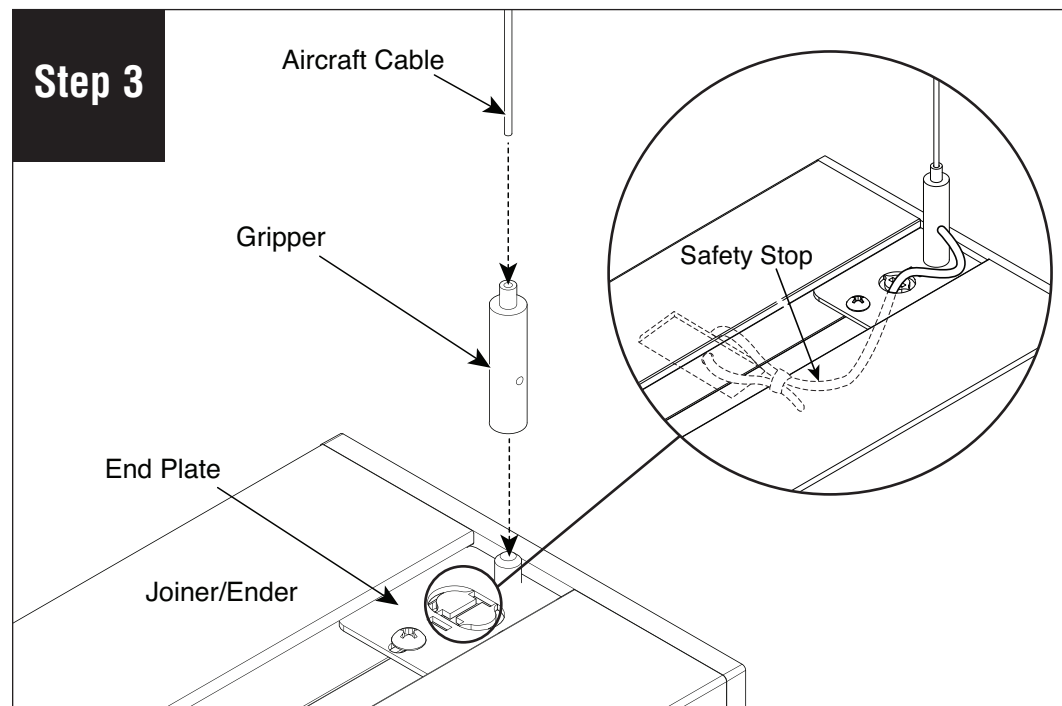

**Step 3**  
Install gripper onto end plate of fixture then install aircraft cable into gripper. Adjust pendant to proper height and level. Slide safety stop and safety crimp up to the aircraft cable within 9" of cable gripper. Trim excess cable and insert safety bar assembly through feed hole.

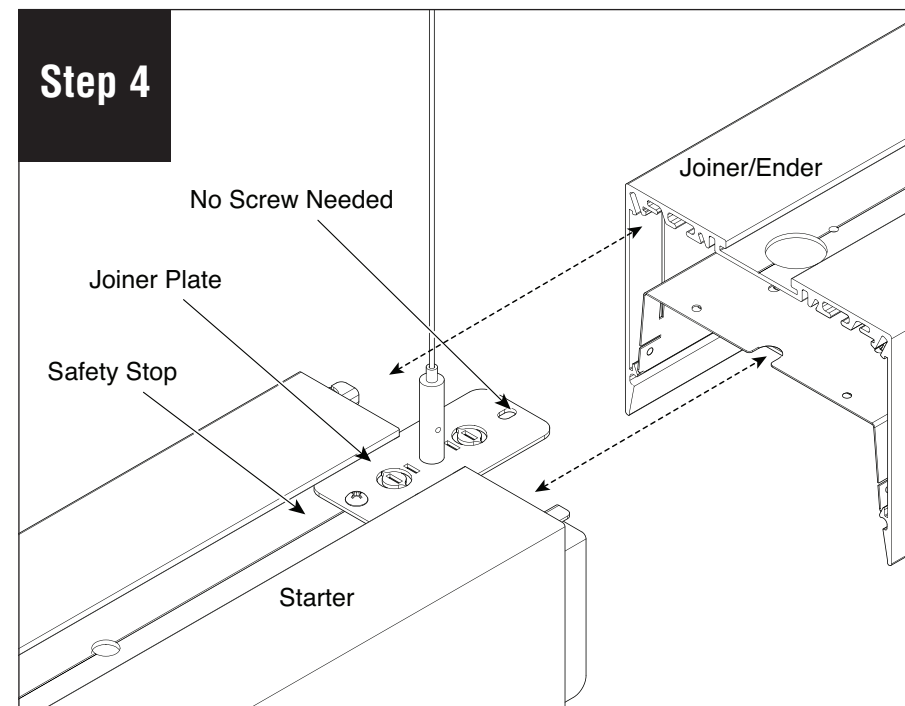

**Step 4**  
Align starter and joiner/ender fixtures and slide fixtures together. Ensure joiner fixture is LEVEL by raising or lowering the opposite end of the joiner fixture.

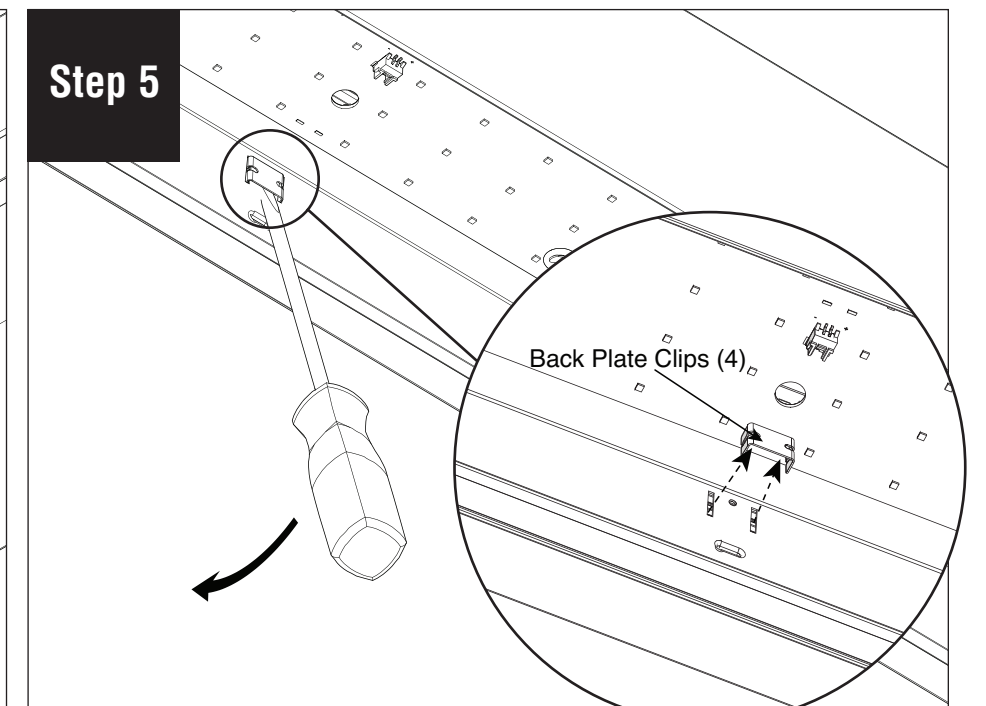

**Step 5**  
Remove back plate clips to release the back plate that is covering where you need access (4). We recommend using a flat head screwdriver to get them loose.  
**CAUTION: Do not lose these pieces.**

## HP-6 Direct Joiner Installation Instructions

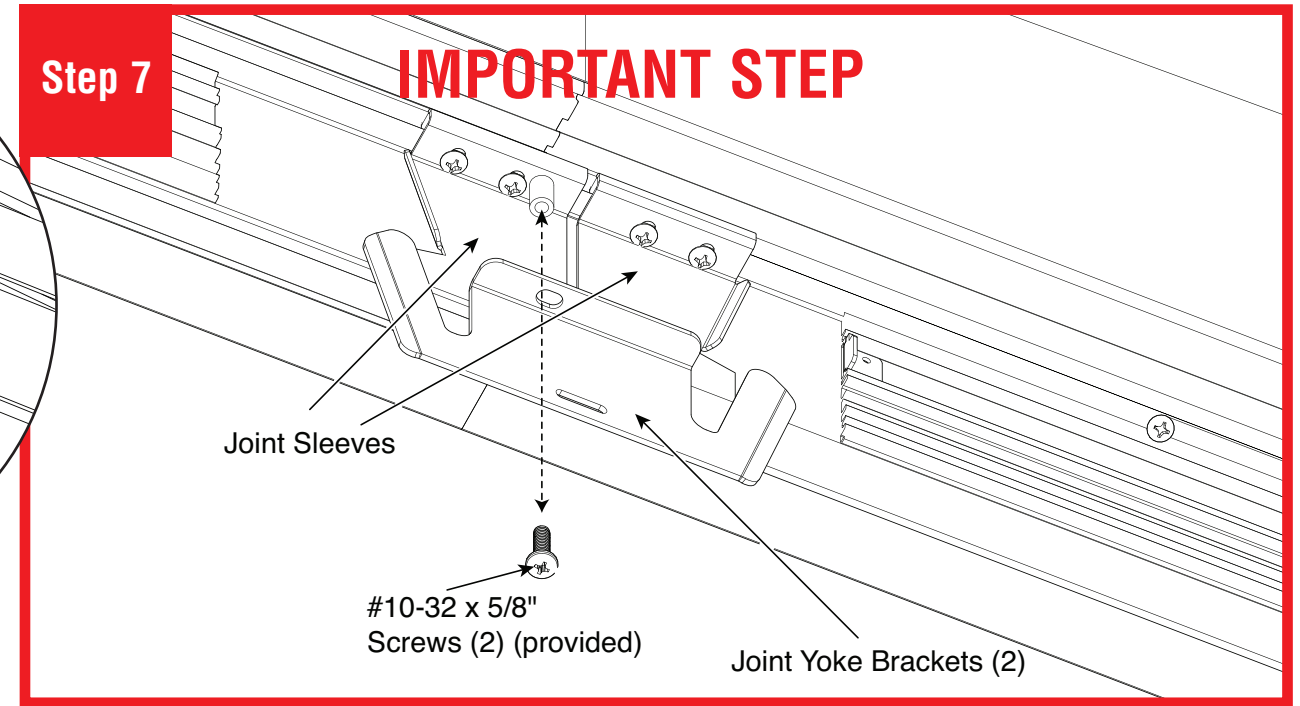
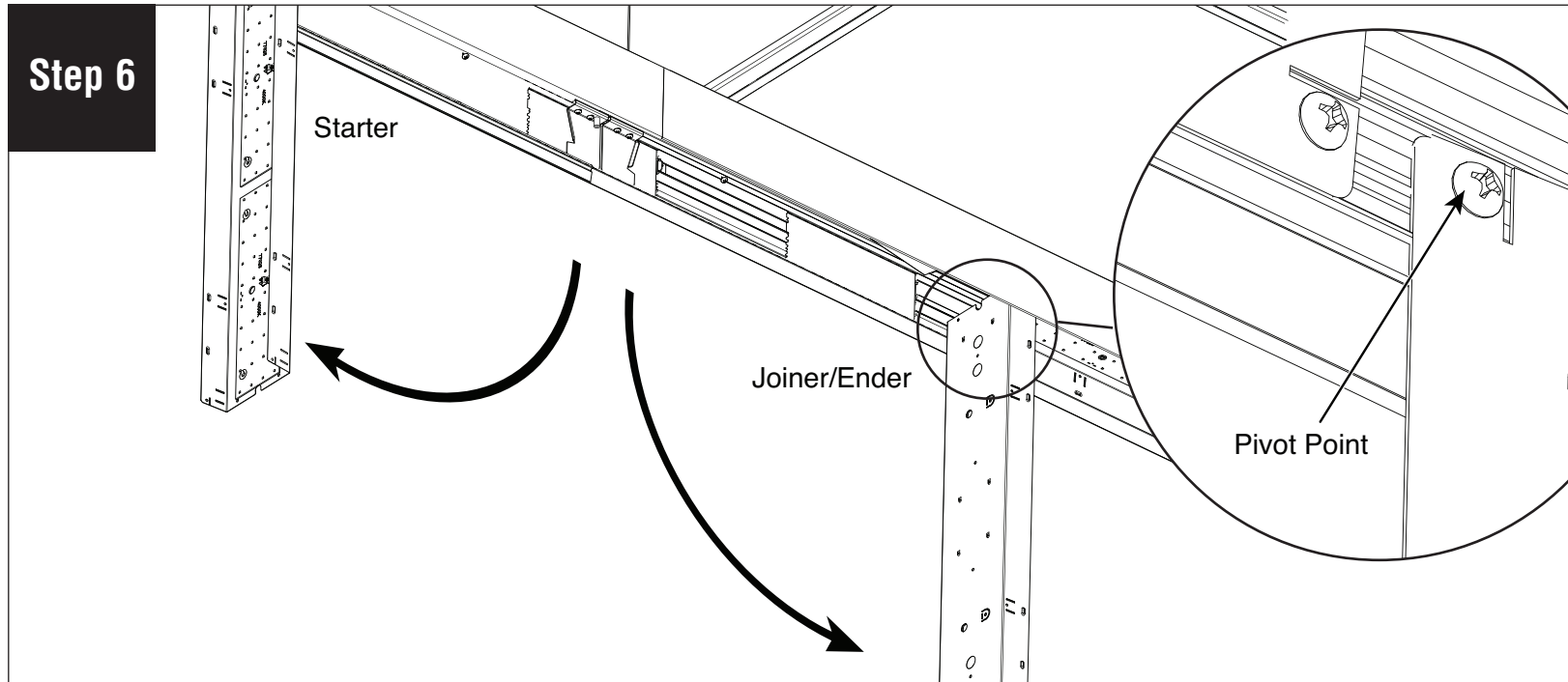

Slowly swing down back plate. CAUTION: Do not twist the back plate when swinging down – it will come out of the support extrusion. Note that the screws shown are the pivot point, and the back plate can be slid a few inches either way for ease of access to the driver space.

**IMPORTANT STEP:** Install 2 yoke brackets onto joint sleeves. Secure with #10-32 x 5/8" screws (provided).

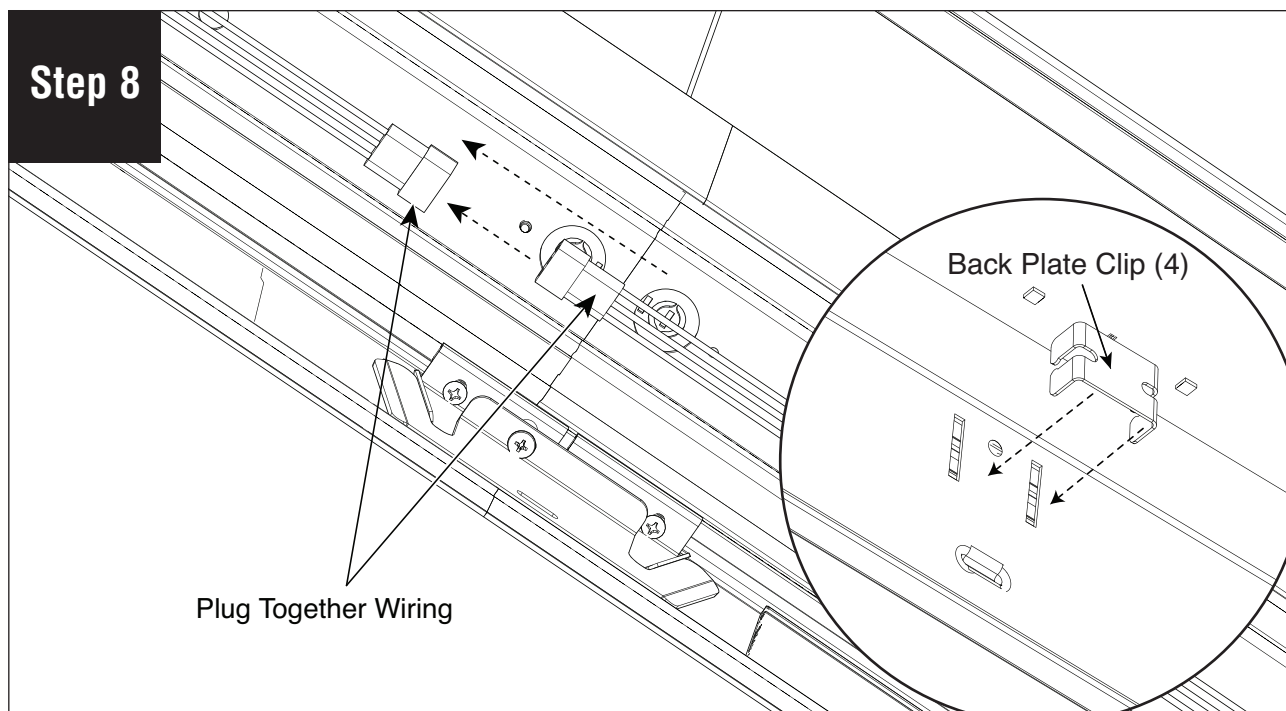

Connect plug together wiring. Re-position the back plates and secure by reinstalling the back plate clips (4).

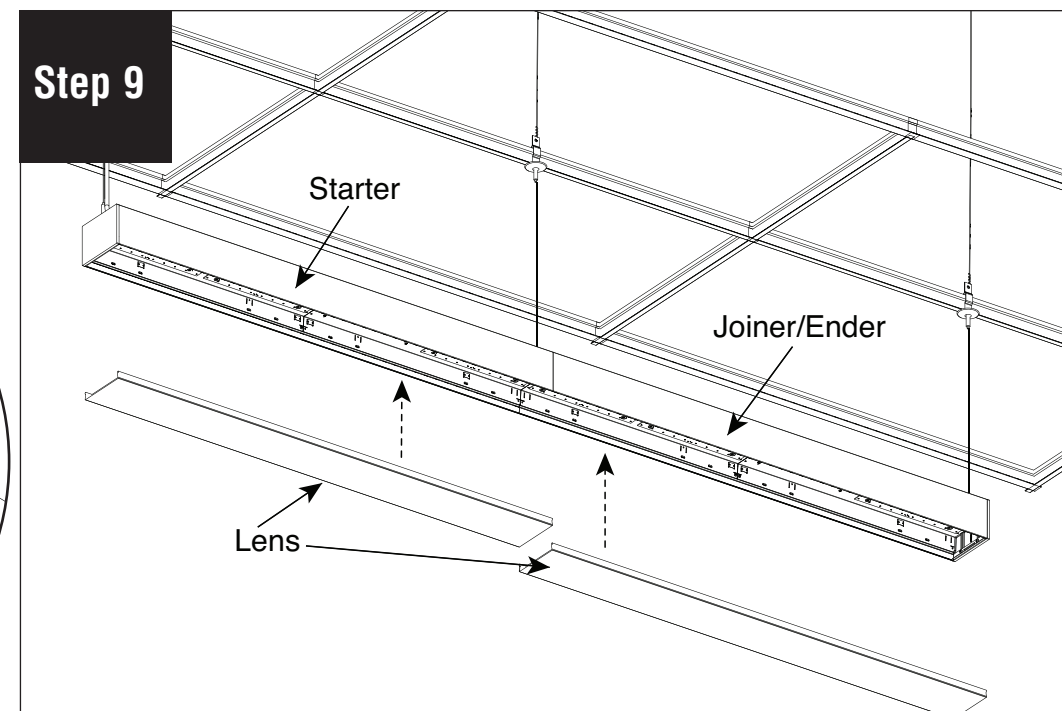

Reinstall lenses and turn power on to fixture. If part of a longer run, reinstall lens back into the original fixture section as lengths vary.