

CATALOG #: _____

TYPE: _____

PROJECT: _____

FEATURES

- Low-profile depth for shallow plenum applications
- Diffuse lens provides smooth illumination for visual comfort
- Air return capability reduces number of unsightly ceiling vents for a cleaner appearance
- Surface mount kit preserves continuity
- Maximize energy savings with efficacies as high as 140 lm/W
- Made Right Here® in the USA

SPECIFICATIONS

- HOUSING/REFLECTOR – Precision die-formed 22-gauge C.R.S.
- SHIELDING – Frosted acrylic.
- FINISH – Highly reflective non-glare matte white polyester powder coat bonded to phosphate-free, multi-stage pretreated metal. All parts painted after fabrication to facilitate installation, increase efficiency, and inhibit corrosion.
- ELECTRICAL – High quality mid-power LED boards. L80 >60,000 hours.
- MOUNTING – Designed for NEMA Type “G” 1” grid ceiling standard. For NEMA Type “NFG” and “SG” 9/16” grid installations, specify EQCLIPS option. Surface mount and drywall kit accessories available, ordered separately.
- LISTINGS –
 - cCSAus certified as luminaire suitable for dry or damp locations.
 - DesignLights Consortium Premium qualified product. Not all versions of this product may be DLC Premium qualified, see the DLC Qualified Products List at www.designlights.org/QPL.
 - City of Chicago Environmental Air approved when specified with CP option.
- WARRANTY – 5-year limited warranty, see hew.com/warranty.

ORDERING EXAMPLE: LT - 24 - L52/835 - AF - OPTIONS - DIM - UNV

ORDERING INFO

SERIES	WIDTH	LENGTH	LUMENS ^[1]	CRI	CCT	SHIELDING
LT Static	1 1' ^[3]	2 2' ^[4]	1x4	8 80	27 2700K	AF Frosted acrylic
LT-AR Air Return ^[2]	2 2'	4 4'	L28 2,800lm	9 90 ^[5]	30 3000K	
			L47 4,700lm		35 3500K	
			L63 6,300lm		40 4000K	
			2x2		50 5000K	
			L27 2,700lm			
			L39 3,900lm			
			L49 4,900lm			
			2x4			
			L40 4,000lm			
			L52 5,200lm			
			L64 6,400lm			
			L82 8,200lm			

OPTIONS ^[6]

- EM/7WRM** Remote mount 7-watt emergency battery ^[8]
- EM/10W** 10-watt emergency battery ^[9]
- EM/12W** 12-watt emergency battery ^[10]
- EQCLIPS** Earthquake clips ^[11]
- OCC_** Integral occupancy sensor and power pack: **OCCLV OSF10-IUW-PP-UNV**
- (L_)** Additional lower lumen packages available. ^[12]
Example: 5,800 lumens = LT-24-L64/840-(L58)
- CP** Chicago Plenum (CCEA)
- LT-14-SMK-W** Surface mount kit, 1'x4', white
- LT-22-SMK-W** Surface mount kit, 2'x2', white
- LT-24-SMK-W** Surface mount kit, 2'x4', white
- DFK-1248W** Drywall kit, 12" x 48", white
- DFK-2424W** Drywall kit, 24" x 24", white
- DFK-2448W** Drywall kit, 24" x 48", white

CONTROL ^[7]

- DIM** Dimming driver
- DRV** Non-dimming driver
- VRF/DSR** Lutron Vive integral fixture control, RF only (DFCSJ-OEM-RF) and sensor-ready driver

VOLTAGE

- 120** 120V
- 277** 277V
- UNV** 120-277V
- 347** 347V ^[13]

QUICKSHIP

1x4	2x2	2x4
LT-14-L47/835-AF-QS-DIM-UNV	LT-22-L39/835-AF-QS-DIM-UNV	LT-24-L40/835-AF-QS-DIM-UNV
LT-14-L47/840-AF-QS-DIM-UNV	LT-22-L39/840-AF-QS-DIM-UNV	LT-24-L40/840-AF-QS-DIM-UNV
		LT-24-L64/835-AF-QS-DIM-UNV
		LT-24-L64/840-AF-QS-DIM-UNV



NOTES

- ¹ Lumens based on 3500 CCT. Actual lumens may vary +/-5%, see page 2 for FIXTURE PERFORMANCE DATA. Additional lumen packages available, see options.
- ² Air return through side slots. Not available with surface mount or CP option.
- ³ 4' length only.
- ⁴ 2' width only.
- ⁵ Extended lead times may apply. Consult factory for availability.
- ⁶ See page 3 for FLEXIBLE WHIP OPTIONS. See page 3 for SURFACE MOUNT KIT DETAILS. See Technical Info for Drywall Kit and Power Entry details.
- ⁷ See page 2 for ADDITIONAL CONTROL OPTIONS.
- ⁸ 120-277V only.
- ⁹ 120-277V only.
- ¹⁰ 120-277V only.
- ¹¹ 4 per fixture. Optional for 1" grid installations. Required for 9/16" grid mounting; LT is compatible with Williams earthquake clips only.
- ¹² Specify in increments of 100 nominal lumens. Option must be specified with next higher lumen package.
- ¹³ Not available with EM batteries.

FIXTURE PERFORMANCE DATA

	LED PACKAGE	DELIVERED LUMENS	WATTAGE	EFFICACY (lm/W)
1x4	L28	2814	21.4	131.6
	L47	4677	33.7	138.7
	L63	6261	48.5	129.1
2x2	L27	2722	21.3	127.8
	L39	3934	33.1	118.7
	L49	4869	38.1	127.7
2x4	L40	3972	32.0	124.1
	L52	5202	37.2	140.0
	L64	6396	48.5	131.9
	L82	8214	64.3	127.7

MULTIPLIER TABLE

		COLOR TEMPERATURE	
		CCT	CONVERSION FACTOR
80 CRI	2700K		0.97
	3000K		0.99
	3500K		1.00
	4000K		1.03
90 CRI	5000K		1.06
	2700K		0.80
	3000K		0.82
	3500K		0.83
	4000K		0.86
	5000K		0.89

- Photometrics tested in accordance with IESNA LM-79. Results shown are based on 25°C ambient temperature.
- Wattage shown is based on 120V input.
- Results based on 3500K, 80 CRI, actual lumens may vary +/-5%
- Use multiplier table to calculate additional options.

PHOTOMETRY

LT-24-L52/835-AF-DIM-UNV Total Luminaire Output: 5202 lumens; 37 Watts | Efficacy: 141 lm/W | 82 CRI; 3043 K CCT

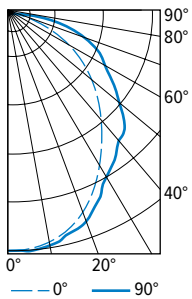

CANDLEPOWER DISTRIBUTION	VERTICAL ANGLE	HORIZONTAL ANGLE			ZONAL LUMENS
		0°	45°	90°	
	0	1851	1851	1851	
	5	1843	1844	1846	175
	15	1745	1761	1779	499
	25	1544	1589	1636	730
	35	1276	1359	1440	848
	45	1055	1193	1315	902
	55	741	902	1044	802
	65	480	667	817	647
	75	241	429	544	438
	85	70	174	159	161
	90	0	0	0	

LUMEN SUMMARY	ZONE	LUMENS	% FIXTURE
	0 - 30	1404	27
	0 - 40	2252	43
	0 - 60	3955	76
	0 - 90	5202	100
	0 - 180	5202	100

ADDITIONAL CONTROL OPTIONS

Note: Lumen restrictions apply, consult product builder at hew.com/product-builder.

CATALOG NUMBER	DESCRIPTION
DRV	Driver prewired for non-dimming applications
DIM	Dimming driver prewired for 0-10V low voltage applications
DIM1	1% dimming driver prewired for 0-10V low voltage applications
DIM LINE	Line voltage dimming driver (TRIAC and ELV compatible, 120V only)
DIM TRC	Line voltage dimming driver (TRIAC compatible, 120V or 277V only)
DSR	Sensor-ready driver
SD40	40% step-dimming driver
SD50	50% step-dimming driver
DALI	DALI dimming driver
LTE LINE	Lutron Hi-lume 1% 2-wire dimming driver forward phase line voltage controls (120V only)
LDE1	Lutron Hi-lume 1% EcoSystem dimming LED driver
LDE5	Lutron 5-Series 5% EcoSystem dimming LED driver
VRF/DSR	Lutron Vive integral fixture control, RF only (DFCSJ-OEM-RF) and sensor-ready driver
VRF/DBI/LDE1	Lutron Vive integral fixture control, RF only (DFCSJ-OEM-RF), Lutron Hi-lume 1% EcoSystem dimming LED driver, and digital link interface
VRF/DBI/LDE5	Lutron Vive integral fixture control, RF only (DFCSJ-OEM-RF), Lutron 5-Series 5% EcoSystem dimming LED driver, and digital link interface
ELDO SOLOB	EldoLED Solodrive, 0.1% dimming driver for 0-10V controls
ELDO SOLOB DALI	EldoLED Solodrive, 0.1% dimming driver for DALI controls
ELDO ECO1	EldoLED Ecodrive, 1% dimming driver for 0-10V controls
ELDO ECO1 DALI	EldoLED Ecodrive, 1% dimming driver for DALI controls

CROSS SECTIONS

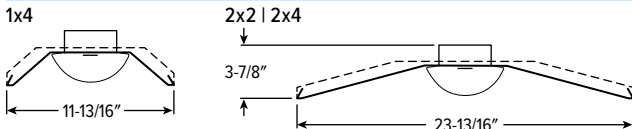

FIXTURE DETAILS

BACK VIEW

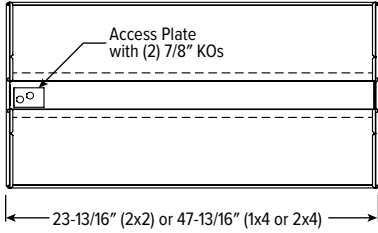

SIDE VIEW

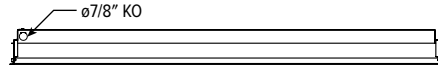

AIR RETURN

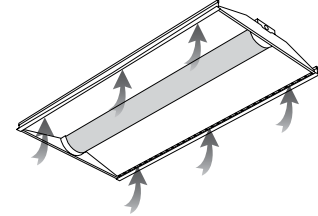

Total Air Return Space: 12-1/2" sq. (2x2) and 25-1/2" sq. (1x4 and 2x4)

SURFACE MOUNT KIT DETAILS



CROSS SECTIONS

1x4

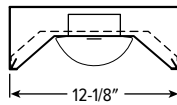

2x2 | 2x4

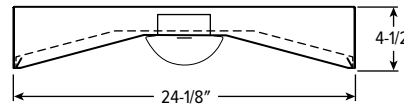

BACK VIEWS

1x4

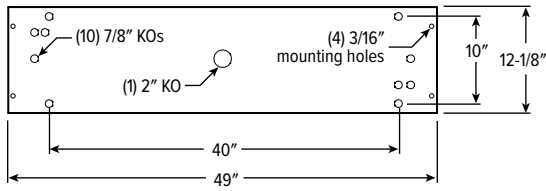

2x2

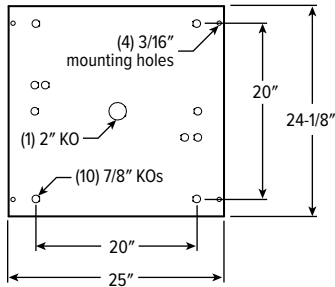

2x4

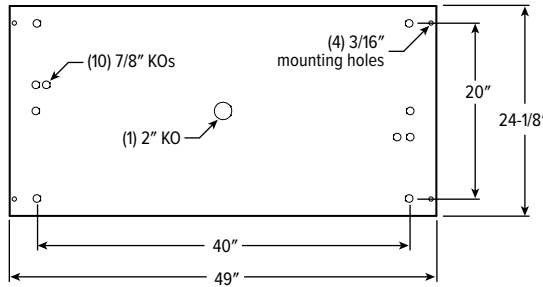

FLEXIBLE WHIP OPTIONS

All Williams recessed troffers are available with a flexible metallic wiring harness, factory-attached and hard-wired to the luminaire. See ordering information table.

Straight connectors are a snap-in type. Consult factory for wiring harness utilizing connectors secured by lock nuts, optional flex size, lengths, and other wire sizes or circuitry. Three-wire flex utilizes black, white, and green wire. Four-wire flex utilizes black, white, red, and green wire. Adding an emergency option requires an additional wire.

Williams fixtures are UL listed to provide factory-installation of several manufacturers' modular wiring devices. Consult factory for availability and ordering information.

DESIGNATION	DESCRIPTION	DRIVER
F338	6' of 3/8" flex, (3) No. 18 AWG wires with (2) straight connectors	DRV, LTE LINE
F348	6' of 3/8" flex, (4) No. 18 AWG wires with (2) straight connectors	SD40
F334	6' of 3/8" flex, (3) No. 14 AWG wires with (2) straight connectors	DRV, LTE LINE
F344	6' of 3/8" flex, (4) No. 14 AWG wires with (2) straight connectors	SD40
F358	6' of 3/8" flex, (5) #18 AWG wires with (2) straight connectors	DIM, DALI

