



Type:	Project:	Qty:
	Date:	
Catalog #:		

Description:

The Regolo RG2 LED series is a narrow recessed, nominal 2" wide profile, slot unit designed for grid ceiling systems. The slender design is ideal for corridors, open and private offices, classrooms, lobbies and general purpose rooms.

Specifications:

Construction: The housing consists of visible extruded aluminum trim rails with formed cold rolled steel back channel and heavy gauge end caps. Steel alignment tabs and white snap-in joiner clips are used for continuous row applications. Luminaire is finished textured white.

Reflector / Driver: Reflector / driver cover is finished with high reflectance white paint. Standard constant current electronic driver with 0-10V dimming input; dimming range from 100% down to 10%. Universal (UNV) voltage is from 120 - 277V, 50/60 Hz.

Shielding: Extruded frosted or satin white acrylic snap-in lens with DR.

LED Module: Distributed LED array in a variety of lumen output packages. LED color is available in (L30) 3000K, (L35) 3500K or (L40) 4000K. Module is replaceable. L90 ≥ 100,000 hours.

Mounting: Ceiling grid system. Non-IC rated. Individual mount or continuous runs.

Labels: ETL listed, conforms to UL Standard 1598 / 8750 and CSA Standard C22.2, Damp location.

Warranty: 5-year limited warranty on LED and Driver.

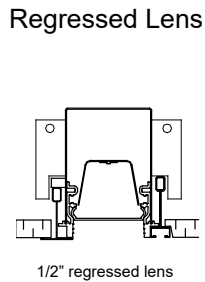
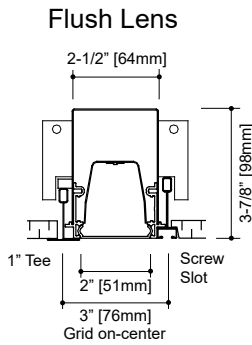

Drop Lens Option

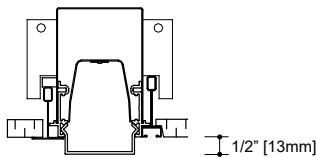

Ordering Information

Sample: RG2-05L40-UNV-D0-1C-STR-20'

Series	Lumen Package ² / Color	Voltage	Driver	Circuit	Shielding/Position	Length	Options
RG2 ¹							
RG2 (Grid - Nom. 2')	03 (~393 lm/ft, 3.28W/ft)	L30	UNV	1C Single Circuit 1E ⁵ Single Circuit w/ EM Circuit 1B ⁵ Single Circuit w/ Battery Pack	FR (Frosted) ST (Satin White)	F (Flush lens) R ⁶ (Regressed lens) D (Opaque Ends Drop lens) L (Luminous Ends Drop lens)	CP Chicago Plenum OS ⁸ End of run Occupancy Sensor DS ⁸ End of run Daylight Sensor FLEX 6' of Flex GLR Fusing See Accessories for Corners
	05 (~573 lm/ft, 4.85W/ft)	L35	120				
	06 (~732 lm/ft, 6.38W/ft)	L40	277				
	09 (~886 lm/ft, 7.79W/ft)						
	Consult Factory for Custom Lumen Package						
			Dimming (0-10V)				
			D ³ (Dim to 10%)				
			D1 ⁴ (Dim to 1%)				
			D0 ⁴ (Dim to 0%)				
			Lutron Dimming				
			See Page 2 for Ordering Codes				
			DALI Dimming				
			eldoLED ECOdrive				
			ELE (Dim to 1%)				
			eldoLED SOLOdrive				
			ELS (Dim to 0%)				
						Continuous Runs ⁷ XX' Specify run length in 1 foot increments. Consult factory for custom lengths.	

SHOP NOW >

Notes:

- Some products are DesignLights Consortium™ Qualified, refer to www.designlights.org Qualified Products List.
- Nominal lumen output per foot for frosted lens and 3500K.
- Standard driver, don't connect low-voltage wires for non-dimming applications. Consult factory for specifications and manufacturer.
- Consult factory for specifications and manufacturer.
- This circuiting option does NOT come with a plug-in wire connector between units. Contractor must field wire.
- We recommend our Satin White lens for the Regressed position.
- 6" increments are common custom lengths. We can provide custom run length down to the nearest (+/- 1/8").
- Not available with Drop Lens.



Specifications and dimensions are subject to change without notification. Specification sheets on our website supersede all other versions. 2016 Rev. D Nulite reserves the right to bulk package any order.

Ceiling Grid Details

1" Grid Detail

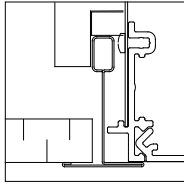

Standard Tile

9/16" Grid Detail

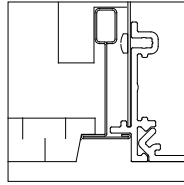

Tegular Tile

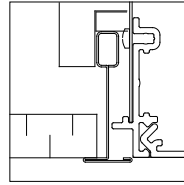

Standard Tile - 1-1/2" "T" height & supported by grid hook extension

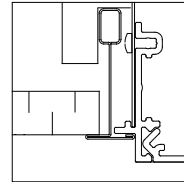

Standard Tile - Drop-down Luminaire

Screw Slot Detail

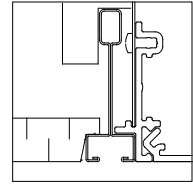

Tegular Tile

1" End Detail

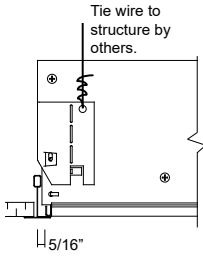

9/16" End Details

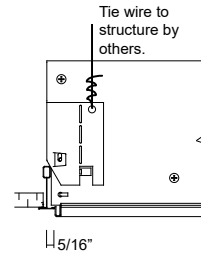
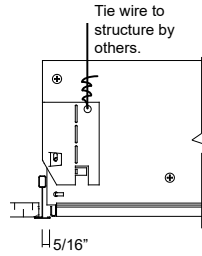
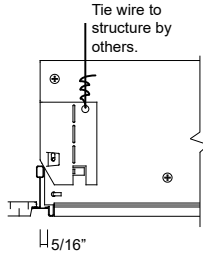

Screw Slot End Detail

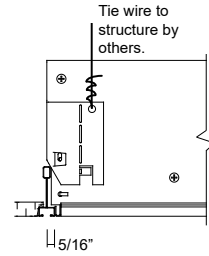

Lens Options

Shielding

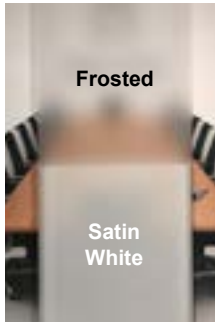

Frosted Lens

This diffuser is designed for a balance between efficiency and lens uniformity. (Transmission ~ 89%)

Satin White Lens

This diffuser is designed for visible lens uniformity. It's recommended for regressed lens configuration in our shallow housing. (Transmission ~ 69%)

Lutron Driver Ordering Codes

Nulite Code	Lutron Prefix	Lutron Series	Dim Level	Control Type	
				3-Wire	Eco-System™
L11	L3DAE	Hi-lume™	1%		Yes
L12	L3DA3W	Hi-lume™	1%	Yes	
L15	LDE1*	Hi-lume™ - H Series	1%		Yes
L16	LDE5	5-Series	5%		Yes

* Soft-on, Fade-to-Black™

Position

Regressed Lens - "R"



1/2" Regressed Lens (Satin White lens is recommended)

Drop Lens - "L"



1/2" Drop Lens with Luminous Acrylic Ends

Drop Lens - "D"



1/2" Drop Lens w/ Opaque White Metal Ends

Sensor Option



Occupancy and/or Daylight Sensor (Surface Mount 4" Shown)

Specifications and dimensions are subject to change without notification.

