



|            |          |      |
|------------|----------|------|
| Type:      | Project: | Qty: |
|            | Date:    |      |
| Catalog #: |          |      |

**Description:**

The Regolo RR2 series is a narrow, nominal 2" wide, surface mount LED luminaire. The slender design is ideal for corridors, open and private offices, classrooms, lobbies and general purpose rooms.

**Specifications:**

**Construction:** The housing consists of visible extruded aluminum side rails with formed cold rolled steel back channel and heavy gauge end caps. Housing can be joined together for continuous row applications. Standard finish is powder coat textured white. Optional silver, black or custom color paint finishes.

**Reflector / Driver:** Reflector / driver cover is finished with high reflectance white paint. Standard constant current electronic driver with 0-10V dimming input; dimming range from 100% down to 10%. Universal (UNV) voltage is from 120 - 277V, 50/60 Hz.

**Shielding:** Extruded frosted or satin white acrylic snap-in lens with DR.

**LED Module:** Distributed LED array in a variety of lumen output packages. LED color is available in (L30) 3000K, (L35) 3500K or (L40) 4000K. Module is replaceable. L90 ≥ 100,000 hours.

**Mounting:** Surface mount, individual or continuous row.

**Labels:** ETL listed, conforms to UL Standard 1598 / 8750 and CSA Standard C22.2, Damp location.

**Warranty:** 5-year limited warranty on LED and Driver.

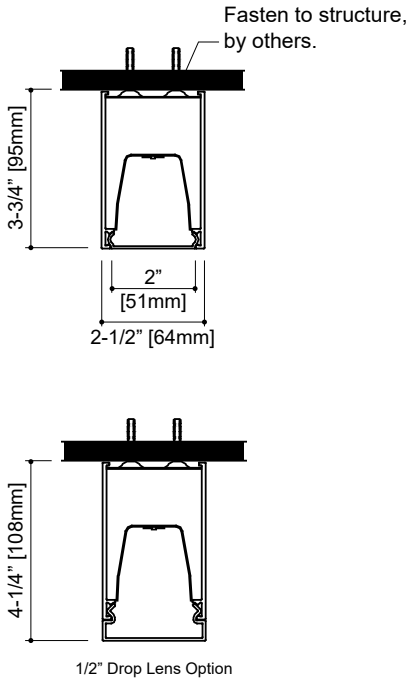

**Ordering Information**

Sample: RR2-05L35-UNV-D-1C-FRF-WH-20'

| Series                     | Lumen Package <sup>1</sup> / Color | Voltage | Driver | Circuit  | Shielding                 | Color                 | Length                                       | Options                                     |                                    |
|----------------------------|------------------------------------|---------|--------|--|---------------------------|-----------------------|--|---|------------------------------------|
| RR2                        |                                    |         |        |  |                           |                       |  |   |                                    |
| RR2<br>(Surface - Nom. 2') | 03 (~393 lm/ft, 3.28W/ft)          | L30     | UNV    | 1C Single Circuit                              | FR (Frosted)              | WH (White - Standard) | 2'   | OS <sup>6</sup> End of run Occupancy Sensor |                                    |
|                            | 05 (~573 lm/ft, 4.85W/ft)          | L35     | 120    |  |                           |                       | 1E <sup>4</sup> Single Circuit w/ EM Circuit |   | ST (Satin White)                   |
|                            | 06 (~732 lm/ft, 6.38W/ft)          | L40     | 277    | 1B <sup>4</sup> Single Circuit w/ Battery Pack | D (Opaque Ends Drop lens) | SV (Silver)           | 4'   | DS <sup>6</sup> End of run Daylight Sensor  |                                    |
|                            | 09 (~886 lm/ft, 7.79W/ft)          |         |        |  |                           |                       | L (Luminous Ends Drop lens)                  |   | CC (Custom Color)                  |
|                            | <b>Lutron Dimming</b>              |         |        |  |                           |                       |  | 6'  | GLR Fusing                         |
|                            | See Page 2 for Ordering Codes      |         |        |  |                           |                       |  | 7'  | <b>See Accessories for Corners</b> |
| <b>DALI Dimming</b>        |                                    |         |        |  |                           |                       | 8'   |   |                                    |
| eldoLED ECOdrive           |                                    |         |        |  |                           |                       |  |   |                                    |
| ELE (Dim to 1%)            |                                    |         |        |  |                           |                       |  |   |                                    |
| eldoLED SOLOdrive          |                                    |         |        |  |                           |                       |  |   |                                    |
| ELS (Dim to 0%)            |                                    |         |        |  |                           |                       |  |   |                                    |

SHOP NOW >

**Notes:**

1. Nominal lumen output per foot w/ frosted lens and 3500K.
2. Standard driver, don't connect low-voltage wires for non-dimming applications. Consult factory for specifications and manufacturer.
3. Consult factory for specifications and manufacturer.
4. This circuiting option does NOT come with a plug-in wire connector between units. Contractor must field wire.
5. 6" increments are common custom lengths. We can provide custom run length down to the nearest (+/- 1/8").
6. Not available with Drop Lens.



Specifications and dimensions are subject to change without notification. Specification sheets on our website supersede all other versions. 2016 Rev. D Nulite reserves the right to bulk package any order.

**Lens Options**

**Shielding**

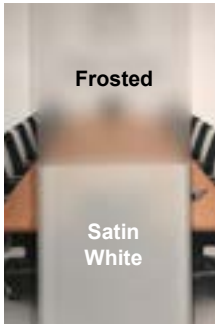

**Frosted Lens**  
This diffuser is designed for a balance between efficiency and lens uniformity. (Transmission ~ 89%)

**Satin White Lens**  
This diffuser is designed for visible lens uniformity. It's recommended for regressed lens configuration in our shallow housing. (Transmission ~ 69%)

“D” Opaque Metal End Drop Lens

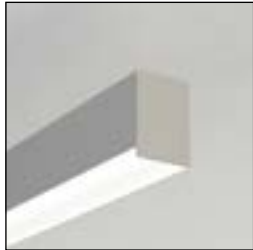

“L” Luminous Acrylic End Drop Lens

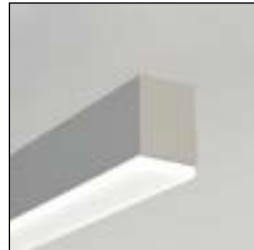

**Lutron Driver Ordering Codes**

| Nulite Code | Lutron Prefix | Lutron Series       | Dim Level | Control Type |             |
|-------------|---------------|---------------------|-----------|--------------|-------------|
|             |               |                     |           | 3-Wire       | Eco-System™ |
| L11         | L3DAE         | Hi-lume™            | 1%        |              | Yes         |
| L12         | L3DA3W        | Hi-lume™            | 1%        | Yes          |             |
| L15         | LDE1*         | Hi-lume™ - H Series | 1%        |              | Yes         |
| L16         | LDE5          | 5-Series            | 5%        |              | Yes         |

\* Soft-on, Fade-to-Black™

**Sensor Option**



Occupancy and/or Daylight Sensor

**Back of Housing Mounting Holes & Power Feed KO**

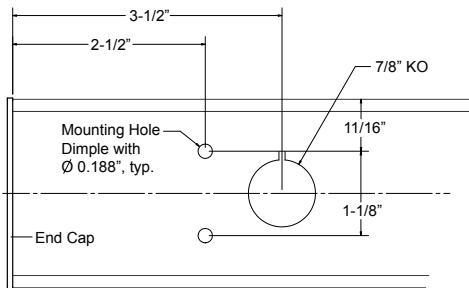

Typical End of Housing Detail

**Individual Lengths**

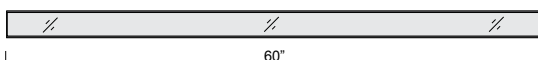
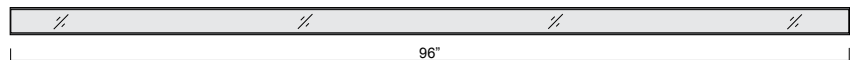
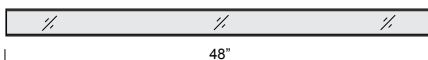
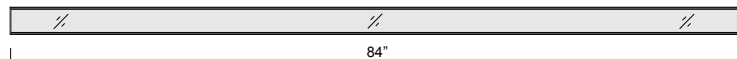
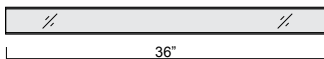
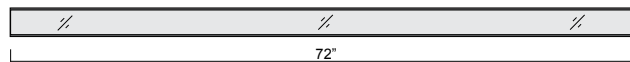
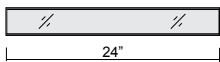

Add 3/32" per end cap to the length.

Specifications and dimensions are subject to change without notification.

