

Type:	Project:	Qty:
	Date:	
Catalog #:		

Description:

The Regolo RT4 series is a nominal 4" wide recessed trimless LED luminaire. The slender design is ideal for corridors, open and private offices, classrooms, lobbies and general purpose rooms.

Specifications:

Construction: The housing consists of extruded aluminum side rails with formed cold rolled steel back channel and heavy gauge end caps. Housing can be joined together for continuous row applications. Standard finish is powder coat textured white. Optional silver, black or custom color paint finishes.

Reflector / Driver: Reflector / driver cover is finished with high reflectance white paint. Optional asymmetric semi-specular aluminum reflector. Standard constant current electronic driver with 0-10V dimming input; dimming range from 100% down to 10%. Universal (UNV) voltage is from 120 - 277V, 50/60 Hz.

Shielding: Extruded frosted or satin white acrylic snap-in lens with DR.

LED Module: Distributed LED array in a variety of lumen output packages. LED color is available in (L30) 3000K, (L35) 3500K or (L40) 4000K. Module is replaceable. L90 ≥ 100,000 hours.

Mounting: Recessed, individual or continuous row.

Labels: ETL listed, conforms to UL Standard 1598 / 8750 and CSA Standard C22.2, Damp location.

Warranty: 5-year limited warranty on LED and Driver.

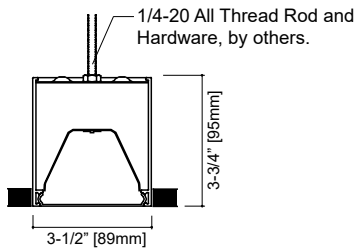

Drop Lens Option

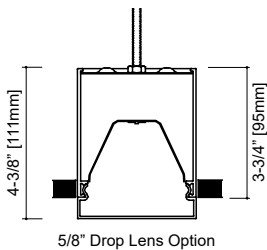

ASYM Option

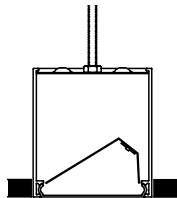

Ordering Information

Sample: RT4-05L35-UNV-ELE-1C-FRF-WH-20'

Series	Lumen Package ¹ / Color	Voltage	Driver	Circuit	Shielding	Color	Length	Options
RT4								
RT4 (Trimless - Nom. 4")	03 (~390 lm/ft, 3.28W/ft)	L30	UNV	Dimming (0-10V)	1C Single Circuit	FRF (Frosted Flush)	2'	OS ⁵ End of run Occupancy Sensor
	05 (~569 lm/ft, 4.85W/ft)	L35	120	D ² (Dim to 10%)	1E Single Circuit w/ EM Circuit	FRD (Frosted Drop Opaque End)	3'	DS ⁵ End of run Daylight Sensor
	06 (~724 lm/ft, 6.38W/ft)	L40	277	D1 ³ (Dim to 1%)	1B Single Circuit w/ Battery Pack	FRL (Frosted Drop Luminous End)	4'	FLEX 6" of Flex
	09 (~899 lm/ft, 7.79W/ft)			D0 ³ (Dim to 0%)		STF (Satin White Flush)	5'	ASYM ⁵ Asymmetric Reflector
	10 (~1036 lm/ft, 9.39W/ft)			Lutron Dimming	STD (Satin White Drop Opaque End)	6'	GLR Fusing	
				See Page 2 for Ordering Codes	STL (Satin White Drop Luminous End)	7'	See Accessories for Corners and Downlight Modules	
			DALI Dimming	Consult factory for uplight shielding or dust cover.	8'			
			eldoLED ECOdrive ELE (Dim to 1%)			Continuous Runs ⁴		
			eldoLED SOLOdrive ELS (Dim to 0%)			XX: Specify run length in 1 foot increments. Consult factory for custom lengths.		

SHOP NOW ➔

Notes:

- Nominal lumen output per foot w/ frosted lens and 3500K.
- Standard driver, don't connect low-voltage wires for non-dimming applications. Consult factory for specifications and manufacturer.
- Consult factory for specifications and manufacturer.
- 6" increments are common custom lengths. We can provide custom run length down to the nearest (+/- 1/8").
- Only available with Frosted Flush lens.



Lens Options

Shielding

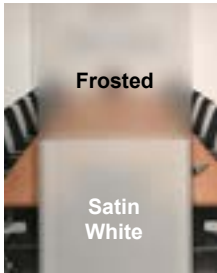

Frosted Lens

This diffuser is designed for a balance between efficiency and lens uniformity. (Transmission ~ 89%)

Satin White Lens

This diffuser is designed for visible lens uniformity. It's recommended for regressed lens configuration in our shallow housing. (Transmission ~ 69%)



Drop Lens w/ Opaque End



Drop Lens w/ Luminous End

Lutron Driver Ordering Codes

Nulite Code	Lutron Prefix	Lutron Series	Dim Level	Control Type	
				3-Wire	Eco-System™
L11	L3DAE	Hi-Lume™	1%		Yes
L12	L3DA3W	Hi-Lume™	1%	Yes	
L15	LDE1*	Hi-Lume™ - H Series	1%		Yes
L16	LDE5	5-Series	5%		Yes

* Soft-on, Fade-to-Black™

Sensor Options



Occupancy and/or Daylight Sensor (Surface Mount Shown)

Back of Housing Mounting Holes & Power Feed KO

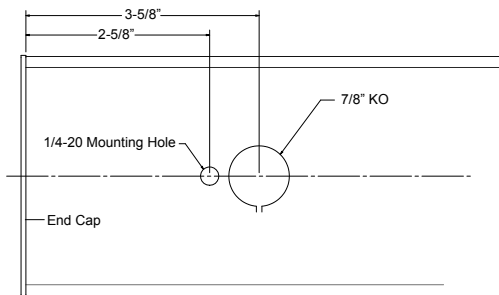

Typical End of Housing Detail

Individual Lengths

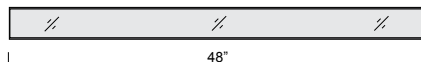
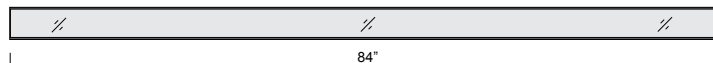
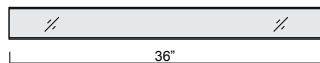
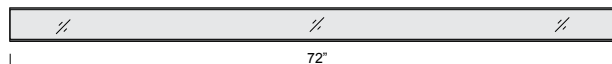
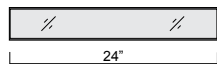

Specifications and dimensions are subject to change without notification.

Continuous Run Lengths

		Run Length																																															
		2'	3'	4'	5'	6'	7'	8'	9'	10'	11'	12'	13'	14'	15'	16'	17'	18'	19'	20'	21'	22'	23'	24'	25'	26'	27'	28'	29'	30'	31'	32'	33'	34'	35'	36'	37'	38'	39'	40'	41'	42'	43'	44'					
Number of Housings	2'	1																																															
	3'		1																																														
	4'			1					1	1	1	1					1	1	1	1						1	1	1	1							1	1	1	1				1	1	1	1			
	5'				1				1				1				1					1				1				1					1				1					1					
	6'					1				1				1				1					1				1				1					1				1					1				
	7'						1				1				1				1					1				1				1					1				1					1			
	8'							1				1	1	1	1	1	2	1	1	1	1	2	2	2	2	3	2	2	2	3	3	3	3	3	4	3	3	3	3	4	4	4	4	5	4	4	4	5	

Photometric Curves

Cat. # RT4-05L35-...-FRF-...-4'
Frosted Flush Lens
Wattage/ft - 4.85
Lumens/Watt - 117

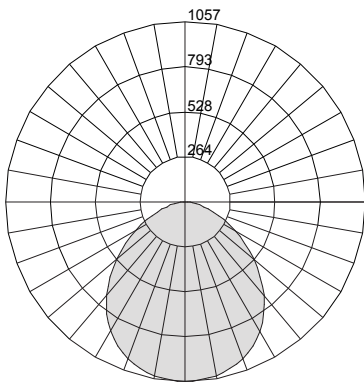

Cat. # RT4-09L35-...-FRF-...-4'
Frosted Flush Lens
Wattage/ft - 7.79
Lumens/Watt - 115

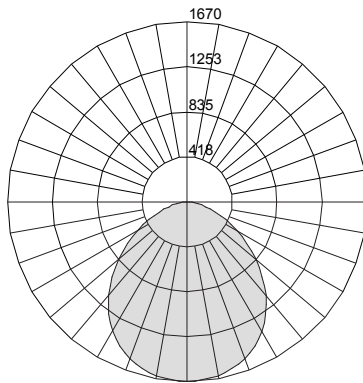

Cat. # RT4-05L40-...-FRF-...-4'-ASYM
Frosted Flush Lens
Wattage - 5.25
Lumens/Watt - 110

