

# EDGE EX3D

## 3" Direct Linear

### Key Features

- 6063-T6 Extruded aluminum housing
- Highly reflective die-formed white painted reflector
- Room side maintenance for LED system
- 5-year limited warranty covers LED, driver and fixture
- UL and cUL listed
- Approved for dry/damp location unless otherwise noted
- Maximum weight is 20 lbs. for a standard 4' fixture
- Buy American Act compliant
- Run lengths available to an 1/8"



Example Part #: EX3D-HE-N-830HO-26'-AC48G1-U-OL1-1-0-W

<b>EX3D</b> -	<b>-N</b>										
DIRECT SHIELDING	INDIRECT SHIELDING	SOURCE	LENGTH OR PATTERN	MOUNTING	VOLTAGE	DRIVER	CIRCUITING	BATTERY & EMERGENCY	FINISH	FIXTURE OPTIONS	CONTROLS

---	<b>N</b>	-----	----
<b>DIRECT SHIELDING</b>	<b>INDIRECT SHIELDING</b>	<b>SOURCE</b> <i>QS</i> <sup>1</sup>	<b>LENGTH OR PATTERN</b> <sup>2</sup>
<b>A</b> - Satine Lens <i>QS</i> <b>AL</b> - Drop Lens <b>HE</b> - High Efficiency <i>QS</i> <b>BW</b> - Batwing <i>QS</i> <b>WHE</b> - Asymmetric <i>QS</i> <b>HED</b> - Descent Shielding pg. 2	<b>N</b> - None Shielding pg. 2	<b>27</b> - 2700K <b>30</b> - 3000K <b>35</b> - 3500K (available with BIOS) <b>40</b> - 4000K (available with BIOS) <b>CL</b> - Custom Lumens <b>CW</b> - Custom Watts Lumen Output pg. 2	- Individual Fixture <i>QS</i> - Continuous Row <i>QS</i> <b>S</b> - Square <i>QS</i> <b>R_x</b> - Rectangle <i>QS</i> <b>L_x</b> - L Shape <i>QS</i> <b>U_x</b> - U-Shape <i>QS</i> <b>T_x</b> - T-Shape <b>X_x_x</b> - X-Shape <b>M</b> - Mod Layout Length and Pattern pg. 2-3
-----	-	---	-
<b>MOUNTING</b> <sup>3</sup>	<b>VOLTAGE</b>	<b>DRIVER</b>	<b>CIRCUITING</b>
<b>AC_G</b> - (M)AC to Grid <i>QS</i> <b>AC_JB</b> - (M)AC to J Box <i>QS</i> <b>AC_ST</b> - (M)AC to Structure <i>QS</i> <b>AC5_G</b> - 5" Non-Power Canopy <b>AC5_JB</b> - 5" Non-Power Canopy <b>SQ_G</b> - 5" Square Canopy <b>SQ_JB</b> - 5" Square Canopy <b>WA</b> - Wall Mount <i>QS</i> <b>S</b> - Surface Mount <i>QS</i> Mounting pg. 3	<b>U</b> - Universal (120 thru 277V) <i>QS</i> <b>1</b> - 120V <i>QS</i> <b>2</b> - 277V <i>QS</i> <b>3</b> - 347V Voltage pg. 4	<b>OL1</b> - Osram (10%, 0-10v, standard) <i>QS</i> <b>OL2</b> - Osram (1%, 0-10v) <i>QS</i> <b>OL3</b> - Osram 347v (10%, 0-10v) <b>EE1</b> - eldoLED ECOdrive (1%, 0-10v) <b>EE1</b> - eldoLED SOLOdrive (0%, 0-10v) <b>LH1</b> - Lutron Hi-lume (1%, EcoSystem) <i>QS</i> <b>L51</b> - Lutron 5-Series (5%, EcoSystem) <b>PL2</b> - Advance Xitanium (1%, 0-10v) <i>QS</i> <b>PS1</b> - Advance Xitanium (50%/100%) <b>ND</b> - Non-Dimming <i>QS</i> Driver pg. 4	<b>1</b> - Single Circuit <i>QS</i> <b>M</b> - Multi Circuit <b>E</b> - Emergency (entire fixture) <i>QS</i> <b>N</b> - Night Light (entire fixture) <i>QS</i> Circuiting pg. 4
---	---	---	---
<b>BATTERY &amp; EMERGENCY</b> <sup>4</sup>	<b>FINISH</b>	<b>FIXTURE OPTIONS</b> <sup>5</sup>	<b>CONTROLS</b> <sup>6</sup>
<b>0</b> - None <i>QS</i> <b>PL</b> - Bodine 10W <b>IL</b> - Iota 10W Integral <i>QS</i> <b>E</b> - Emergency Section <b>N</b> - Night Light Section <b>L</b> - Life Safety Section <b>G</b> - Bodine GTD Battery and Emergency pg. 4	<b>W</b> - White <i>QS</i> <b>S</b> - Metallic Silver <i>QS</i> <b>BL</b> - Textured Black <i>QS</i> <b>BR</b> - Bronze <b>GR</b> - Graphite <b>CC</b> - Custom Color Finish pg. 5	<b>QS</b> - Quick Ship <i>QS</i> <b>LMRA</b> - Adjustable MR16 (LED) <b>XLED</b> - Fixed Xicato LED Fixture Options pg. 5-6	<b>NLTAIR</b> - Acuity nLight AIR (wireless) <b>EASYS</b> - Philips EasySense (wireless) <b>SNSLM</b> - Osram Sensillum (wireless) <b>WVLX</b> - Eaton WaveLinX (wireless) <b>VDO</b> - Lutron Vive Sensor (wireless) <b>VRF</b> - Lutron Vive Connected (wireless) Controls pg. 6

<sup>1</sup>When specifying SOURCE the first \_ is for specifying either **8** - 80CRI, **9** - 90CRI or **B** - BIOS. The ending \_ are for specifying output, example **HO** - High Output. When specifying BIOS use **B** and then specify color temperature, either 3500K or 4000K, and output, example **B35HO** - BIOS 3500K High Output. See output charts for more information. For Quickship CRI, CCT & Output see chart on page 5 <sup>2</sup>Individual fixtures come in 2', 3', 4', 5', 6', 7' & 8' lengths. Continuous row come in 1/8" increments. For Mod layouts specify pattern shape and overall dimensions. Example: L6x4: L pattern that is 6'x4'. <sup>3</sup>Specify AC Cable: Standard single AC = AC or Movable AC = MAC; Specify AC length standard AC is 48"; Specify grid: G1=15/16", G9=9/16", GS=Screw Slot. Example: AC48G1 <sup>4</sup>Enter quantity for Battery and Emergency, Example 2P. <sup>5</sup>QS must be used in fixture options section of part number to qualify. 1/8" increments not available for QS. <sup>6</sup>Controls can only be used with Single Circuit (1) or Emergency Circuit (E). See Controls chart on page 5 for driver options and more information.

Specifications and dimensions subject to change without notice. Specification sheets that appear on pinnacle-ltg.com are the most recent version and supersede all other previously printed or electronic versions.



Direct Shielding

Indirect Shielding

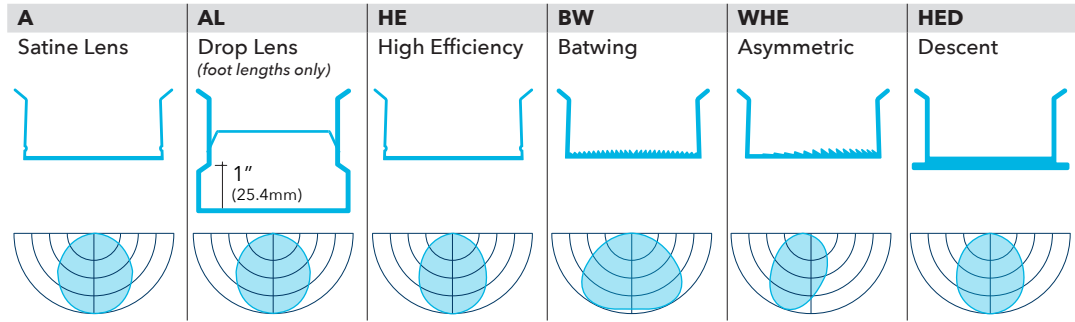

Source: White LED<sup>1</sup>

- Specify either 80 or 90 CRI
- Longer lead-time may apply for 90 CRI. Consult factory.
- 80 CRI = R9≥19 and 90 CRI = R9≥61
- Not all products qualify for DLC listing. For a complete listing of the EV3D products that qualify for DLC, please go to the DLC website.

Custom Output - Lumens OR Wattage

<b>CL</b> _____	Specify CRI, CCT and desired lumens (i.e. CL835500)	Specify lumens between standard offering listed below. Lumens are specified per color temp
<b>CW</b> _____	Specify CRI, CCT and desired wattage (i.e. CW9407)	Specify watts between standard offering listed below

80 CRI

	Color	Lumens per foot	Shielding <sup>1</sup>		AL Drop		HE High Efficiency		BW Batwing		WHE Asymmetric		HED Descent	
			A Satine LPW	Watts/ft	LPW	Watts/ft	LPW	Watts/ft	LPW	Watts/ft	LPW	Watts/ft	LPW	Watts/ft
<b>830</b>	3000K	500	97	5.2	120	4.2	107	4.7	102	4.9	99	5.1	95	5.2
<b>830HO</b>	3000K	750	97	7.8	121	6.2	108	6.9	103	7.3	100	7.5	95	7.9
<b>830VHO</b>	3000K	1000	84	11.8	121	8.2	111	9.0	104	9.6	102	9.8	97	10.3
<b>835</b>	3500K	500	99	5.0	124	4.0	110	4.5	105	4.8	102	4.9	97	5.1
<b>835HO</b>	3500K	750	100	7.5	125	6.0	111	6.8	105	7.1	103	7.3	98	7.7
<b>835VHO</b>	3500K	1000	87	11.5	125	8.0	111	9.0	108	9.3	104	9.6	100	10.0
<b>840</b>	4000K	500	99	5.0	124	4.0	110	4.5	105	4.8	102	4.9	97	5.1
<b>840HO</b>	4000K	750	100	7.5	125	6.0	111	6.8	105	7.1	103	7.3	98	7.7
<b>840VHO</b>	4000K	1000	88	11.4	125	8.0	111	9.0	108	9.3	104	9.6	100	10.0

90 CRI

<b>927</b>	2700K	500	79	6.3	100	5.0	88	5.7	84	6.0	81	6.2	78	6.4
<b>927HO</b>	2700K	750	82	9.2	100	7.5	89	8.5	84	9.0	84	8.9	80	9.4
<b>930</b>	3000K	500	85	5.9	108	4.6	97	5.2	90	5.6	87	5.7	84	5.9
<b>930HO</b>	3000K	750	86	8.7	109	6.9	96	7.8	91	8.2	88	8.5	85	8.9
<b>935</b>	3500K	500	85	5.9	107	4.7	96	5.2	90	5.6	87	5.7	84	5.9
<b>935HO</b>	3500K	750	86	8.7	108	6.9	96	7.8	91	8.3	88	8.5	84	8.9
<b>940</b>	4000K	500	85	5.9	107	4.7	96	5.2	90	5.6	87	5.7	84	5.9
<b>940HO</b>	4000K	750	86	8.7	108	6.9	96	7.8	91	8.3	88	8.5	84	8.9

Source: BIOS<sup>1</sup>

- CRI >84, R9 >90
- Spectrum focused lighting for circadian stimulus
- High EML or M/P ratio: .8 for 3500K, .9 for 4000K
- COI: ≤3.3
- Available for use with most Driver or Control options

Custom Output - Lumens OR Wattage

<b>CLB</b> _____	Specify CRI, CCT and desired lumens (i.e. CL835500)	Specify lumens between standard offering listed below. Lumens are specified per color temp
<b>CWB</b> _____	Specify CRI, CCT and desired wattage (i.e. CW9407)	Specify watts between standard offering listed below

BIOS

	Color	Lumens per foot	Shielding <sup>1</sup>		HE High Efficiency		BW Batwing	
			A Satine LPW	Watts/ft	LPW	Watts/ft	LPW	Watts/ft
<b>B35</b>	3500K	500	57	8.7	67	7.4	61	8.2
<b>B35HO</b>	3500K	750	N/A	N/A	66	11.4	60	12.5
<b>B40</b>	4000K	500	59	8.6	69	7.2	62	8.0
<b>B40HO</b>	4000K	750	N/A	N/A	68	11.1	61	12.3

<sup>1</sup>LPW and watts/ft based off 48" fixture size.

Specifications and dimensions subject to change without notice. Specification sheets that appear on pinnacle-ltg.com are the most recent version and supersede all other previously printed or electronic versions.



## Length

- Individual units cannot be joined, end plates are factory installed and cannot be removed
- For Continuous Runs, add 3/16" (4.7mm) for each end plate or 3/8" (9.5mm) to the overall length of the row
- For patterns, refer to Pattern section on next page

2	3	4	5	6	7	8	-
Indiv. Fixture	Indiv. Fixture	Indiv. Fixture	Indiv. Fixture	Indiv. Fixture	Indiv. Fixture	Indiv. Fixture	Cont. Run
24-3/8" (619.1mm)	36-3/8" (934.8mm)	48-3/8" (1228.7mm)	60-3/8" (1533.5mm)	72-3/8" (1838.3mm)	84-3/8" (2143.1mm)	96-3/8" (2447.9mm)	Specify nominal overall row length to the 1/8" Longer lead-time may apply for lengths to the 1/8". Consult factory.
							Specify to the 1/8"

## Pattern

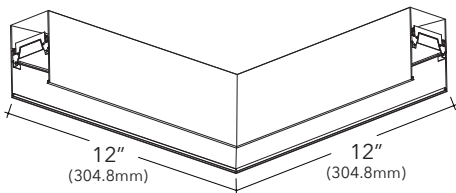

- Specify pattern shape and overall dimensions (includes corner dimensions)
- Refer to dimensions table below for available standard lengths
- All connectors are direct only
- 90 degree horizontal corners are 12"x12" (overall, outside dimension)
- Angles and shapes not shown require Mod Pattern; consult factory
- Only available with "A" or "HE" lens options

S_	R_x	U_x_x_	L_x_	T_x_	X_x_	M
Square Provide A dimension Example: <b>S4'</b> Minimum Length- 4'x4'	Rectangle Provide AxB dimensions Example: <b>R4'x4'</b> Minimum Length- 4'x4'	U-Shape Provide AxBxC dimensions Example: <b>U3'x4'x3'</b> Minimum Length- 3'x4'x3'	L-Shape Provide AxB dimensions Example: <b>L3'x3'</b> Minimum Length- 3'x3'	T-Shape Provide AxB dimensions Example: <b>T3'x5'</b> Minimum Length- 3'x5'	X-Shape Provide AxB dimensions Example: <b>X5'x5'</b> Minimum Length- 5'x5'	Mod Layout For patterns or lengths not shown or standard

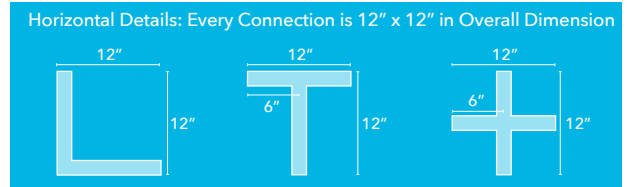
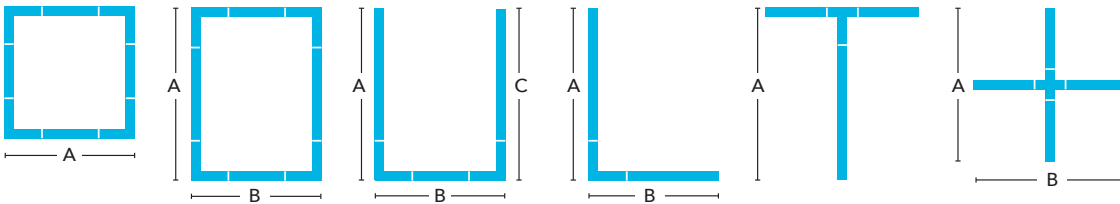



## Mounting

- Specify cable length in ordering code (AC48G1)
- Standard adjustable cable, specify 48", 120", 240", or 350"
- End plates and power cord attached at factory
- Aircraft cable (AC) mounts on 4' (1219.2mm) and 8' (2438.4mm) centers
- Maximum recommended movable mounting locations are 12" from end of 4' fixture and 18" from end of 8' fixture
- Aircraft Cable supplied with 5" (127mm) power and 2" (50.8mm)

- non-power canopies
- Canopies and pendants match fixture finish, power cords are white, grey, or black depending on fixture finish. See Finish section for additional details.
- Approved for dry/damp location unless otherwise noted
- Refer to installation instructions during installation at the job site
- Maximum fixture weight is 20 lbs for a standard 4' fixture

<b>AC_G1</b>	Aircraft Cable 1" (15/16") T-Bar
<b>AC_G9</b>	Aircraft Cable 9/16" T-Bar
<b>AC_GS</b>	Aircraft Cable Screw Slot T-Bar
<b>AC_JB</b>	Aircraft Cable Junction Box
<b>AC_ST</b>	Aircraft Cable Structure
<b>AC5_G</b>	Aircraft Cable 5" (127mm) Non-Power Canopy
<b>AC5_JB</b>	Aircraft Cable 5" (127mm) Non-Power Canopy
<b>SQ_G</b>	Aircraft Cable 5" (127mm) Square Canopy
<b>SQ_JB</b>	Aircraft Cable 5" (127mm) Square Canopy
<b>MAC_G1</b>	Moveable AC 1" (15/16") T-Bar
<b>MAC_G9</b>	Moveable AC 9/16" T-Bar
<b>MAC_GS</b>	Moveable AC Screw Slot T-Bar
<b>MAC_JB</b>	Moveable AC Junction Box
<b>MAC_ST</b>	Moveable AC Structure
<b>MAC5_G</b>	Moveable AC 5" (127mm) Non-Power Canopy
<b>MAC5_JB</b>	Moveable AC 5" (127mm) Non-Power Canopy
<b>MSQ_G</b>	Moveable AC 5" (127mm) Square Canopy
<b>MSQ_JB</b>	Moveable AC 5" (127mm) Square Canopy
<b>WA</b>	Wall Mount
<b>S</b>	Surface Mount

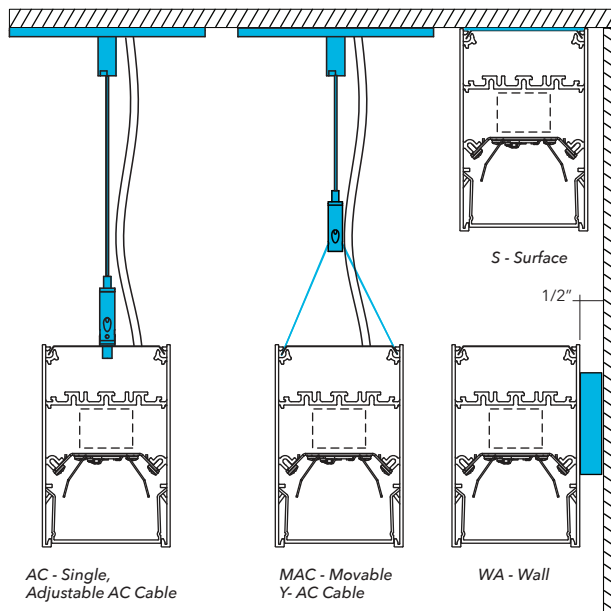

## Straight EDGE Joint System

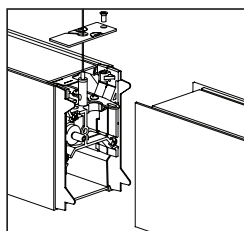

- The Straight EDGE Joint comes standard for all runs.
- Two connection points - one to cinch fixtures together, the other to perfectly align all fixtures in a run.
- Factory-installed light shields on both sides of the fixture ensure no light leaks.
- Patented.

## Voltage

- Some EX3D configurations will not accommodate all voltage options; consult with factory

<b>U</b>	Universal
<b>1</b>	120 volt
<b>2</b>	277 volt
<b>3</b>	347 volt

## Driver

- Standard Driver Option = OL1
- Driver Lifetime: 50,000 hours at 25°C ambient operating conditions
- For more driver options see Pinnacle Resource Guide
- Some EX3D configurations will not accommodate all driver options; consult with factory

<b>OL1</b>	Osram Optotronic 10%, 0-10v
<b>OL2</b>	Osram Optotronic 1%, 0-10v, nominal 1% dimming range
<b>OL5</b>	Osram Optotronic 1%, 0-10v, AUX
<b>OD1</b>	Osram Optotronic 1%, DEXAL
<b>EE1</b>	eldoLED ECOdrive 1%, 0-10v Logarithmic
<b>EE6</b>	eldoLED ECOdrive 1%, for nLight Air Wireless
<b>ES1</b>	eldoLED SOLOdrive 0%, 0-10v Logarithmic
<b>ES6</b>	eldoLED SOLOdrive 0%, for nLight Air Wireless
<b>LH1</b>	Lutron Hi-lume Soft-on, Fade-to-black 1%, EcoSystem, LDE1
<b>L51</b>	Lutron 5-Series 5%, EcoSystem, LDE5
<b>PL2</b>	Philips Advance Xitanium 1%, 0-10v
<b>PR1</b>	Philips Advance Xitanium SR, requires EASY, VDO, or VRF
<b>ND</b>	Non-Dimming

Specifications and dimensions subject to change without notice. Specification sheets that appear on pinnacle-ltg.com are the most recent version and supersede all other previously printed or electronic versions.

Designed in Denver, CO • USA | pinnacle-ltg.com | O: 303-322-5570 F: 303-322-5568

EX3D\_LED\_SPEC\_MARCH2020



## How to specify Circuiting, Battery and Emergency

- 1**
- Select fixture circuiting from options below
  - Some EX3D configurations will not accommodate all circuiting options, consult with factory

### Circuiting

<b>1</b>	Single Circuit
<b>M</b>	Multi Circuit
<b>E</b>	Emergency Circuit only
<b>N</b>	Night Light Circuit only

- 2** + **3**
- Battery and emergency section options are available in addition to fixture circuit
  - Select battery and emergency section options below; factory shop drawing required
  - Some EX3D configurations will not accommodate all circuiting options, consult with factory

### Battery and/or Emergency *If Required*

<b>0</b>	No battery or specific emergency section required
----------	---

### Battery

- Select battery section type if required, indicate total QTY. *Example 2PL*
- 90 minute battery runtime; test button is remote to fixture and requires an additional drop
- No battery option available for 2' lengths
- Entire direct fixture housing is on battery for lengths up to 5'
- Half of direct fixture is on battery for 6' or 8' housing lengths
- For more battery options available, see Pinnacle Resource Guide

<b>0</b>	No battery
<b>_PL</b>	Philips Bodine 10w Integral
<b>_IL</b>	Iota 10w Integral

#### For Approximate Battery Lumen Output

- Multiply battery wattage X fixture LPW shown on Lumen Table
- 92.3 (LPW) x 10 (watts) = 923 battery lumen output

### Emergency

- Select emergency section type if required, indicate total QTY. *Example 1E*
- Combine battery and emergency section ordering codes if both options are selected

<b>_E</b>	Emergency circuit section
<b>_N</b>	Night Light circuit section
<b>_L</b>	Life Safety circuit section NO THROUGH WIRE
<b>_G</b>	Philips Bodine GTD, Generator Transfer Device section

#### Battery OR Emergency Ordering Examples

- |  |                      |
|--|----------------------|
| • Single circuit, 10w Integral Battery | Ordering Code: 1-1PL |
| • Emergency only, 10w Integral Battery | Ordering Code: E-1PL |
| • Single circuit, GTD required         | Ordering Code: 1-1G  |

#### Combination Section Ordering Examples

- |  |                        |
|--|------------------------|
| • Single circuit, (1) 10w battery, (1) emergency section | Ordering Code: 1-1PL1E |
| • Multi circuit, (2) 10w battery, (2) emergency sections | Ordering Code: M-2PL2E |
| • Single circuit, (1) night light section                | Ordering Code: 1-1N    |

### Finish

- Standard powder-coat textured white, metallic silver, textured black, graphite or bronze painted finish; consult factory for chip of standard paint finishes
- Selecting a fixture finish other than white may impact lumen output; consult factory for more information

<b>W</b>	White <i>(white cord/white canopy)</i>
<b>S</b>	Metallic Silver <i>(grey cord/silver canopy)</i>
<b>BL</b>	Textured Black <i>(black cord/black canopy)</i>
<b>BR</b>	Bronze <i>(white cord/bronze canopy)</i>
<b>GR</b>	Graphite <i>(white cord/graphite canopy)</i>
<b>CC</b>	Custom Color <i>(white cord/color match canopy)</i>

### Fixture Options

- Additional options to enhance the fixture and finish of the product
- Consult factory for MR16 configurations

<b>QS</b>	10 day Quick Ship
<b>LMRA</b>	Adjustable MR16 LED <i>(not available with U voltage)</i>
<b>XLED</b>	Fixed Xicato LED



## Quick Ship

Shielding	CRI, CCT & Output	Mounting	Voltage	Driver	Circuiting	Battery	Finish
<b>10-Day</b>							
<b>A</b>	80 CRI, all color temperatures, all lumen packages <i>See pg 2</i>	<b>(M)AC48G_</b> (M)AC to Grid <b>(M)AC48JB</b> (M)AC to J-BOX <b>(M)AC48ST</b> (M)AC to Structure <b>W</b> Wall Mount <b>S</b> Surface Mount	<b>U</b> Universal (120-277) <b>1</b> 120V <b>2</b> 277V	<b>OL1</b> Osram 0-10v, 10% <b>OL2</b> Osram 0-10v, 1% <b>PL2</b> Advance Xitanium 0-10v, 1% <b>LH1</b> Lutron LDE1 <b>ND</b> Non-Dimming	<b>1</b> Single Circuit <b>E</b> Emergency <b>N</b> Night Light	<b>0</b> None <b>_I</b> Iota 10w <b>Integral</b>	<b>W</b> White <b>S</b> Silver <b>BL</b> Black

All lengths and continuous rows up to 1,000 ft OR 150 individual fixtures. Black QuickShip only available in 4', 6', and 8' individual lengths. Consult factory for larger projects.

## Controls

- Pinnacle Lighting offers easy to specify network control solutions that connect to an intelligent centralized system to maximize lighting energy efficiencies or integral sensors for individual fixture control
- Pinnacle Lighting fixtures ship technology ready; commissioning by others
- Controls can only be used with Single Circuit (1) or Emergency Circuit (E)
- Contact factory for any non-standard configurations for layout, placement, or EM options
- One drop/sensor per run typical, contact factory for more information
- Must specify required driver in Driver Section

	Solution	Components	Network/Sensor	Connection	Required Drivers	Limitations
<b>NLTAIRS</b>	Acuity nLight AIR Wireless	RES7 G2	nLight, Daylight/PIR Occupancy Sensor	Wireless	EE6, ES6	Not available with 347 volt
<b>NLTAIRM</b>	Acuity nLight AIR Wireless	RES7 PDT G2	nLight, Daylight/PIR Occupancy Sensor	Wireless	EE6, ES6	Not available with 347 volt
<b>NLTAIR</b>	Acuity nLight AIR Wireless Connected	RIO EZDL G2	nLight	Wireless	EE6, ES6	Not available with 347 volt
<b>EASYS</b>	Philips EasySense	SNS-200	Daylight/PIR Occupancy	Wireless to switches	PR1	Not available with 347 volt
<b>SNSLM</b>	Osram Sensilum	EN-CLM-PIR-DD-ZB	Encelium, Daylight/PIR Occupancy	Wireless	OD1, OL1, OL2	Not available with 347 volt
<b>WLVX</b>	Eaton WaveLinx	SWPD1, MSP31VMVDC1	WaveLinx WCL, Daylight	Wireless	Any 0-10v	Not available with 347 volt
<b>VDO</b>	Lutron Vive Sensor	DFCSJ-OEM-OCC	Vive, Daylight/PIR Occupancy	Wireless	OD1, PR1	Not available with 347 volt
<b>VRF</b>	Lutron Vive Connected	DFCSJ-OEM-RF	Vive	Wireless	OD1, PR1	Not available with 347 volt

## Photometrics

### Satine Lens

Test # ITL89801  
 Catalog # EX3D-HE-840-4  
 Lumens 1978 lm  
 Watts 19.3 W  
 Efficacy 102.5 LPW

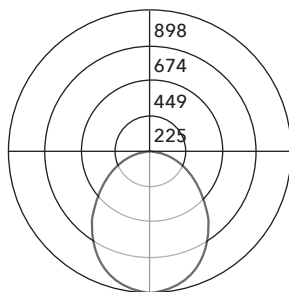

### Candela Distribution

Vert Angle	Horizontal Angle				
	0	22.5	45	67.5	90
0	898	898	898	898	898
5	892	892	891	889	888
10	876	872	869	863	861
15	851	840	832	822	815
20	813	797	783	765	756
25	764	744	724	698	687
30	707	685	657	626	613
35	643	620	587	551	537
40	579	553	517	479	463
45	508	483	445	409	394
50	437	414	377	344	330
55	367	347	313	283	272
60	300	283	253	228	218
65	236	222	197	178	169
70	174	165	145	130	126
75	117	110	97	87	85
80	68	64	56	51	50
85	28	27	23	21	22
90	0	0	0	0	0

### Luminance Data (cd/sq.m)

Angle In Degrees	Average 0-Deg	Average 45-Deg	Average 90-Deg
45	7804	6836	6053
55	6951	5928	5151
65	6066	5064	4344
75	4911	4071	3568
85	3490	2867	2742

For all available IES files, please visit our website at [pinnacle-ltg.com](http://pinnacle-ltg.com). Photometry testing in accordance to IESNA-LM-79-08 at an NVLAP accredited testing laboratory. Testing conducted at 25°C ambient conditions

Specifications and dimensions subject to change without notice. Specification sheets that appear on [pinnacle-ltg.com](http://pinnacle-ltg.com) are the most recent version and supersede all other previously printed or electronic versions.

Designed in Denver, CO • USA | [pinnacle-ltg.com](http://pinnacle-ltg.com) | O: 303-322-5570 F: 303-322-5568

EX3D\_LED\_SPEC\_MARCH2020



## Applications & Certificates

**Construction:** 6063-T6 Extruded aluminum housing. Highly reflective steel white painted reflector.

**Shielding:** Diffuse snap-in acrylic lens, removable for maintenance.

**Mounting:** Aircraft cable and wall mount available. Select from 2 aircraft cable options. Select the straight aircraft cable that mounts on 4'-0" (1219.2mm) and 8'-0" (2438.4mm) centers or the moveable adjustable Y-cable mount. The Y-Cable design allows for adjustable mounting locations. Aircraft Cable supplied with 5" (127mm) power and 2" (50.8mm) non-power canopies. Refer to installation instructions for appropriate ceiling detail. Canopies are painted white unless otherwise specified. Maximum fixture weight is 20 lbs. for a standard 4' fixture.

**LED:** 25°C test environment. Lumen output/wattage has a margin of +/- 5%; 2' or 3' lengths may have a greater wattage deviation. All luminaire configurations tested in accordance with IES LM-79. Diodes tested in accordance with IES LM-80. Lifetime calculated using IES TM-21. Minimum lifetime greater than 60,000 hours. L70 = 136,200 hours and L90 = 41,100 hours. MacAdam 3-Step Ellipses. For all available IES files, please visit our website at [pinnacle-ltg.com](http://pinnacle-ltg.com).

**BIOS LED:** Spectrum focused lighting for circadian stimulus. EML or M/P ratio: .8 for 3500K, .9 for 4000K. COI >3.0. Not all lumen packages available. Two lumen packages available. Standard, and High (HO). Custom outputs are available. Specify custom lumens or watts between standard offering listed on CRI, CCT & Output page.

**CRI, CCT & Output:** Two lumen packages available. Standard and High (HO). Custom outputs are available. Specify custom lumens or watts between standard offering listed on CRI, CCT & Output page. 80 CRI is available for 3000K, 3500K, and 4000K. 90 CRI is available for 2700K, 3000K, 3500K, and 4000K. 80 CRI = R9≥19 and 90 CRI = R9≥61.

**Voltage:** Universal (U), 120 volt (1), 277 volt (2) and 347 volt (3) options available. Must specify OL3 in Driver section when 347 volt (3) is selected. Some EX configurations will not accommodate all voltage options; consult with factory.

**Driver:** Standard Driver Option is Osram 0-10V, 10% = OL1. Electronic driver, Power factor is >0.9 with a THD <20%. Driver Lifetime: 50,000 hours at 25°C ambient operating conditions. Ambient operating range: -20°F/-30°C to 120°F/49°C. For more driver options, see Pinnacle Resource Guide. Some EX configurations will not accommodate all driver options.

**Circuiting:** Select from single circuit (1), Multi circuit (M), Emergency circuit (E) or Night Light circuit (N). For emergency circuiting situations that require no through wire or circuit separation, Life Safety Circuit should be selected. This will provide a separate power feed and only the Life Safety Circuit in that section. Some EX configurations will

not accommodate all circuiting options, consult with factory.

**Battery & Emergency:** Select battery or emergency options if required. If battery or emergency option is not required, enter 0. Battery duration is 90 minutes as standard. Test button is remote to fixture. For more Battery options, see Pinnacle Resource Guide.

**Finish:** Standard powder-coat textured white, metallic silver, textured black, graphite or bronze painted finish; consult factory for chip of standard paint finishes. Canopies painted white unless specified differently in the options section of the part number. Contact factory for additional custom color and finish options.

**MR16:** Ideal for conference rooms, corridors, wall washing, retail spaces and training facilities where accent lighting is required. Fully enclosed compartment eliminates light from entering into our fixture areas. For LED and Halogen lamps (lamps are not included). Consult factory for other lamp types. Standard 60 watt max LED electronic transformer (120v or 277v), 50 watt max halogen lamp electronic transformer (120v or 277v), MR16 installed as an independent circuit. MR16 to match fixture voltage. 277v dimmer must be sourced. Consult factory for MR16 configurations. Pinnacle's MR16 applications are to be used with Soraa lamps with a maximum of 13 transformers on one circuit.

**Controls:** nLight Air rES7 sensor provides wireless control, daylight harvesting and occupancy detection with PIR or PDT using eldoLED LED drivers. nLight Air rIO module provides wireless control using eldoLED LED drivers. EasySense sensor provides daylight harvesting and PIR occupancy detection using the SR LED driver; the Philips app provides advanced configurations. ENCELIUM SensiLUM sensor provides wireless control, daylight harvesting and PIR occupancy; driver data is available when using the DEXAL driver. ENCELIUM SensiLUM sensor provides wireless control, daylight harvesting and PIR occupancy; driver data is available when using the DEXAL driver. WaveLinx Connected Lighting sensor provides wireless control and daylight harvesting using 0-10V LED drivers. Lutron Vive sensor provides wireless control, daylight harvesting and PIR occupancy detection using DEXAL or SR LED drivers. Lutron Vive module provides wireless control using DEXAL or SR LED drivers.

**Labels:** UL and cUL Listed. Standard and HO lumen packages are approved for dry/damp location unless otherwise noted.

**Fixture Weight:** Maximum fixture weight is 20 lbs. for a standard 4' fixture.

**Buy American Act Compliant**

**Warranty:** EX LED offered with a 5-year limited warranty. Covers LED, driver and fixture.