



P61 | Wet Listed, Surface & Wall



PRUDENTIAL LTG.

PRULITE.COM 213.746.0360



Type:

Job:

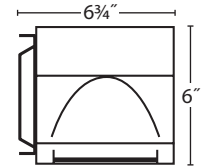

Wall Spacer

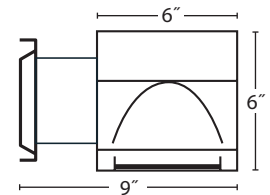

Wall Bracket

Multi-purpose outdoor lighting.

An IP65 rated aluminum 6" x 6" profile wet location luminaire ideal for exterior wall mounts, parking structures, commercial roll-up door applications. It features a one-piece extruded gasketed door frame.

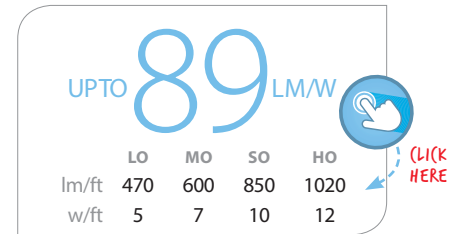
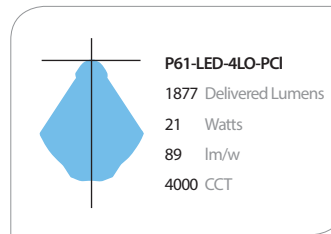

Lumen output may vary +/- 5%
4000K used for lm/ft estimates above
3500K -2% llf, 3000K -4%, 2700K -6%
-10% LLF for 90 CRI (4K, 3500K and 3K)
See LED Details PDF for more info

SERIES	LED COLOR	OUTPUT	NOMINAL LENGTH	SHIELDING	COLOR/ FINISH	DISTRI-BUTION	VOLTAGE	MOUNT-ING	DRIVERS	OPTIONS & CONTROLS
P61	LED27 2700K LED3 3000K LED35 3500K LED4 4000K LED3-90 90CRI LED35-90 90CRI LED4-90 90CRI	LO Low MO Medium SO Standard HO High PROG Programmable Light Output (Specify desired lm/ft or w/ft)	2' 3' 4' R (Row Length in 1' increments)	PCL Clear Polycarbonate Lens WA White Acrylic	TMW Textured Matte White YGW Gloss White (Standard) Y Premium Color CC Custom Color	D1 Direct D4W Asym-metric to Wall D4R Asym-metric to Room	347 UNV (120-277)	SUR Surface Mount to Ceiling (N/A - Vertical Mounting) WB Wall Bracket 3" WS Wall Spacer 3/4"	ND Non-Dimming DM10 0-10v, 10% Dimming (Standard) DM01 0-10v, 1% Dimming STEP Step Dimming, 100-50-Off, Osram NOTE: Lumens and watts per foot may differ for STEP drivers, consult factory LDE5 5%, Lutron (Ecosystem) LDE1 1%, Lutron (Soft Fade to Black, Ecosystem) L3DA 1%, Lutron, 3 Wire ECO 1% 0-10v, EldoLED ECDA 1% DALI, EldoLED SOLO 0.1% 0-10v, EldoLED (Dim to Dark) SODA 0.1% DALI, EldoLED (Dim to Dark)	EML Emergency Battery, Low (850 delivered lumens) EMH Emergency Battery, High (1175 delivered lumens) PRUBIN Meticulous Binning and Labeling Every LED Board within a 2-Step MacAdams Elipse



Prudential Ltg. reserves the right to change design specifications or materials without notice. Please visit prulite.com for most current data.
© 2014 All rights reserved - All products manufactured at: Prudential Ltg. 1774 E. 21st Street, Los Angeles, CA 90058

Wet Listed

1

11-01-2017



P61 | Wet Listed, Surface & Wall



PRUDENTIAL LTG.

PRULITE.COM 213.746.0360

PHOTOMETRICS

Low Output:

P61-LED-4-LO-PCI

1877 Delivered Lumens

21 Watts

89 lm/w

4000 CCT

LIGHT LABS TEST

#L01150801

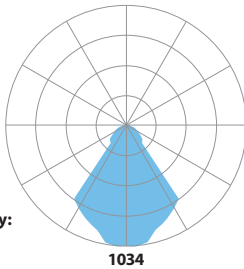

Zonal Lumen Summary:

0-90 = 100%

90-180 = 0%

Vertical Angle	0	25	45	65	90
0	1026	1026	1026	1026	1026
5	1022	1025	1033	1032	1034
15	993	1006	943	924	921
25	928	869	851	859	858
35	833	757	759	367	212
45	710	626	181	188	189
55	553	450	149	131	126
65	353	101	83	76	74
75	136	40	36	35	35
85	11	12	13	12	11
90	0	0	0	0	0

LUMEN MAINTENANCE

Designed to last with cool running mid-power LEDs projected to maintain 90% (L90) of their initial output for 100,000 hours (at HO), and L70 exceeding 150,000 hours.

LED SYSTEM

LED modules and drivers are field replaceable.

PROG

(OPTIONAL)

Programmable light output. Specify desired lumens or watts per linear foot. Min: 2.5 w/ft, consult factory for requests above 12 w/ft.

BINNING

Standard binning (all Prudential LED boards) includes testing at the chip level and board integration to provide consistent color temperature within a 3-step MacAdam ellipse, with +/- 5% lumen output range and +/- .004 Duv.

PRUBIN™

(OPTIONAL)

Prudential Ltg's exclusive 'job binning' method that ensures color temperature consistency across all luminaires on a project. Meticulously testing and labeling **EVERY LED BOARD** to +/- 25 lumens, +/- 50k CCT and +/- .004 Duv — while also separating positive from negative — allows us to match color, hue and intensity throughout a project and provides a consistent color temperature within a 2-step MacAdam ellipse.

LABELS

IP 65 Rated. U.L. labeled "Suitable for wet locations" and "Suitable for Mounting within 4-feet of the ground" and I.B.E.W. manufactured.

ELECTRICAL

Must specify LED dimming controls. LED fixtures have constant current driver(s) with less than 20% THD when loaded to a minimum of 60%. Drivers sink a maximum of 6mA per driver. DM10 LED drivers are 0-10V dimmable and are compatible with most 0-10V wall slide dimmers and direct 0-10V analog signal dimmers. Max driver size 1.7" w x 1.2" h.

CONSTRUCTION

Housing Die-formed aluminum >250% PC recycled, 100% recyclable.

Lens Clear or white acrylic, 100% recyclable.

MOUNTING

Surface mounted to walls or ceilings.

WARRANTY

Single-source, 5 year limited warranty covers standard components and construction.





NEW YSW – Seashell White (Matte)	NEW YCH – Champagne (Metallic)
YSL – Silver (Metallic)	YPE – Pewter (Matte)
YRG – Rain Grey (Gloss)	YSTM – Storm Grey (Matte)
NEW YBK – Black (Matte)	NEW YBB – Black (Semi Gloss)
YSKM – Sky (Matte)	NEW YMB – Military Blue (Matte)
NEW YIB – Interstate Blue (Matte)	YSAM – Sapphire (Matte)
NEW YFGM – Forest Green (Matte)	YBR – Bronze (Matte)
YBY – Boysenberry (Matte)	YSRM – Sunset Red (Matte)
NEW YOR – Orange (Matte)	YDAM – Daffodil (Matte)



MOUNTING LOCATIONS

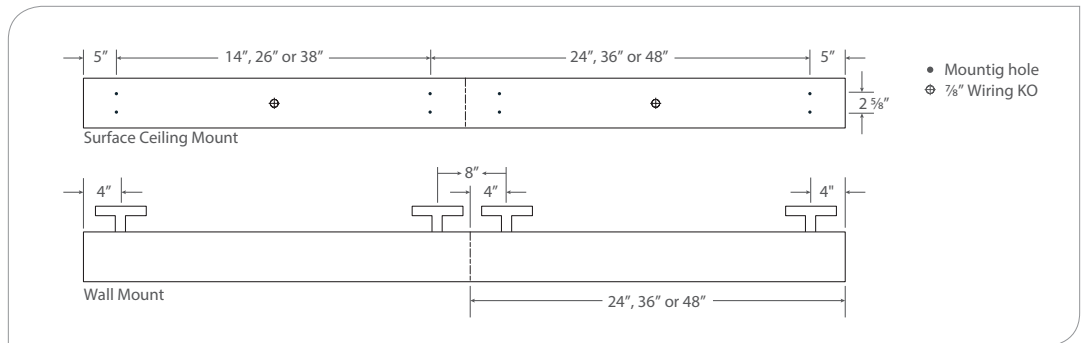

Choose from one of our Premium Colors with no set-up fee.

For paint chip samples, please e-mail: info@prulite.com

ADJOINING DETAIL

