

Placing emphasis where it belongs... Ledalite brings you the latest high performance lighting solution for your designer toolbox, **TruGroove perimeter** ambient and graze. Whether your desire is to set the mood or create a statement, **TruGroove** lets you emphasize with illumination.

Project: _____
 Location: _____
 Cat.No: _____
 Type: _____
 Line ID: _____ Qty: _____
 Notes: _____

Ordering guide – Standard

GET A QUOTE >

example: 4909LBEPSN067DE, C/C, 2S1

Family	Type	Source	CRI/CCT ¹	Lumens ¹	Optics	Housing	Ceiling/Trim	Run Length	Wiring ²
490		L			Q				
490 TruGroove Perimeter	8 Ambient	L LED	A 80CRI/4000K	D 4100 lm/4ft	Q Flush Meso Lens	S Standard C Chicago Plenum	N All Ceiling Trims	O2 2ft	7 1cct Dimming
			B 80CRI/3500K	E 3000 lm/4ft				C2 2.5ft	
			C 80CRI/3000K	G 2100 lm/4ft	P Reverse Parabolic Optic w/ Flush Lens			O3 3ft	N 1cct Dimming + Battery Pack
	9 Graze		K 1400 lm/4ft	O4 4ft					
				O5 5ft					
				O6 6ft					
								O8 8ft	
								xx Continuous Run + Odd lengths (please specify)	
Voltage	Driver	Endset (Left)		Endset (Right)		Slot Height	Slot Panel	Ceiling/Trim	
	E								
D UNV 120-277V	E Advance 0-10V (1% Dim)	C Variable/Wall	C Variable/Wall	2 1.75"	S Standard Solid	1 T-Grid			
3 347V		S Fixed/Pocket	S Fixed/Pocket	4 4"		3 Drywall Trimless			
				4 4"	A Air Return	4 Drywall Trim			
						1 T-Grid			

1. Nominal values within a range. Consult photometry data for CRI, color temp, lumens & distribution of chosen configuration.
 2. Not all wiring types are available with all configurations. Consult Ledalite for a complete list of available options.

TruGroove perimeter

Ordering guide - Connected systems

example: 4909L2EPSN067LP, C/C, 2S1

Family	Type	Source	CRI/CCT ¹	Lumens ¹	Optics	Housing	Ceiling/Trim	Run Length	Wiring ²
490		L			Q				
490 TruGroove Perimeter	8 Ambient	L LED	2 2-channel Tunable White 80CRI/2700-6500K	D 4100 lm/4ft E 3000 lm/4ft G 2100 lm/4ft K 1400 lm/4ft	Q Flush Meso Lens	S Standard	N All Ceiling Trims	02 2ft	7 1cct Dimming
	9 Graze							C2 2.5ft 03 3ft C3 3.5ft 04 4ft 05 5ft 06 6ft 08 8ft xx Continuous Run + Odd lengths (please specify)	
Voltage	Driver	Endset (Left)		Endset (Right)		Slot Height	Slot Panel	Ceiling/Trim	GET A QUOTE >
L Low Voltage (48-54V DC)	P PoE Lighting Controller	C Variable/Wall	S Fixed/Pocket	C Variable/Wall	S Fixed/Pocket	2 1.75" 4 4"	S Standard Solid	1 T-Grid 3 Drywall Trimless 4 Drywall Trim	
						4 4"	A Air Return	1 T-Grid	

Note: Options with the same color coding must be paired together.

- Nominal values within a range. Consult photometry data for CRI, color temp, lumens & distribution of chosen configuration.
- Not all wiring types are available with all configurations. Consult Ledalite for a complete list of available options.

Connected systems

Interact Office Wired (PoE), Tunable White

- PoE based IoT connected lighting solution for large enterprises that span across multiple floors, buildings and require multiple gateways.
- Use Interact Office software and insights to increase building efficiency, achieve building wide integration and optimize space through occupancy analytics.
- Human centric lighting through tunable white technology - Dynamic behaviors via scheduled lighting recipes mimicking daylight patterns or supporting biorhythms.
- Supports advanced IoT Apps on Personal Control, Space Management, wayfinding, room/desk reservation and offers open APIs for light control and data exchange.

www.interact-lighting.com/office or www.usa.lighting.philips.com/systems/system-areas/offices

Note: Signify Interact Office Luminaires are not sold individually and are only compatible with Signify's Interact Office control system & software. The system requires a compatible back-end IT infrastructure for normal operations, please consult your Signify representative for additional information.

TruGroove perimeter

Cross Section View

Corners (T-Grid shown)

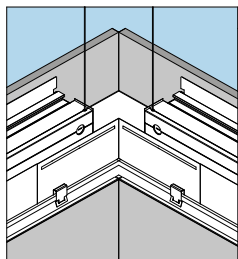

Inside Corner

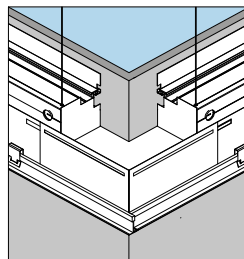

Outside Corner

Cross Section View – Endcaps

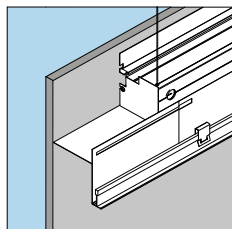

C Variable/Wall endplate

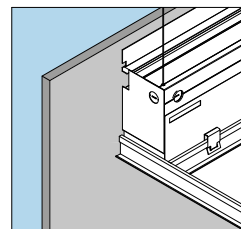

S Fixed/Pocket endplate

Ceiling Trims

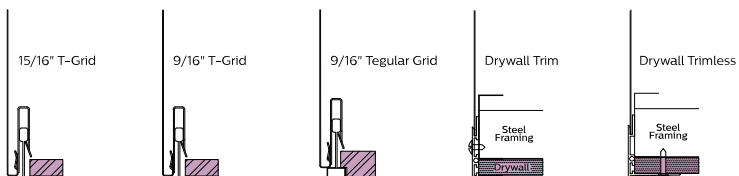

Module Details & Dimensions – Ambient

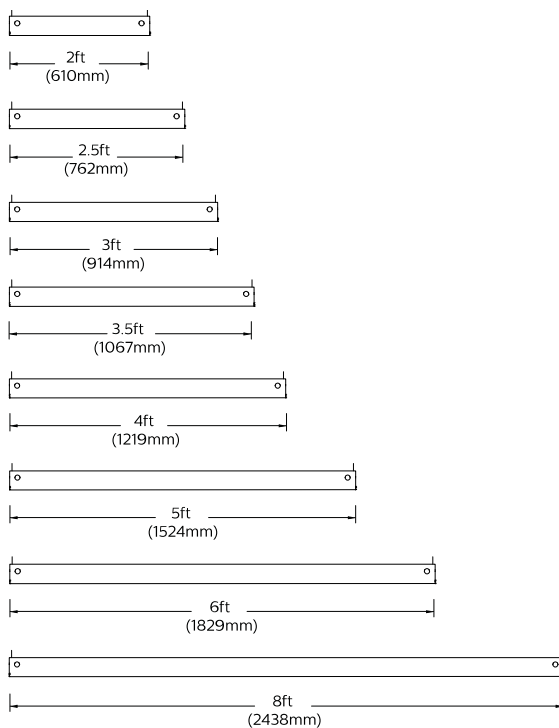
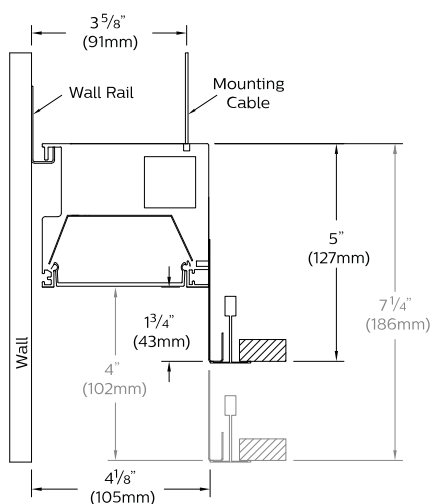

Side View

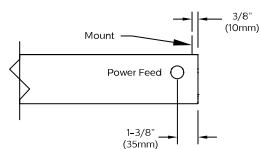

Top View

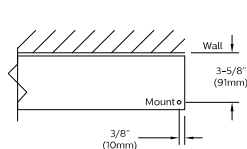

Power feed location available on room side 1-3/8" (35mm) from each joint or end condition.

TruGroove perimeter

Module Details & Dimensions – Graze

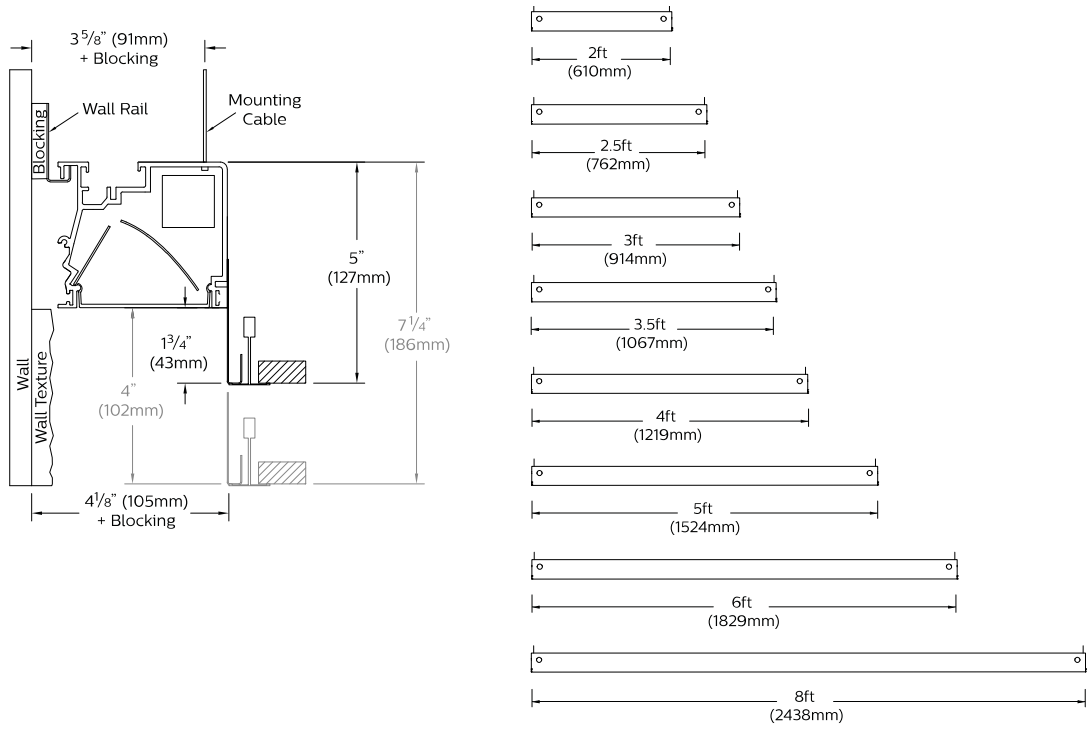

Side View

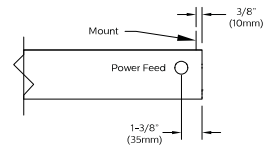

Top View

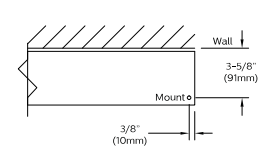

Power feed location available on room side 1-3/8" (35mm) from each joint or end condition.

TruGroove perimeter

Specifications

Optical System

Ambient: An extruded flush lens assembly with MesoOptics film is used to homogenize and control light from a linear array of downward-facing LEDs. This delivers a uniform, discreet ambient 'glow' along the top of a wall as well as directing fill light into the space. **Graze:** A highly efficient parabolic reflector mounted in the reverse orientation from the wall focuses light from an angled array of LEDs into a tight linear beam. This creates dramatic grazing shadow effects down the length of a textured wall with textures 1/16" - 1" deep.

Slot & Trim

Lit modules are regressed into a provided slot, 4" deep as standard or 1.75" deep for narrow plenums. The standard slot avoids direct view of the optics when standing 3' or more from a 9' wall. Slot panels are available to integrate with T-grid or drywall ceilings. The drywall edge can be finished with either a supplied visible extruded aluminum trim or a mud-in "trimless" flange.

Ends & Corners

The perimeter slot can be terminated at a chosen position with a flat / pocket end; or at a feature or wall with a variable length / wall end containing a sliding panel to close the plenum. All corners are variable length, with sliding panels and trimmable covers, available in 90° inside or outside versions. Other angles may be handled by request.

Housing

Precision aluminum extrusion, powder coated in white (Ambient) or black (Graze).

Weight

Maximum: Ambient 3.6lb/ft, Graze 3.8lb/ft

Electrical

Factory pre-wired to section ends with quick-wire connectors.

Standard Driver

Advance Xitanium 0-10V, 1% dimming.

PoE Lighting Controller (for PoE or tunable white)

Class 2 rated output. Consult Ledalite for other available drivers.

Standard Battery Pack

Bodine Battery Pack, 90 min, 10W, Class 2 rated output.

Lumen output = 10W x luminaire efficacy x 1.1. Typical output 1100lm.

PoE Battery Pack, 90 min, 6W, Class2 rated output.

Lumen output = 6W x luminaire efficacy. Typical output 650lm.

Lumen Maintenance

LEDs have been tested by the manufacturer in accordance with IESNA LM-80-08. At an ambient temperature of 25°C, the LED lumen maintenance expectation according to IES TM-21-11 Reported methodology is: L80 (10k) >60,000 hrs.

Source Color

LEDs rated for color rendering of:

CRI >80 & R9 >0

CRI >90 & R9>50

Fixture to fixture color accuracy within:

2 SDCM for Static White luminaires

3 SDCM for Tunable White luminaires

Mounting

Modules are supported on the wall side by a hidden extruded aluminum rail. On the ceiling side, support and final height adjustment are provided by an aircraft cable and gripper system attached to a bracket on the ceiling structure. Slot panels for closing the plenum are attached using either clips in the case of T-grid ceiling, or a screw mounted finishing trim for drywall.

Joints

Self-aligning joining system with hands-free pre-joining wire access.

Approvals

Certified to UL, CSA and IES standards.

Quick Ship

Available for most non-connected configurations upon request. More information available at: www.signify.com/en-us/brands/ledalite/quickship

Warranty

Signify indoor professional luminaires 5 year LED warranty

www.signify.com/warranties

Environment

Rated for dry or damp locations in operating ambient temperatures 0-40°C (32-104°F). Certain luminaire components may be adversely affected by contaminants. Damage caused by sulfur, chlorine, petroleum based solutions or other contaminants in the area of operation are not covered under warranty. Not suitable for natatorium environments.

TruGroove perimeter

Photometrics

Ambient - Flush Meso Lens (4908)

(Click "IES" text to Download)

Lumen Package	Nominal CRI & CCT	Flux (lm)	Watts (W)	Efficacy (LPW)	CRI	R9	RP-1 VDT	Photometry Report	IES File
4100lm/4ft	80CRI, 4000K	4233	39.4	107.4	84	10	N/A	PDF	IES
	80CRI, 3500K	4199	39.7	105.8	82	4	N/A	PDF	IES
	80CRI, 3000K	4007	39.1	102.5	85	15	N/A	PDF	IES
3000 lm/4ft	80CRI, 4000K	3102	27.7	112.0	84	10	Normal spaces	PDF	IES
	80CRI, 3500K	3077	27.9	110.3	82	4	Normal spaces	PDF	IES
	80CRI, 3000K	2937	27.5	106.8	85	15	Normal spaces	PDF	IES
2100 lm/4ft	80CRI, 4000K	2192	19.1	114.8	84	10	Normal spaces	PDF	IES
	80CRI, 3500K	2175	19.3	112.7	82	4	Normal spaces	PDF	IES
	80CRI, 3000K	2076	19.0	109.3	85	15	Critical spaces	PDF	IES
1400 lm/4ft	80CRI, 4000K	1460	13.1	111.5	84	10	Critical spaces	PDF	IES
	80CRI, 3500K	1448	13.2	109.7	82	4	Critical spaces	PDF	IES
	80CRI, 3000K	1382	13.0	106.3	85	15	Critical spaces	PDF	IES

CANDELA DISTRIBUTION						Flux
	0	22.5	45	67.5	90	Lumens
0	1189	1189	1189	1189	1189	
5	1193	1187	1171	1180	1189	112
15	1125	1138	1120	1107	1108	314
25	922	981	995	923	892	432
35	608	683	721	624	589	415
45	413	466	488	423	401	346
55	277	307	315	279	270	264
65	169	189	191	168	167	178
75	80	93	90	77	81	91
85	17	23	19	15	20	23
90	0	0	0	0	0	
95	0	0	0	0	0	0
105	0	0	0	0	0	0
115	0	0	0	0	0	0
125	0	0	0	0	0	0
135	0	0	0	0	0	0
145	0	0	0	0	0	0
155	0	0	0	0	0	0
165	0	0	0	0	0	0
175	0	0	0	0	0	0
180	0	0	0	0	0	0

*Photometric data shown is for 2100 lm/4ft, 3500K, 80 CRI configuration.

COEFFICIENTS OF UTILIZATION (%)													
Pc---	80				70				50				0
Pw---	70	50	30	10	70	50	30	50	30	10	0	0	
RCR	0	119	119	119	116	116	116	111	111	111	100		
	1	110	106	103	99	108	104	101	100	97	95	87	
	2	102	95	89	84	99	93	87	89	85	81	75	
	3	94	85	78	72	92	83	77	80	75	70	66	
	4	87	76	69	63	85	75	68	73	66	61	58	
	5	81	69	61	55	79	68	61	66	59	54	51	
	6	75	63	55	49	73	62	55	61	54	49	46	
	7	70	58	50	44	69	57	50	56	49	44	42	
	8	66	53	46	40	64	53	45	52	45	40	38	
	9	62	50	42	37	61	49	42	48	41	37	35	
	10	58	46	39	34	57	46	39	45	38	34	32	

ZONAL LUMEN SUMMARY			
Zone	Lumens	%Fixture	%Lamp
0-30	858	39.5%	39.5%
0-40	1273	58.5%	58.5%
0-60	1883	86.6%	86.6%
0-90	2175	100.0%	100.0%
90-130	0	0.0%	0.0%
90-150	0	0.0%	0.0%
90-180	0	0.0%	0.0%
0-180	2175	100.0%	100.0%

Electrical				
Voltage (V)	Power (W)	Current (A)	THD (%)	Power factor
120	19.3	0.167	14.4	0.964
277	19.2	0.070	8.9	0.995
347	N/A	N/A	N/A	N/A

AVG LUMINANCE (cd/m²)			
	0	45	90
0	12789	12789	12789
5	12883	12643	12844
15	12535	12475	12346
25	10944	11809	10587
35	7989	9474	7736
45	6281	7421	6109
55	5204	5903	5063
65	4302	4864	4245
75	3322	3722	3384
85	2095	2374	2448

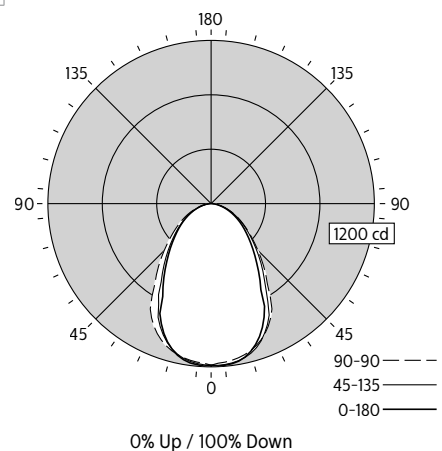

TruGroove perimeter

Photometrics

Graze - Reverse Parabolic Optic (4909)

(Click "IES" text to Download)

Lumen Package	Nominal CRI & CCT	Flux (lm)	Watts (W)	Efficacy (LPW)	CRI	R9	RP-1 VDT	Photometry Report	IES File
4100lm/4ft	80CRI, 4000K	4157	39.4	105.5	84	10	N/A	PDF	IES
	80CRI, 3500K	4125	39.7	103.9	82	4	N/A	PDF	IES
	80CRI, 3000K	3936	39.1	100.7	85	15	N/A	PDF	IES
3000 lm/4ft	80CRI, 4000K	3047	27.7	110.0	84	10	N/A	PDF	IES
	80CRI, 3500K	3023	27.9	108.4	82	4	N/A	PDF	IES
	80CRI, 3000K	2884	27.5	104.9	85	15	N/A	PDF	IES
2100 lm/4ft	80CRI, 4000K	2154	19.1	112.8	84	10	N/A	PDF	IES
	80CRI, 3500K	2136	19.3	110.7	82	4	N/A	PDF	IES
	80CRI, 3000K	2039	19.0	107.3	85	15	N/A	PDF	IES
1400 lm/4ft	80CRI, 4000K	1433	13.1	109.4	84	10	N/A	PDF	IES
	80CRI, 3500K	1422	13.2	107.7	82	4	N/A	PDF	IES
	80CRI, 3000K	1357	13.0	104.4	85	15	Normal spaces	PDF	IES

CANDELA DISTRIBUTION						Flux
	0	22.5	45	67.5	90	Lumens
0	4643	4643	4643	4643	4643	
5	3359	3921	4612	3927	3282	332
15	467	1147	4305	1048	452	482
25	99	269	3711	283	143	414
35	54	99	2912	131	79	346
45	28	55	1991	74	44	264
55	19	35	1114	44	24	171
65	14	25	458	27	13	87
75	8	14	129	14	6	34
85	2	3	16	3	2	7
90	0	0	0	0	0	
95	0	0	0	0	0	0
105	0	0	0	0	0	0
115	0	0	0	0	0	0
125	0	0	0	0	0	0
135	0	0	0	0	0	0
145	0	0	0	0	0	0
155	0	0	0	0	0	0
165	0	0	0	0	0	0
175	0	0	0	0	0	0
180	0	0	0	0	0	0

COEFFICIENTS OF UTILIZATION (%)													
Pc---	80				70				50				0
Pw---	70	50	30	10	70	50	30	50	30	10	0	0	
RCR													
0	119	119	119	119	116	116	116	111	111	111	100		
1	112	109	106	104	110	107	104	103	101	99	91		
2	106	100	95	91	103	98	94	95	91	88	83		
3	99	92	86	81	97	90	85	88	83	79	75		
4	94	85	79	74	92	84	78	81	76	72	69		
5	88	79	72	67	87	78	72	76	71	66	64		
6	84	74	67	62	82	73	66	71	66	61	59		
7	79	69	62	58	78	68	62	67	61	57	55		
8	75	65	58	54	74	64	58	63	58	54	52		
9	72	61	55	51	71	61	55	60	54	50	49		
10	68	58	52	48	67	58	52	57	51	48	46		

AVG LUMINANCE (cd/m ²)			
	0	45	90
0	48942	48942	48942
5	35540	48796	34724
15	5101	46976	4929
25	1153	43165	1666
35	689	37469	1013
45	422	29680	657
55	347	20479	434
65	353	11424	314
75	321	5256	256
85	190	1904	190

ZONAL LUMEN SUMMARY			
Zone	Lumens	%Fixture	%Lamp
0-30	1228	57.5%	57.5%
0-40	1574	73.7%	73.7%
0-60	2009	94.0%	94.0%
0-90	2136	100.0%	100.0%
90-130	0	0.0%	0.0%
90-150	0	0.0%	0.0%
90-180	0	0.0%	0.0%
0-180	2136	100.0%	100.0%

Electrical				
Voltage (V)	Power (W)	Current (A)	THD (%)	Power factor
120	19.3	0.167	14.4	0.964
277	19.2	0.070	8.9	0.995
347	N/A	N/A	N/A	N/A

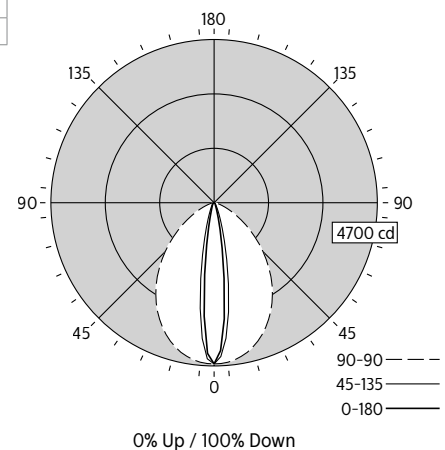

*Photometric data shown is for 2100 lm/4ft, 3500K, 80 CRI configuration.

TruGroove perimeter w/tunable white

Photometrics

Ambient - Flush Meso Lens (4908)

(Click "IES" text to Download)

Lumen Package	Nominal CRI & CCT	Flux (lm)	Power (W)	Efficacy (LPW)	CRI	R9	RP-1 VDT	Photometry Report	IES File
4100lm/4ft	80CRI, 2700K	4111	45.7	89.9	82	8	N/A	PDF	IES
	80CRI, 3000K	4113	44.7	91.9	84	14	N/A		
	80CRI, 3500K	4115	43.3	95.0	86	23	N/A		
	80CRI, 4000K	4117	42.1	97.8	87	28	N/A		
	80CRI, 5000K	4120	40.3	102.1	87	26	N/A		
	80CRI, 6500K	4123	38.1	108.1	84	13	N/A		
3000 lm/4ft	80CRI, 2700K	3009	30.4	98.9	82	8	Normal spaces	PDF	IES
	80CRI, 3000K	3008	30.0	100.4	84	14	Normal spaces		
	80CRI, 3500K	3006	29.3	102.7	86	23	Normal spaces		
	80CRI, 4000K	3005	28.7	104.7	87	28	Normal spaces		
	80CRI, 5000K	3003	27.9	107.7	87	26	Normal spaces		
	80CRI, 6500K	3000	26.9	111.7	84	13	Normal spaces		
2100 lm/4ft	80CRI, 2700K	2118	20.7	102.3	83	9	Normal spaces	PDF	IES
	80CRI, 3000K	2116	20.5	103.3	84	16	Normal spaces		
	80CRI, 3500K	2113	20.1	104.9	86	24	Normal spaces		
	80CRI, 4000K	2110	19.9	106.2	87	28	Normal spaces		
	80CRI, 5000K	2106	19.5	108.1	87	27	Normal spaces		
	80CRI, 6500K	2101	19.0	110.7	84	12	Normal spaces		
1400 lm/4ft	80CRI, 2700K	1408	13.5	104.4	83	10	Critical spaces	PDF	IES
	80CRI, 3000K	1412	13.4	105.5	85	17	Critical spaces		
	80CRI, 3500K	1417	13.2	107.0	87	25	Critical spaces		
	80CRI, 4000K	1422	13.1	108.3	87	29	Critical spaces		
	80CRI, 5000K	1429	13.0	110.3	87	27	Critical spaces		
	80CRI, 6500K	1437	12.7	112.8	84	11	Critical spaces		

CANDELA DISTRIBUTION						Flux
	0	22.5	45	67.5	90	Lumens
0	1142	1142	1142	1142	1142	
5	1133	1134	1131	1132	1131	108
15	1055	1064	1073	1057	1036	299
25	813	893	923	882	820	409
35	571	646	716	635	573	408
45	390	443	476	426	388	345
55	273	289	308	278	262	263
65	166	178	183	167	154	176
75	77	82	86	75	69	89
85	18	16	15	13	12	21
90	0	0	0	0	0	
95	0	0	0	0	0	0
105	0	0	0	0	0	0
115	0	0	0	0	0	0
125	0	0	0	0	0	0
135	0	0	0	0	0	0
145	0	0	0	0	0	0
155	0	0	0	0	0	0
165	0	0	0	0	0	0
175	0	0	0	0	0	0
180	0	0	0	0	0	

*Photometric data shown is for 2100 lm/4ft, 2700K, 80 CRI configuration.

COEFFICIENTS OF UTILIZATION (%)													
Pc---	80				70				50				0
Pw---	70	50	30	10	70	50	30	50	30	10	0	0	
RCR	0	119	119	119	116	116	116	111	111	111	100	100	
1	110	106	103	99	108	104	101	100	97	95	87	87	
2	102	95	89	84	99	93	87	89	85	81	75	75	
3	94	85	77	72	91	83	76	80	74	70	65	65	
4	87	76	68	62	85	75	67	72	66	61	57	57	
5	81	69	61	55	79	68	60	66	59	54	51	51	
6	75	63	55	49	73	62	54	60	53	48	46	46	
7	70	58	50	44	68	57	49	55	49	44	41	41	
8	66	53	45	40	64	52	45	51	44	40	37	37	
9	62	49	42	36	60	49	41	47	41	36	34	34	
10	58	46	38	33	57	45	38	44	38	33	31	31	

ZONAL LUMEN SUMMARY			
Zone	Lumens	%Fixture	%Lamp
0-30	815	38.5%	38.5%
0-40	1223	57.8%	57.8%
0-60	1831	86.5%	86.5%
0-90	2117	100.0%	100.0%
90-130	0	0.0%	0.0%
90-150	0	0.0%	0.0%
90-180	0	0.0%	0.0%
0-180	2117	100.0%	100.0%

Electrical		
Voltage (VDC)	Power (W)	Current (A)
48-54	20.7	0.370

AVG LUMINANCE (cd/m ²)			
	0	45	90
0	12283	12283	12283
5	12237	12218	12213
15	11757	11955	11543
25	9652	10956	9737
35	7506	9404	7524
45	5935	7242	5904
55	5127	5784	4907
65	4237	4647	3921
75	3218	3592	2848
85	2198	1877	1420

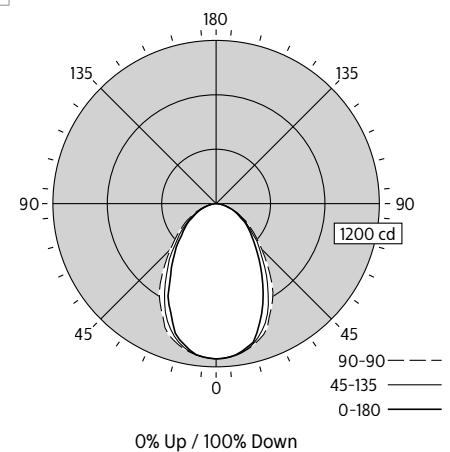

TruGroove perimeter

Photometrics

Graze - Reverse Parabolic Optic (4909)

(Click "IES" text to Download)

Lumen Package	Nominal CRI & CCT	Flux (lm)	Power (W)	Efficacy (LPW)	CRI	R9	RP-1 VDT	Photometry Report	IES File
4100lm/4ft	80CRI, 2700K	4038	45.7	88.3	82	8	N/A	PDF	IES
	80CRI, 3000K	4040	44.7	90.3	84	14	N/A		
	80CRI, 3500K	4042	43.3	93.3	86	23	N/A		
	80CRI, 4000K	4044	42.1	96.1	87	28	N/A		
	80CRI, 5000K	4047	40.3	100.3	87	26	N/A		
3000 lm/4ft	80CRI, 2700K	2956	30.4	97.2	82	8	N/A	PDF	IES
	80CRI, 3000K	2955	30.0	98.6	84	14	N/A		
	80CRI, 3500K	2953	29.3	100.9	86	23	N/A		
	80CRI, 4000K	2952	28.7	102.8	87	28	N/A		
	80CRI, 5000K	2950	27.9	105.8	87	26	N/A		
2100 lm/4ft	80CRI, 2700K	2081	20.7	100.6	83	9	N/A	PDF	IES
	80CRI, 3000K	2079	20.5	101.5	84	16	N/A		
	80CRI, 3500K	2076	20.1	103.0	86	24	N/A		
	80CRI, 4000K	2073	19.9	104.3	87	28	N/A		
	80CRI, 5000K	2069	19.5	106.2	87	27	N/A		
1400 lm/4ft	80CRI, 2700K	1383	13.5	102.6	83	10	Normal spaces	PDF	IES
	80CRI, 3000K	1387	13.4	103.6	85	17	Normal spaces		
	80CRI, 3500K	1392	13.2	105.1	87	25	Normal spaces		
	80CRI, 4000K	1397	13.1	106.4	87	29	Normal spaces		
	80CRI, 5000K	1404	13.0	108.3	87	27	Normal spaces		
80CRI, 6500K	1412	12.7	110.8	84	11	Normal spaces			

CANDELA DISTRIBUTION						Flux
	0	22.5	45	67.5	90	Lumens
0	4525	4525	4525	4525	4525	
5	3274	3821	4495	3827	3198	323
15	456	1118	4196	1022	440	470
25	97	262	3617	276	140	404
35	52	97	2838	127	77	337
45	28	54	1941	72	43	258
55	18	34	1086	43	23	166
65	14	25	446	26	12	85
75	8	14	126	14	6	33
85	2	3	15	3	2	6
90	0	0	0	0	0	
95	0	0	0	0	0	0
105	0	0	0	0	0	0
115	0	0	0	0	0	0
125	0	0	0	0	0	0
135	0	0	0	0	0	0
145	0	0	0	0	0	0
155	0	0	0	0	0	0
165	0	0	0	0	0	0
175	0	0	0	0	0	0
180	0	0	0	0	0	0

COEFFICIENTS OF UTILIZATION (%)													
Pc---	80				70				50				0
Pw---	70	50	30	10	70	50	30	50	30	10	0	0	
RCR	0	119	119	119	119	116	116	116	111	111	111	100	
	1	112	109	106	104	110	107	104	103	101	99	91	
	2	106	100	95	91	103	98	94	95	91	88	83	
	3	99	92	86	81	97	90	85	88	83	79	75	
	4	94	85	79	74	92	84	78	81	76	72	69	
	5	88	79	72	67	87	78	72	76	71	66	64	
	6	84	74	67	62	82	73	66	71	66	61	59	
	7	79	69	62	58	78	68	62	67	61	57	55	
	8	75	65	58	54	74	64	58	63	58	54	52	
	9	72	61	55	51	71	61	55	60	54	50	49	
	10	68	58	52	48	67	58	52	57	51	48	46	

ZONAL LUMEN SUMMARY			
Zone	Lumens	%Fixture	%Lamp
0-30	1196	57.5%	57.5%
0-40	1534	73.7%	73.7%
0-60	1958	94.0%	94.0%
0-90	2082	100.0%	100.0%
90-130	0	0.0%	0.0%
90-150	0	0.0%	0.0%
90-180	0	0.0%	0.0%
0-180	2082	100.0%	100.0%

Electrical		
Voltage (VDC)	Power (W)	Current (A)
48-54	20.7	0.370

AVG LUMINANCE (cd/m ²)			
	0	45	90
0	48692	48692	48692
5	35358	48547	34546
15	5075	46736	4905
25	1147	42945	1657
35	686	37277	1007
45	420	29528	654
55	345	20375	431
65	351	11365	313
75	320	5230	254
85	185	1889	185

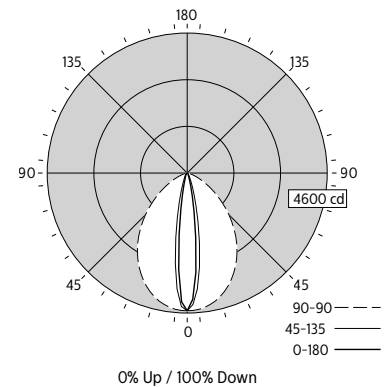

*Photometric data shown is for 2100 lm/4ft, 2700K, 80 CRI configuration.

The information presented in this document is not intended as any commercial offer and does not form part of any quotation or contract.

