

FIXTURE SPECIFICATIONS

INTENDED USE

The Ashton Architectural LED Pendant Lighting Direct/Indirect Light Fixture delivers continuous clean lines and clear light to commercial, hospitality and residential interior lighting applications. Our modern, slim profiles and stylish linear chandelier designs offer excellent direct and indirect lighting and exceptional performance and versatility in offices, classrooms, conference rooms, museums, retail outlets, hotels, restaurants, and more. The integrated LED is available in standard lengths of 4', 8', and 12', and can be joined together in seamless runs of any length.

FEATURES

- Construction:** Die-Formed 20 Gauge Cold-Rolled Steel (Flat End Steel Plate Standard Die-Cast Aluminum Decorative End Cap Optional)
- Continuous Row:** Full Ability to Tandem Mount for Continuous Run Application, Equipped with Male & Female Quick Connect Harnesses
- Light Distribution:** 6% Down / 94% Up
- Reflector:** Die-Formed, High-Reflective
- Lens:** Semi-Specular Aluminum Louver
- Electrical:** Constant Current, Class 2
- Voltage:** 120-277V (347V and 480V Available for Canadian Projects, Consult Factory)
- CRI:** 80+ (90+ available, Consult Factory)
- Power Factor:** > .9
- Life:** 60,000 Hours L70
- Operating Temperature:** -22°F (-30°C) - 122°F (50°C)
- Emergency Lumens:** System Lumens x Emergency Wattage / System Wattage
- Warranty:** 5 Years Carefree for Parts & Components (Labor Not Included)
- Listings:** UL Listed for Dry & Damp Location



DEC - Shown without Decorative End Cap

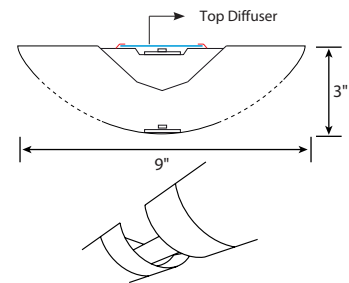

A non-lit continuous coupler is provided for continuous runs with decorative end caps

ORDERING INFORMATION Example: (12106-60W-30K-WH-010-AC48)

Model	Length Wattage Lumens	Color Temp	CRI	Finish	Pendant Mounting	Dimming	Options	Optional Controls
12106	2-30 2FT 30W 4144 lms	30K 3000K	8 Standard 80+ CRI	WH Standard White	AC4 4' Adjustable Aircraft Cable	010 Standard 0-10V 1%	Blank No Options	Blank No Controls
	2-36 2FT 36W 4332 lms	35K 3500K	9 90+ CRI	BK Black	AC8 8' Adjustable Aircraft Cable	TRI TRIAC (120V)	EM5 5W Emergency Ballast	LV Lutron
	2-36 2FT 40W 4884 lms	40K 4000K		SL Silver	ACX Specify X in Feet (Max 30')	ELV Electronic Low Voltage	EM8 8W Emergency Ballast	VIVE™ Wireless
	3-45 3FT 45W 6213 lms	50K 5000K		XXXX Specify XXXX: Use RAL # found on Page 2		ES566 eldoLED 0-10V SOLOdrive	EM16 16W Emergency Ballast	PH Philips EasySense™
	3-54 3FT 54W 6489 lms					BLS Bi-Level Step 40/100%	OS Occupancy Sensor w/ Daylight Harvesting	EN Siemens Enlightened™
	3-60 3FT 60W 7320 lms					BLSxxx Bi-Level Step xxx /100%	DS Daylight Dimming Photo Sensor	
	4-23 4FT 23W 3052 lms					TLS Tri-Level Step 30/70/100%	AB Separate Dimming Control of Uplight and Downlight	
	4-60 4FT 60W 8288 lms					TLSxxxzzz Tri-Level Step xxxzzz /100%	EC¹ Decorative End Cap 1.5" Width	
	4-72 4FT 72W 8664 lms						ILD Indirect Light Diffuser for Close to Ceiling Applications	
	4-81 4FT 81W 9768 lms							
	8-120 8FT 120W 16568 lms							
	8-144 8FT 144W 17312 lms							
	8-162 8FT 162W 19528 lms							
	12-180¹ 12FT 180W 24828 lms							
	12-216¹ 12FT 216W 25980 lms							
	12-243¹ 12FT 243W 29304 lms							

¹ A non-lit continuous coupler is provided for continuous runs with decorative end caps



Alcon Lighting 12106 Ashton Architectural LED Linear Pendant Mount Direct Down Light

Available Finishes

Standard

	Matte White	RAL #9003
--	-------------	-----------

Set up fee and longer lead time will be applied on non-standard finishes.





Metropolitan

	Black	RAL #9011
	Silver	RAL #9022
	Urban Native	RAL #8025
	Military Green	RAL #6011
	Carmin	RAL #8028
	Chocolate Spice	RAL #8017
	Asher Grey	RAL #7004
	Tech Grey	RAL #7016
	Slate	RAL #7031
	Mason	RAL #7039

Vibrant

	Violet Dreams	RAL #4006
	Sangria Sunset	RAL #2004
	Deep Pink	RAL #4010
	Ruby Red	RAL #3027
	Island Skye	RAL #6027
	Sophia	RAL #5015
	Antique Spring	RAL #6019
	Daisy	RAL #1018
	Gun Metal	RAL #7024

Controls

Smart Sensors	Protocol	Compatible Networks	Occupancy	Daylight	Temperature Reporting	Communication to Luminaire
	Enlighted RF	Enlighted RF	Integrated	Integrated	Yes	Wireless
	EcoSystem	Quantum, Energi Savr Node, Energi TriPak	Enabled	Enabled	No	Wired
	Lutron Clear Connect*	Lutron Vive System Network	Enabled	Enabled	No	Wireless
	ZigBee HA	Philips	Enabled	Enabled	No	Wired

Controls



Controls Installed on the Fixture



FCJS-010
Individual
Fixture Control

Fixture Will be Shipped LUTRON VIVE Enabled with LUTRON FCJS-010 0-10V Control Module Installed on the Fixture. Fixtures will be compatible with Lutron FC-SENSOR Occupancy/Daylight Sensor or FC-VSENSOR Vacancy/Daylight Sensor which can be Added in the Field for Remote Mounting. Fixture May be Controlled with any Vive control systems. Fixtures must be ordered with a 0-10V. Driver.



FCJS-ECO
Individual
Fixture Control

Fixture Will be Shipped LUTRON VIVE Enabled with LUTRON FCJS-ECO EcoSystem Control Module Control Module Installed on the Fixture. Fixtures will be compatible with Lutron FC-SENSOR Occupancy/Daylight Sensor or FC-VSENSOR Vacancy/Daylight Sensor which can be Added in the Field for Remote Mounting. Fixture May be Controlled with any Vive control systems. Fixtures must be ordered with a Lutron Driver.

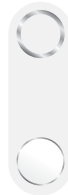

DFCSJ-OEM-OCC

Fixture Will be Shipped LUTRON VIVE Enabled with DFCSJ-OEM-OCC* Vive Integral Fixture Control (with Sensing) Installed on the Fixture. Fixture May be Controlled with any Vive control systems. Fixtures must be ordered with a DMX or Lutron EcoSystem Driver

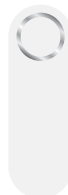

DFCSJ-OEM-RF

Fixture Will be Shipped LUTRON VIVE Enabled with LUTRON DFCSJ-OEM-RF* Vive Integral Fixture Control (RF Only) Installed on the Fixture. Fixture May be Controlled with any Vive control systems. Fixtures must be ordered with a DMX or Lutron EcoSystem Driver.

Controls Provided by Lutron



Vive Wireless Hub



DayLight
Sensor



Ceiling Mount
Occupancy/Daylight
Sensor



Ceiling Mount
Occupancy Sensor



Pico
Remote



Wall Mount
Switch



Wall Mount
Occupancy Sensor



Lutron App



Fixture will be shipped with Leviton ZL027-N0W power control module installed on the fixture. Fixtures will be compatible with Leviton ZL00J-D0W sensor control module which can be added in the field for remote mounting. Fixture must be controlled with Leviton Intellect Keypad Room Controller, or Leviton Neuron App.



ZL027-N0W
Power control module



ZL00J-D0W
Sensor control module

Leviton Keypad



ZLDNK-1W



ZLDNK-2W



ZLDNK-4W



ZLDNK-8W

Intellect™ Keypad Room
Controller (Required)

Leviton App



Neuron App

Controls



Philips EasySense sensors provide luminaire-level control with Occupancy sensing, Daylight harvesting, and Field task tuning.

Controls Installed on the Fixture



PHILIPS-XSR + SNS200

Fixture will be Shipped with EasySense SNS200 Sensor installed and PHILIPS-XSR driver. Fixture May Only be Controlled with Philips Field App or Wireless Switches.



SRB + SNS200

Fixture Will be Shipped with EasySense SNS200 Sensor installed and PHILIPS SRB Bridge. Fixture May Only be Controlled with Philips Field App or Wireless Switches or any 0-10V. Wall Box Dimmer.



Controls Provided by Philips



ZBT-S1AWH



ZBT-S2AWH

Illumra Wireless Switches



PHILIPS-XSR + SNS200-CMP

Fixture will be Shipped Sensor Ready with PHILIPS-XSR driver and EasySense SNS200-CMP Sensor which is Included to be Remote Mounted. Fixture May Only be Controlled with Philips Field App or Wireless Switches



SRB + SNS200-CMP

Fixture Will be Shipped Sensor Ready with PHILIPS SRB Bridge and EasySense SNS200-CMP Sensor which is Included to be Remote Mounted. Fixture May Only be Controlled with Philips Field App or Wireless Switches or any 0-10V. Wall Box Dimmer.





SRB

Fixture will be Shipped Sensor Ready with SRB Bridge. Fixture will be Compatible with EasySense Sensor SNS200-CMP which can be Added in the Field for Remote Mounting. Fixture May Only be Controlled with Philips Field App or Wireless Switches or any 0-10V. Wall Box Dimmer.



Philips Field App

Compatible Dimmers

MFG	Triac	ELV	0-10
	TG-600P	DVELV-303P	NTSTV
	LG-600P	SELV-300P	NFTV
	TGCL-153P	MAELV-600	DVSTV
	DV-600P	FAELV-500	
	DVCL-153P		
	S-603PG		
	CT-103P		
S-600P			
	6161	IPE04	IP710-DLZ
	6633-P	VPE06-1LZ	
	6683		
	6631-2		
	IPI06-1LZ		

COLOR TEMPERATURE GUIDE



2700K	3000K	3500K	4000K	5000K
WARM WHITE	SOFT WHITE GLOW	NEUTRAL GLOW	DAYLIGHT GLOW	CRYSTAL WHITE GLOW
friendly personal intimate	soft warm pleasing	sociable inviting non-threatening	neat clean efficient	bright cool alert
HOMES LIBRARIES RESTAURANTS	HOMES HOTEL ROOMS LOBBIES RETAIL STORES	EXECUTIVE OFFICES RECEPTION AREAS SUPERMARKETS	OFFICES CLASSROOMS MASS MERCHANDISERS SHOWROOMS	GRAPHICS INDUSTRY HOSPITALS GALLERIES BEAUTY SALONS

Pendant Installation

A simple design and adjustable components provide a flexible and hassle-free experience when installing the Continuum Series™.

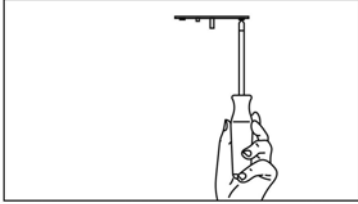

Step 1: Secure cross brackets to junction boxes for both power and non power mounting points.

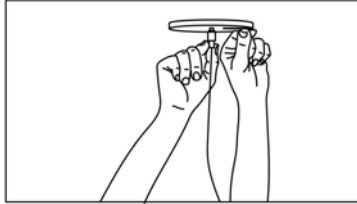

Step 2: Secure canopy with power canopy coupler (Power Feed Mount) & secure canopy with cable terminal (Non Power Feed Mount).

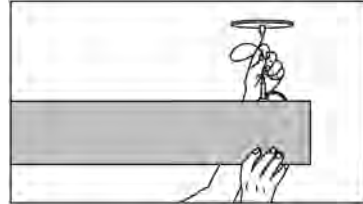

Step 3: Feed aircraft cable into cable grippers, adjust height and level luminaire.

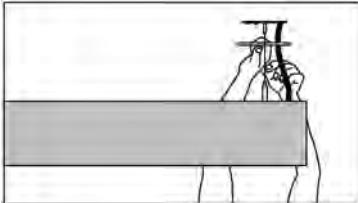

Step 4: Unscrew outer coupler to allow access to junction box. Feed power cord through canopy.



Step 5: Secure canopy back in place with outer coupler.

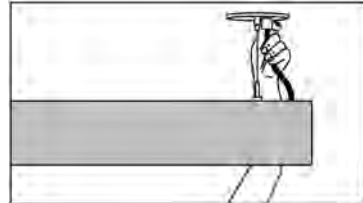

Step 6: Snap strain relief around power cord. Press into canopy.