

FIXTURE SPECIFICATIONS

INTENDED USE

The Casablanca Architectural LED Linear Pendant Lighting Direct/Indirect Light Fixture delivers continuous clean lines and clear light to commercial, hospitality and residential interior lighting applications. Our modern, slim profiles and stylish linear chandelier designs offer excellent direct and indirect lighting and exceptional performance and versatility in offices, classrooms, conference rooms, museums, retail outlets, hotels, restaurants, and more. The integrated LED is available in standard lengths of 4', 8', and 12', and can be joined together in seamless runs of any length.

FEATURES

- Construction:** Die-formed 20 gauge cold-rolled steel (flat end steel plate standard die-cast aluminum decorative end cap optional)
- Continuous Row:** Full ability to tandem-mount for continuous run application, equipped with male & female quick connect harnesses
- Light Distribution:** 40% Down / 60% Up
- Reflector:** Die-formed, high-reflective
- Lens:** Available in semi-Specular aluminum louver, white louver, white perforated louver & frosted lens
- Electrical:** Constant current, Class 2
- Voltage:** 120-277V (347V and 480V available for canadian projects)
- CRI:** 80+ (90+ available)
- Power Factor:** > .9
- Life:** 60,000 hours L70
- Operating Temperature:** -22°F (-30°C) - 122°F (50°C)
- Emergency Lumens:** System Lumens x Emergency Wattage / System Wattage
- Warranty:** 5 Years Carefree for Parts & Components (Labor Not Included), 10 Year Option Available
- Listings:** UL Listed for Dry & Damp Location



(DEC) Shown with Decorative End Cap

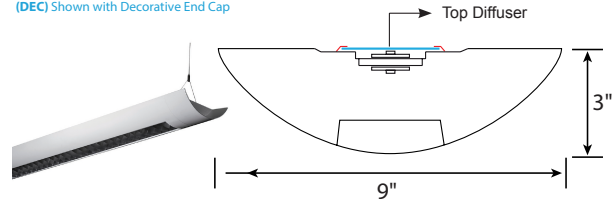

ORDERING INFORMATION Example: (12125-4-60-30K-8-WH-AC4-010-SSA)

Model	Length Wattage Lumens	Color Temp	CRI	Finish	Pendant Mounting	Dimming	Lens Type	Options	Optional Controls
12125	2-30 2FT 30W 2890 lms	27K¹ 2700K	8 Standard 80+ CRI	WH Standard White	AC4 4' Adjustable Aircraft Cable	010 Standard 0-10V 1%	SSA Semi-Specular Aluminum Louver	Blank No Options	Blank No Controls
	2-36 2FT 36W 3426 lms	30K 3000K	9 90+ CRI	BK Black	AC8 8' Adjustable Aircraft Cable	TRI TRIAC (120V)	WL White Louver	EM8 8W Emergency Ballast	LV Lutron
	2-36 2FT 40W 3826 lms	35K 3500K		SL Silver	ACX Specify X in Feet (Max 30')	ELV Electronic Low Voltage	WPL White Perforated Louver	EM15 15W Emergency Ballast	VIVE™ Wireless
	3-45 3FT 45W 4335 lms	40K 4000K		XXXX Specify XXXX: Use RAL # found on Page 2		ES566 eldoLED 0-10V SOLOdrive	FL Frosted Lens	EM20 20W Emergency Ballast	PH Philips EasySense™
	3-54 3FT 54W 5139 lms	50K 5000K				BLS Bi-Level Step 40/100%	OP Semi Specular Louver with White Acrylic Overlay	OS Occupancy Sensor w/ Daylight Harvesting	EN Siemens Enlightened™
	3-60 3FT 60W 5739 lms					BLSXX Bi-Level Step xxx/100%		DS Daylight Dimming Photo Sensor	
	4-32 4FT 32W 3000 lms					TLS Tri-Level Step 30/70/100%		AB Separate Dimming Control of Uplight and Downlight	
	4-60 4FT 60W 5780 lms					TLSXXzzz Tri-Level Step xxxzzz/100%		DEC Decorative End Cap 1.5" Width	
	4-72 4FT 72W 6852 lms							ILD Indirect Light Diffuser for Close to Ceiling Applications	
	4-81 4FT 81W 7652 lms								
	8-120 8FT 120W 11560 lms								
	8-144 8FT 144W 13704 lms								
	8-162 8FT 162W 15304 lms								
	12-180 12FT 180W 17340 lms								
	12-216 12FT 216W 20556 lms								
	12-243 12FT 243W 22956 lms								

¹ Only compatible with 90+ CRI



Alcon 12125 Casablanca Architectural LED Linear Pendant Direct Down Light Fixture

Lens Types

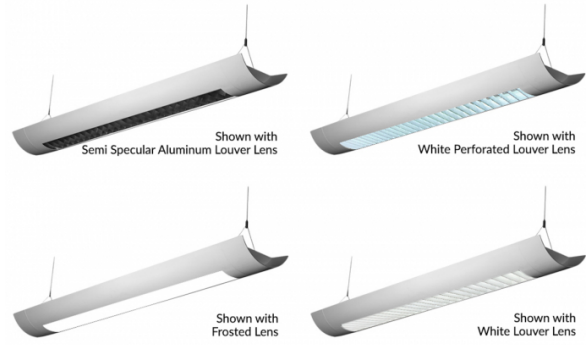

Available Finishes

Standard

	Matte White	RAL #9003
--	-------------	-----------

Set up fee and longer lead time will be applied on non-standard finishes.





Metropolitan

	Black	RAL #9011
	Silver	RAL #9022
	Urban Native	RAL #8025
	Military Green	RAL #6011
	Carmin	RAL #8028
	Chocolate Spice	RAL #8017
	Asher Grey	RAL #7004
	Tech Grey	RAL #7016
	Slate	RAL #7031
	Mason	RAL #7039

Vibrant

	Violet Dreams	RAL #4006
	Sangria Sunset	RAL #2004
	Deep Pink	RAL #4010
	Ruby Red	RAL #3027
	Island Skye	RAL #6027
	Sophia	RAL #5015
	Antique Spring	RAL #6019
	Daisy	RAL #1018
	Gun Metal	RAL #7024

Controls

Smart Sensors	Protocol	Compatible Networks	Occupancy	Daylight	Temperature Reporting	Communication to Luminaire
	Enlighted RF	Enlighted RF	Integrated	Integrated	Yes	Wireless
	EcoSystem	Quantum, Energi Savr Node, Energi TriPak	Enabled	Enabled	No	Wired
	Lutron Clear Connect*	Lutron Vive System Network	Enabled	Enabled	No	Wireless
	ZigBee HA	Philips	Enabled	Enabled	No	Wired

Controls



Controls Installed on the Fixture



FCJS-010
Individual
Fixture Control

Fixture Will be Shipped LUTRON VIVE Enabled with LUTRON FCJS-010 0-10V Control Module Installed on the Fixture. Fixtures will be compatible with Lutron FC-SENSOR Occupancy/Daylight Sensor or FC-VSENSOR Vacancy/Daylight Sensor which can be Added in the Field for Remote Mounting. Fixture May be Controlled with any Vive control systems. Fixtures must be ordered with a 0-10V. Driver.



FCJS-ECO
Individual
Fixture Control

Fixture Will be Shipped LUTRON VIVE Enabled with LUTRON FCJS-ECO EcoSystem Control Module Control Module Installed on the Fixture. Fixtures will be compatible with Lutron FC-SENSOR Occupancy/Daylight Sensor or FC-VSENSOR Vacancy/Daylight Sensor which can be Added in the Field for Remote Mounting. Fixture May be Controlled with any Vive control systems. Fixtures must be ordered with a Lutron Driver.

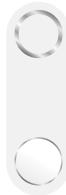

DFCSJ-OEM-OCC

Fixture Will be Shipped LUTRON VIVE Enabled with DFCSJ-OEM-OCC* Vive Integral Fixture Control (with Sensing) Installed on the Fixture. Fixture May be Controlled with any Vive control systems. Fixtures must be ordered with a DMX or Lutron EcoSystem Driver

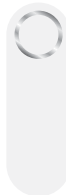

DFCSJ-OEM-RF

Fixture Will be Shipped LUTRON VIVE Enabled with LUTRON DFCSJ-OEM-RF* Vive Integral Fixture Control (RF Only) Installed on the Fixture. Fixture May be Controlled with any Vive control systems. Fixtures must be ordered with a DMX or Lutron EcoSystem Driver.

Controls Provided by Lutron



Vive Wireless Hub



DayLight
Sensor



Ceiling Mount
Occupancy/Daylight
Sensor



Ceiling Mount
Occupancy Sensor



Pico
Remote



Wall Mount
Switch



Wall Mount
Occupancy Sensor



Lutron App



Fixture will be shipped with Leviton ZL027-N0W power control module installed on the fixture. Fixtures will be compatible with Leviton ZL00J-D0W sensor control module which can be added in the field for remote mounting. Fixture must be controlled with Leviton Intellect Keypad Room Controller, or Leviton Neuron App.



ZL027-N0W
Power control module



ZL00J-D0W
Sensor control module

Leviton Keypad



ZLDNK-1W



ZLDNK-2W



ZLDNK-4W



ZLDNK-8W

Intellect™ Keypad Room
Controller (Required)

Leviton App



Neuron App

Controls



Philips EasySense sensors provide luminaire-level control with Occupancy sensing, Daylight harvesting, and Field task tuning.

Controls Installed on the Fixture



PHILIPS-XSR + SNS200

Fixture will be Shipped with EasySense SNS200 Sensor installed and PHILIPS-XSR driver. Fixture May Only be Controlled with Philips Field App or Wireless Switches.



SRB + SNS200

Fixture Will be Shipped with EasySense SNS200 Sensor installed and PHILIPS SRB Bridge. Fixture May Only be Controlled with Philips Field App or Wireless Switches or any 0-10V. Wall Box Dimmer.

Controls Provided by Philips



ZBT-S1AWH



ZBT-S2AWH

Illumra Wireless Switches



PHILIPS-XSR + SNS200-CMP

Fixture will be Shipped Sensor Ready with PHILIPS-XSR driver and EasySense SNS200-CMP Sensor which is Included to be Remote Mounted. Fixture May Only be Controlled with Philips Field App or Wireless Switches

SRB + SNS200-CMP

Fixture Will be Shipped Sensor Ready with PHILIPS SRB Bridge and EasySense SNS200-CMP Sensor which is Included to be Remote Mounted. Fixture May Only be Controlled with Philips Field App or Wireless Switches or any 0-10V. Wall Box Dimmer.



SRB

Fixture will be Shipped Sensor Ready with SRB Bridge. Fixture will be Compatible with EasySense Sensor SNS200-CMP which can be Added in the Field for Remote Mounting. Fixture May Only be Controlled with Philips Field App or Wireless Switches or any 0-10V. Wall Box Dimmer.



Philips Field App

Compatible Dimmers

MFG	Triac	ELV	0-10
	TG-600P LG-600P TGCL-153P DV-600P DVCL-153P S-603PG CT-103P S-600P	DVELV-303P SELV-300P MAELV-600 FAELV-500	NTSTV NFTV DVSTV
		6161 6633-P 6683 6631-2 IPI06-1LZ	IPE04 VPE06-1LZ IP710-DLZ

COLOR TEMPERATURE GUIDE



2700K

WARM
WHITE

friendly
personal
intimate

HOMES
LIBRARIES
RESTAURANTS

3000K
SOFT WHITE
GLOW

soft
warm
pleasing

HOMES
HOTEL ROOMS
LOBBIES
RETAIL STORES

3500K
NEUTRAL
GLOW

sociable
inviting
non-threatening

EXECUTIVE OFFICES
RECEPTION AREAS
SUPERMARKETS

4000K
DAYLIGHT
GLOW

neat
clean
efficient

OFFICES
CLASSROOMS
MASS MERCHANDISERS
SHOWROOMS

5000K
CRYSTAL WHITE
GLOW

bright
cool
alert

GRAPHICS INDUSTRY
HOSPITALS
GALLERIES
BEAUTY SALONS

Pendant Installation

A simple design and adjustable components provide a flexible and hassle-free experience when installing the Continuum Series™.

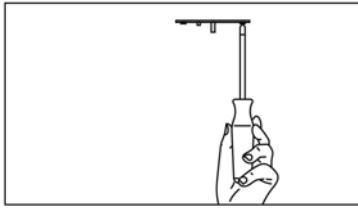

Step 1: Secure cross brackets to junction boxes for both power and non power mounting points.

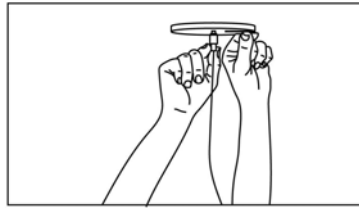

Step 2: Secure canopy with power canopy coupler (Power Feed Mount) & secure canopy with cable terminal (Non Power Feed Mount).

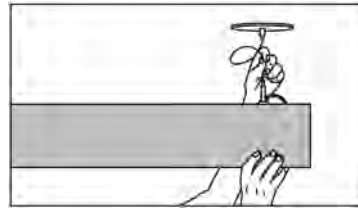

Step 3: Feed aircraft cable into cable grippers, adjust height and level luminaire.



Step 4: Unscrew outer coupler to allow access to junction box. Feed power cord through canopy.



Step 5: Secure canopy back in place with outer coupler.



Step 6: Snap strain relief around power cord. Press into canopy.