



trimless mud-in



trim flange



grid



end detail



corner detail



regress lens



wall to ceiling companion

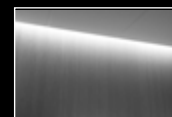

perimeter companion

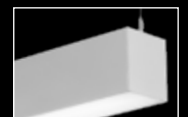

suspended companion

DIMENSIONAL DATA

trimless mud-in

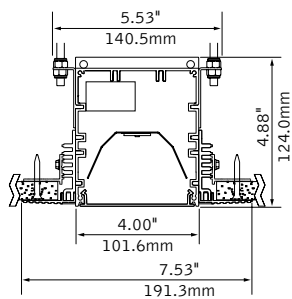

note: 0.375"min - 2.125"max ceiling thickness

hard surface

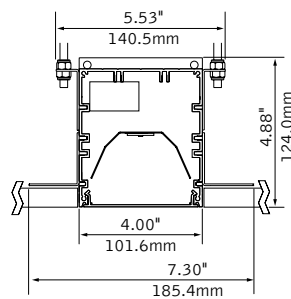

note: 0.375"min - 2.125"max ceiling thickness

trim flange

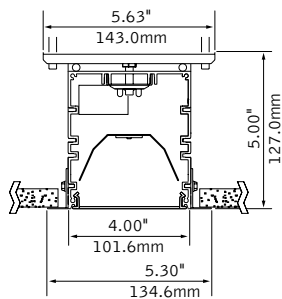

grid - regress lens shown

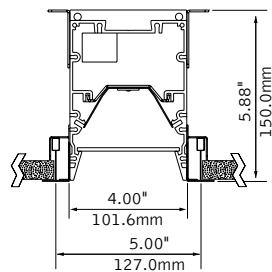

FEATURES

Narrow extruded aluminum 4" aperture recessed slot LED.

Integrates with ceiling or wall in a variety of mounting styles for a clean, unobtrusive aesthetic.

Individual units and continuous runs in 1" increments.

Frosted acrylic lens provides uninterrupted illumination, without pixels or shadows.

LED position and lens material optimized to provide the perfect blend of high performance and visual comfort.

Connected Solutions: Integrates with wired and wireless building lighting control systems.

Preferred Light: Lighting for better color rendition and human preference.

PERFORMANCE

PRODUCT OVERVIEW

Lumen Output:	1500-4000lm
Wattage:	15-46W
LPW:	77-103
SDCM:	3

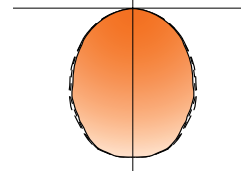

4" Flush Lens
Nominal output:
375 Lumens per foot
Delivered Lumens: 1500lm
Total System Watts: 15W

Photometric performance is measured in accordance with IESNA LM-79.
Visit focalpointlights.com for complete photometric data.

DETAILS

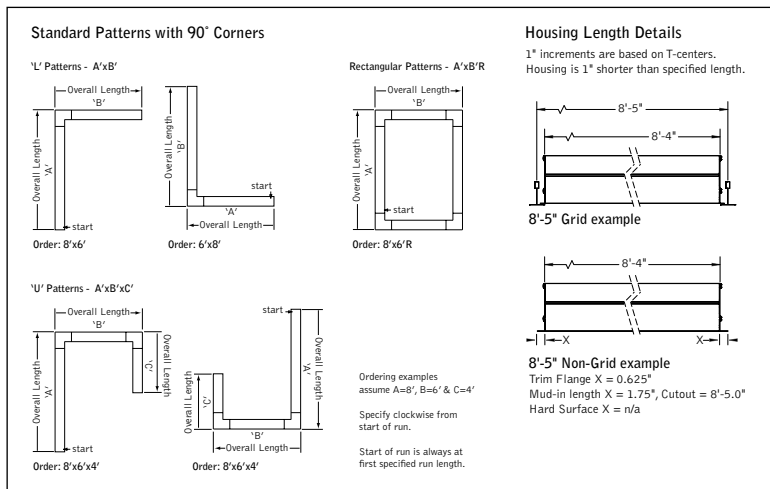

SPECIFICATIONS

LED System

Proprietary linear LED module incorporates premium LEDs on a robust platform to achieve excellent thermal management. LEDs are placed to promote a uniform appearance. Available in 3000K, 3500K or 4000K with CRI>80, 3SDCM. LED modules and drivers are replaceable from below.

Construction

One piece extruded aluminum housing. 20 Ga. steel end caps. Housing for new construction applications. XFW acceptable for use with wood, consult factory for Type IC availability. 2' unit weight: 18 lbs., 3' unit weight: 24 lbs., 4' unit weight: 30 lbs., 5' unit weight: 36 lbs.

Optic

Reflectors fabricated of 22 Ga. steel finished in High Reflectance White powder coat. Extruded acrylic lens .085" thick with satin finish, up to 8' continuous.

Electrical

Luminaires are pre-wired with factory installed branch circuit wiring and over-molded quick connects. Standard 120-277V constant current driver includes 0-10V analog dimming. Dimming range 100% to 10%. Power factor >.9.

Emergency

Output - 10 watts for 90 minutes. Maximum mounting height: 19.2ft. See EM/EC Guide for default locations and ordering details.

Labels

UL and cUL listed. Suitable for Dry or Damp Locations, indoor use only.

Finish

Polyester powder coat applied over a multi-stage pre-treatment.

Lumen Maintenance

Reported: L70 at >61,000 hours Calculated: L70 at 287,000 hours
L90 at >61,000 hours L90 at 74,000 hours
Derived from EPA TM-21 calculator. Based on typical conditions, consult factory for additional data.

Reliability

At Focal Point, our products are designed to stand the test of time. Each luminaire is engineered using superior components, manufactured with the utmost care and rigorously tested. Contact us for reliability data.

Warranty

LED system rated for operation in ambient environments up to 25°C. 5-year limited warranty.

4' PERFORMANCE CHART

Shielding	Lumens per Foot	Delivered Lumens	Tested System Watts	LPW
Flush Lens	375LF	1500	15	97
	625LF	2500	26	95
	875LF	3500	39	89
	1000LF	4000	46	86
Regress Lens	375LF	1500	15	86
	625LF	2500	26	84
	875LF	3500	39	80
	1000LF	4000	46	77
Regress High Performance	375LF	1500	15	103
	625LF	2500	26	100
	875LF	3500	39	95
	1000LF	4000	46	91

Based on 3500K, 4' lengths. *Lumen output may vary +/- 5%. Actual wattage may vary +/- 5%. Preferred Light lumen multiplier = 0.65.

Focal Point LLC reserves the right to change specifications for product improvement without notification.

ORDERING

Luminaire Series

Seem 4 LED **FSM4L**

Shielding

Flush Satin Lens **FL**

Regress Lens **SR**

(Ceiling applications only)

Regress High Performance Lens **SRXP**

(Ceiling applications only)

Lumen Output

275 Lumens per foot **275LF**

(Not available with Lutron Drivers.)

375 Lumens per foot **375LF**

(Not available with LU5 & LH1 Drivers.)

625 Lumens per foot **625LF**

(FL & SR 3' minimum with LU5 & LH1 Drivers. SRXP 4' minimum with LU5 & LH1 Drivers.)

875 Lumens per foot **875LF**

(SR & SRXP 3' minimum with LU5 & LH1 Drivers)

1000 Lumens per foot **1000LF**

Color Temperature

3000K **30K**

3500K **35K**

4000K **40K**

3500K Preferred Light **P35K**

(Flush Lens only. 6" increments. Patterns not available.)

Circuit

Single Circuit **1C**

Voltage

UNV 120/277 Volt **UNV**

Control System & Dimming Level

0-10V - 10% Dimming **LD1**

0-10V - 1% Dimming **L11**

Lutron Hi-Lume EcoSystem (LDE1) - **LH1**

1% Dimming

Lutron 5-Series EcoSystem (LDE5) - **LU5**

5% Dimming

DALI 1% Dimming **D11**

Acuity nLight - 1% Dimming **NLT1**

(3' minimum length. Not available with CP. Grid only.)

Enlighted Smart Sensor - 1% Dimming **ENL1**

(3' minimum length. Grid only)

Osram Connected Lighting Module - **CLM1**

1% Dimming

(3' minimum length. Grid only. Compatible with Daintree Networks & Osram ENCELUM and Simlux systems.)

Wattstopper DLM - 1% Dimming **DLM1**

(3' minimum length. Grid only)

Ceiling Configuration

Std. 15/16" Lay-in **G1**

Std. 15/16" Tegular **T1**

Std. 9/16" Lay-in **G2**

Std. 9/16" Tegular **T2**

9/16" Slot-tee Tegular **G3**

Tall 15/16" Lay-in **G4**

Tall 15/16" Tegular **T4**

Tall 9/16" Lay-in **G5**

Tall 9/16" Tegular **T5**

Node 9/16" Tegular **T6**

Trim Flange Drywall **TF**

(3' minimum with Lutron Drivers)

Trim Flange Wood **TFW**

(3' minimum with Lutron Drivers)

Mud-in Trimless, pre-set for 1/2" Drywall **XF1**

Mud-in Trimless, pre-set for 5/8" Drywall **XF2**

Mud-in Trimless, set thickness in field **XFF**

(Mounting equipment assembled in field)

Non-Drywall Hard Surface **XFN**

Hard Surface, Wood **XFW**

Factory Options

Chicago Plenum **CP**

Emergency Circuit **_EC**

(4' minimum. 7' minimum with CLM1, DLM1, ENL1 & NLT1.)

Emergency Battery Pack **_EM**

(4' minimum. 7' minimum with CLM1, DLM1, ENL1 & NLT1. Not available at corners. See EM/EC Guide for default locations and ordering details.)

6' New York City Flex Whip (120V) **FN1**

6' New York City Flex Whip (277V) **FN2**

6' Flex Whip **FW**

Finish

Matte White Housing **WH**

Luminaire Length **_ft_in**

Specify luminaire/row length in 1" increments

(2' minimum. Lengths are nominal 1" increments based on T-centers. Housing length is 1" shorter than specified. Leave blank for patterns. Smaller increments available, consult factory.)

Pattern Options

(3' minimum length)

'L' pattern **A' x B'**

'U' pattern **A' x B' x C'**

Rectangular pattern **A' x B'R**

(Consult factory for other pattern options)



Options in orange qualify for the Quickship program. 4', 8' and run length in 4' increments. 400' total. Refer to Quickship Guide for complete details including EM/EC options.

Focal Point provides flexibility in meeting the needs of each project by integrating with several building lighting control systems. A variety of sensors, drivers and other components can be specified that allow the luminaires to communicate with wired and wireless networks. All zoning can be digitally reconfigured through the application software. Daylight harvesting, occupancy sensing, integration with HVAC systems, and individual controls enable the monitoring and modulating of light levels and temperature in order to save energy, reduce costs and maximize occupants' comfort.

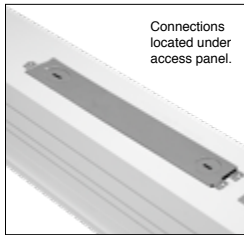

nLight® provides a two-way wired digital lighting system allowing for on/off and dimming functionality, occupancy sensing, and multi-zone daylight harvesting.

Acuity nLight - 1% Dimming (NLT1)
Acuity Model #nEPS-60-IO

CAT-5 Cable provided by others. Serial labels will be provided on outside of luminaires and control unit.

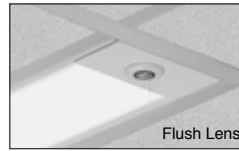
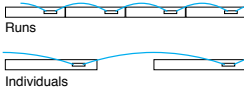

Enlighted smart sensor allows for occupancy sensing, daylight harvesting, energy usage, temperature and light level control. Communicates wirelessly with the Enlighted network.

Enlighted Smart Sensor - 1% Dimming (ENL1)
Enlighted Model #SU-4E-01

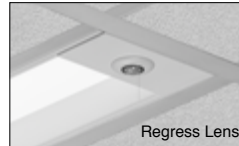

Connected Lighting Module (CLM) enables each luminaire to be independently controlled and configured. Communicates wirelessly with Daintree Networks®, Osram ENCELIUM®, Osram Simplux™ and other networks using the ZigBee® HA communication protocol to allow for on/off and dimming functionality, occupancy sensing and multi-zone daylight harvesting.

Osram CLM - 1% Dimming (CLM1)
Osram Model #ZBHA-CLM DIM

Serial labels will be provided on outside of luminaires and control unit.

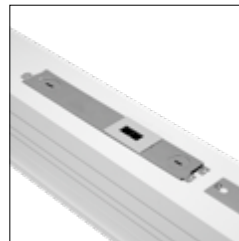

A Digital Lighting Management (DLM) system that provides two-way wired communication between networked luminaires and control system to allow for on/off and dimming functionality, occupancy sensing and multi-zone daylight harvesting.

Wattstopper DLM - 1% Dimming (DLM1)
Wattstopper Model #LMFC-011

CAT-5 Cable provided by others. Serial labels will be provided on outside of luminaires and control unit.

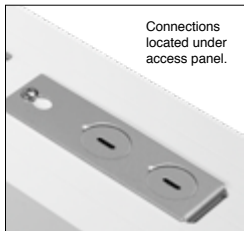
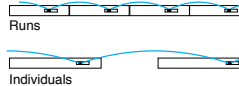

A two-way digital network that enables on/off and dimming functionality, occupancy sensing, and multi-zone daylight harvesting working with Quantum®, Energi Savr Node™, and Energi TriPak® using EcoSystem® communication protocol.

Lutron Hi-Lume EcoSystem - 1% Dimming (LH1)
Lutron Model #LDE1

Lutron 5-Series EcoSystem - 5% Dimming (LU5)
Lutron Model #LDE5

CONNECTED SOLUTIONS DETAILS

Connected Solution	Model #	Protocol	Compatible Networks*	Occupancy	Daylight	Temperature Reporting	Communication to Luminaire	Drivers
Acuity nLight (NLT1)	nEPS-60-IO**	nLight	nLight	Enabled	Enabled	No	Wired	eldoLED ECOdrive , eldoLED SOLOdrive
Enlighted Smart Sensor (ENL1)	SU-4E-01**	Enlighted RF	Enlighted	Integrated	Integrated	Yes	Wireless	Philips SimpleSet , Osram Optotronic
Legrand Wattstopper DLM (DLM1)	LMFC-011**	DLM	DLM	Enabled	Enabled	No	Wired	Philips SimpleSet , Osram Optotronic
Lutron EcoSystem (LH1 & LU5)	LDE1,** LDE5**	EcoSystem	Quantum, Energi Savr Node, Energi TriPak	Enabled	Enabled	No	Wired	Lutron Hi-Lume Lutron 5-Series
Osram CLM (CLM1)	ZBHA-CLM**	ZigBee HA	Osram ENCELIUM & Simplux, Daintree Networks	Enabled	Enabled	No	Wireless	Osram Optotronic

*Not all compatible networks may be listed. **For performance data and additional control system details please visit the connected solutions manufacturer websites. Primary drivers are listed in **bold**. To specify a particular driver please consult factory.

Seem® EM/EC Guide

FSM2L-FL, FSM2L-FL2, FSM2LS, FSM4L-FL/SR/SRXP, FSM4L-FL2, FSM4LS, FSM4LP, FSM6L-FL/SR/SRXP*



DEFAULT LOCATIONS

- By default, EM/EC are located at the end (last section) of a run when one EM/EC location is specified, and at the start and end when two locations are specified.
- EM/EC illuminate entire sections from 4' to 8' in length.
- Feed location is at start of run. All EC's are fed individually at the end of each fixture segment.

1 EM/EC – END OF RUN

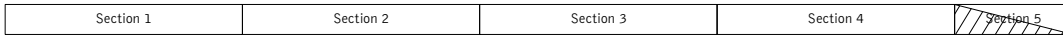

Ordering example: FSM4L-FL... **1EM-WH-36ft**

2 EM/EC – START & END OF RUN



Ordering example: FSM4L-FL... **2EM-WH-36ft**

ALTERNATE LOCATIONS AND QUANTITIES

- If more than two locations are required, or specific locations within run need to be specified, indicate in the ordering string.

ONE EM IN 3RD SECTION

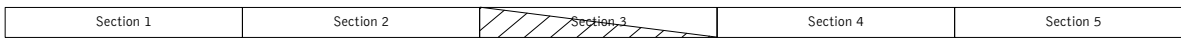

Ordering example: FSM4L-FL... **1EM-3-WH-40ft**

THREE EM IN 1ST, 3RD AND 6TH SECTIONS



Ordering example: FSM4L-FL... **3EM-1-3-6-WH-48ft**

CUSTOM LENGTHS

- If partial illumination of emergency section is required, indicate quantity in ordering string and partial illumination in Order Notes. Drawing required.
- Longer lead times may apply.

Run length (ft)	Housing Configuration Section Lengths
9	5 + 4
10	6 + 4
11	7 + 4
12	8 + 4
13	8 + 5
14	8 + 6
15	8 + 7
16	8 + 8
17	8 + 5 + 4
18	8 + 6 + 4
19	8 + 7 + 4
20	8 + 8 + 4
21	8 + 8 + 5
22	8 + 8 + 6
23	8 + 8 + 7
24	8 + 8 + 8
25	8 + 8 + 5 + 4
26	8 + 8 + 6 + 4
27	8 + 8 + 7 + 4

Run length (ft)	Housing Configuration Section Lengths
28	8 + 8 + 8 + 4
29	8 + 8 + 8 + 5
30	8 + 8 + 8 + 6
31	8 + 8 + 8 + 7
32	8 + 8 + 8 + 8
33	8 + 8 + 8 + 5 + 4
34	8 + 8 + 8 + 6 + 4
35	8 + 8 + 8 + 7 + 4
36	8 + 8 + 8 + 8 + 4
37	8 + 8 + 8 + 8 + 5
38	8 + 8 + 8 + 8 + 6
39	8 + 8 + 8 + 8 + 7
40	8 + 8 + 8 + 8 + 8
41	8 + 8 + 8 + 8 + 5 + 4
42	8 + 8 + 8 + 8 + 6 + 4
43	8 + 8 + 8 + 8 + 7 + 4
44	8 + 8 + 8 + 8 + 8 + 4
45	8 + 8 + 8 + 8 + 8 + 5
46	8 + 8 + 8 + 8 + 8 + 6
47	8 + 8 + 8 + 8 + 8 + 7
48	8 + 8 + 8 + 8 + 8 + 8

Standard run configurations, consult factory for custom configurations.

*Recessed and suspended only. Does not include direct/indirect, pop-down lens or asymmetric options.

Seem® 4

LED - FLUSH LENS

FSM4L-FL-375LF-35K-1C-UNV-LD1-G1-CP-WH-4'

Filename: FSM4LFL375LF35K.IES
Test #: 11499493.01

Lumens: 1423lm
System Watts: 15W
LPW: 95

CANDLEPOWER DISTRIBUTION

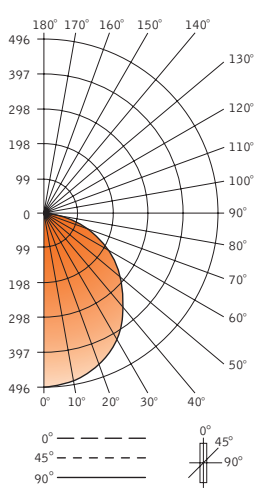

Vertical Angle	Horizontal Angle				
	0°	22.5°	45°	67.5°	90°
0°	496	496	496	496	496
5°	493	496	493	493	494
15°	475	479	475	476	477
25°	439	443	439	440	440
35°	386	390	387	387	388
45°	322	325	322	323	324
55°	253	255	253	254	254
65°	176	179	178	179	180
75°	100	102	102	104	104
85°	31	32	31	31	31
90°	0	2	2	2	2
95°	0	0	0	0	0
105°	0	0	0	0	0
115°	0	0	0	0	0
125°	0	0	0	0	0
135°	0	0	0	0	0
145°	0	0	0	0	0
155°	0	0	0	0	0
165°	0	0	0	0	0
175°	0	0	0	0	0
180°	0	0	0	0	0

LUMEN SUMMARY

Zone	Lumens	% Fixture
0-30°	384	27.0
0-40°	627	44.1
0-60°	1103	77.5
0-90°	1423	100.00
Total Luminaire 0-180°	1423	100.0

LUMINANCE DATA (CD/M²)

Vertical Angle	Horizontal		
	0°	45°	90°
45°	3757	3760	3774
55°	3634	3642	3657
65°	3441	3473	3506
75°	3193	3261	3313
85°	2923	2967	2970

Go to www.focalpointlights.com for additional photometric data.

Seem® 4

LED - REGRESS LENS

FSM4L-SR-375LF-35K-LD1-1C-120-G1-WH

Filename: FSM4LSR375LF35K.IES
Test #: 17847.0

Lumens: 1333lm
System Watts: 15W
LPW: 89

CANDLEPOWER DISTRIBUTION

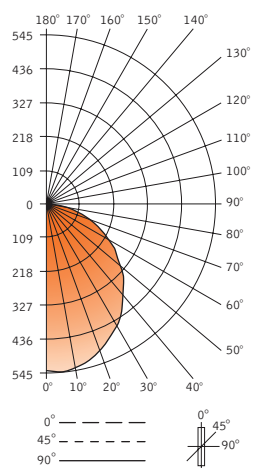

Vertical Angle	Horizontal Angle					Zonal Lumens
	0°	22.5°	45°	67.5°	90°	
0°	540	540	540	540	540	
5°	545	545	544	545	545	52
15°	520	519	519	519	519	146
25°	469	467	465	465	463	216
35°	418	418	413	402	396	254
45°	343	339	322	305	300	248
55°	261	254	228	209	202	207
65°	178	163	136	119	111	140
75°	88	72	49	34	30	60
85°	22	6	6	6	6	11
90°	0	0	0	0	0	0
95°	0	0	0	0	0	0
105°	0	0	0	0	0	0
115°	0	0	0	0	0	0
125°	0	0	0	0	0	0
135°	0	0	0	0	0	0
145°	0	0	0	0	0	0
155°	0	0	0	0	0	0
165°	0	0	0	0	0	0
175°	0	0	0	0	0	0
180°	0	0	0	0	0	0

LUMEN SUMMARY

Zone	Lumens	% Fixture
0-30°	414	31.0
0-40°	668	50.1
0-60°	1122	84.2
0-90°	1333	100.0
Total Luminaire 0-180°	1333	100.0

LUMINANCE DATA (CD/M²)

Vertical Angle	Horizontal		
	0°	45°	90°
45°	4723	4439	4130
55°	4436	3872	3430
65°	4096	3145	2565
75°	3310	1858	1115
85°	2407	702	702

Go to www.focalpointlights.com for additional photometric data.

Seem® 4

LED - REGRESS HIGH PERFORMANCE LENS

FSM4L-SRXP-375LF-35K-LD1-1C-120-G1-WH

Filename: FSM4LSRXP375LF35K.IES
Test #: 17852.0

Lumens: 1587lm
System Watts: 15W
LPW: 106

CANDLEPOWER DISTRIBUTION

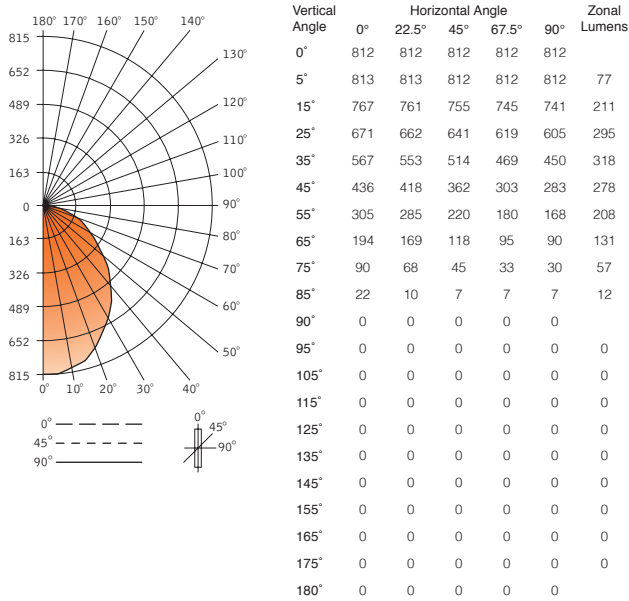

LUMEN SUMMARY

Zone	Lumens	% Fixture
0-30°	583	36.8
0-40°	901	56.8
0-60°	1386	87.4
0-90°	1587	100.0
Total Luminaire 0-180°	1587	100.0

LUMINANCE DATA (CD/M²)

Vertical Angle	Horizontal		
	0°	45°	90°
45°	6005	4980	3896
55°	5183	3738	2853
65°	4460	2720	2083
75°	3401	1681	1120
85°	2496	832	832

Go to www.focalpointlights.com for additional photometric data.